

P-10123

S2567

35052

BETTER FINISH REQUIRED (OUTER SURFACE)

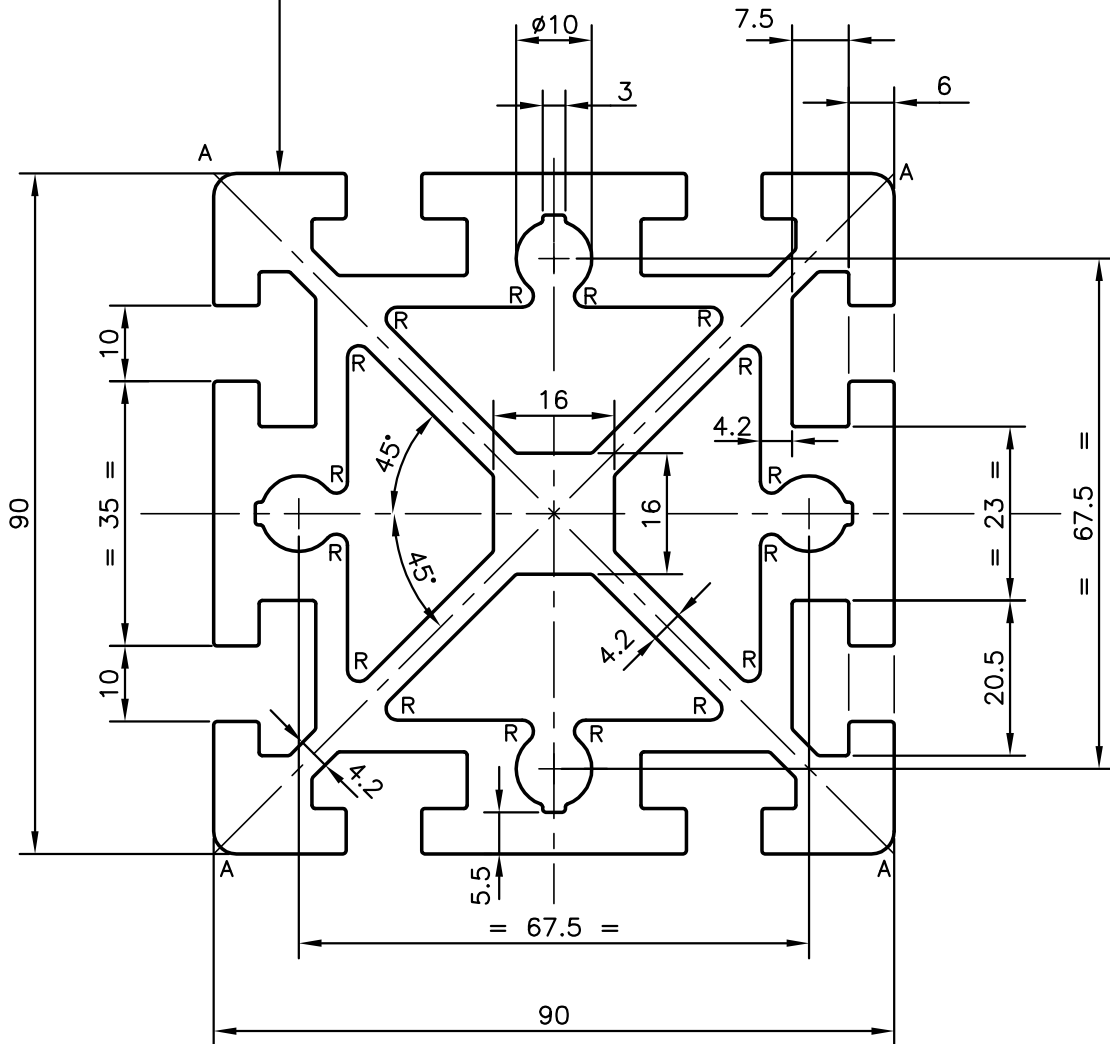

A = 3.0 RADII (4)
R = 1.5 RADII (16)



SYMBOL OF QUALITY
AN ISO 9001 COMPANY

JINDAL ALUMINIUM LTD.
BANGALORE-560073 (INDIA)

	NAME	DATE
DRAWN	J.P.KAUSHIK	23-06-2010
CHECKED		
APPROVED	S.S.GARG	28-06-2010
SCALE		1:1
AREA mm ²		3820.436
PERIMETER mm.		712.699
WEIGHT kg/m		10.315
DRAWING No.	SECTION No.	
P-10123	-	
S2567	S2567	
35052	35052	

1. ALL DIMENSIONS ARE IN mm.
2. ROUND OFF ALL SHARP CORNERS WITH 0.40 mm.
3. TOLERANCES WILL BE AS PER BS EN 12020-2 UNLESS OTHERWISE SPECIFIED

PARTY'S NAME	TECHCELLENCY, PUNE
PARTY'S DRAWING No.	AS PER DRAWING
ALLOY & TEMPER	HE9 WP
DESCRIPTION	DISPLAY SECTION