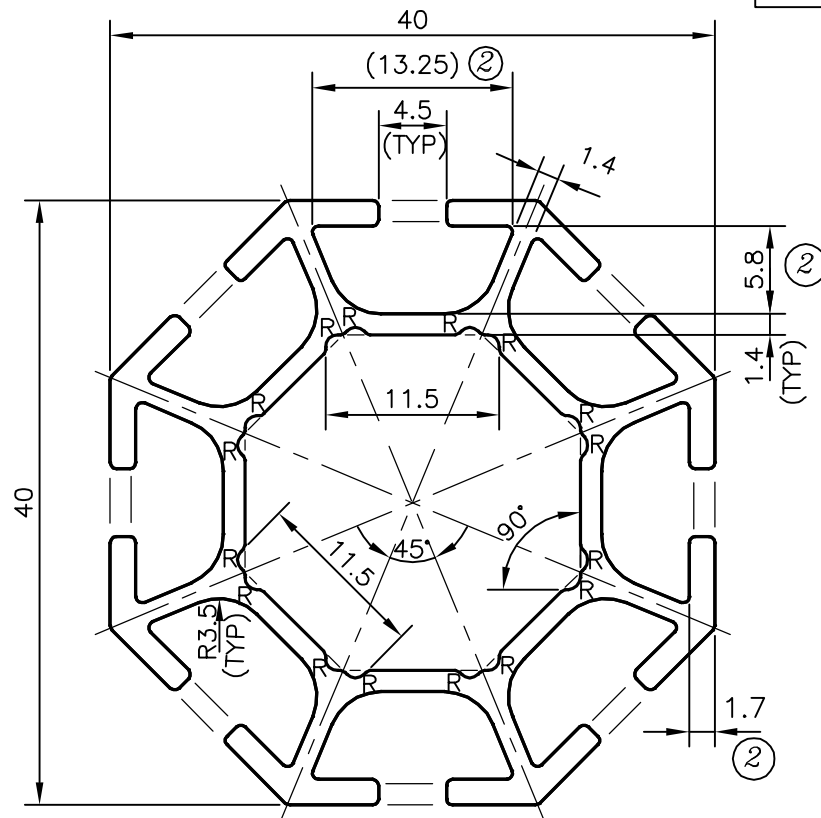
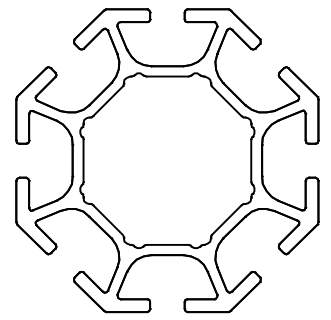

P-13052

35069

**ISSUE-2**

- ☞ THICKNESS CHANGED FROM 1.4 TO 1.7 mm.
- ☞ DIMENSION CHANGED FROM 6.1 TO 5.8 mm.
- ☞ DIMENSION CHANGED FROM 13.5 TO 13.25 mm.
- ☞ WEIGHT ALSO CHANGED FROM 0.862 TO 0.922 kg/m.

R = 0.80 mm RADIUS (16 PLACES)

TOLERANCES ON OVERALL WIDTHS & WIDTHS ACROSS FLATS OF BARS, & REGULAR SECTIONS

UPTO 6.40mm - ±0.20	UPTO 32.0mm - ±0.38	UPTO 120.0mm - ±0.85	1. STRAIGHTNESS=1.7mm/M 2. TWIST=1.7mm/M 3. ANGULARITY= ±2° 4. FLATNESS =0.3mm
UPTO 10.0mm - ±0.23	UPTO 50.0mm - ±0.46	UPTO 160.0mm - ±1.02	
UPTO 12.0mm - ±0.25	UPTO 60.0mm - ±0.53	UPTO 200.0mm - ±1.14	
UPTO 16.0mm - ±0.28	UPTO 80.0mm - ±0.69	UPTO 250.0mm - ±1.40	
UPTO 25.0mm - ±0.30	UPTO 100.0mm - ±0.75	UPTO 320.0mm - ±1.70	



SYMBOL OF QUALITY
AN ISO 9001 COMPANY

JINDAL ALUMINIUM LTD.
BANGALORE-560073 (INDIA)

	NAME	DATE
DRAWN	PARVESH	23-02-2015
CHECKED		
APPROVED	S.S.GARG	26-02-2015

- ALL DIMENSIONS ARE IN mm.
- ROUND OFF ALL SHARP CORNERS WITH 0.40 mm.
- TOLERANCES WILL BE AS PER IS:6477-1983, UNLESS OTHERWISE SPECIFIED

SCALE	2:1
AREA mm ²	341.548
PERIMETER mm.	346.989
WEIGHT kg/m	0.922

PARTY'S NAME	GENERAL CATEGORY, DELHI MARKET	DRAWING No.	P-13052	SECTION No.	-
PARTY'S DRAWING No.	LIGHTER OF SECTION NO. 20368		35069		35069-ISSUE-2
ALLOY & TEMPER	HE9 WP				
DESCRIPTION	DISPLAY SECTION				