

P-16999

35116

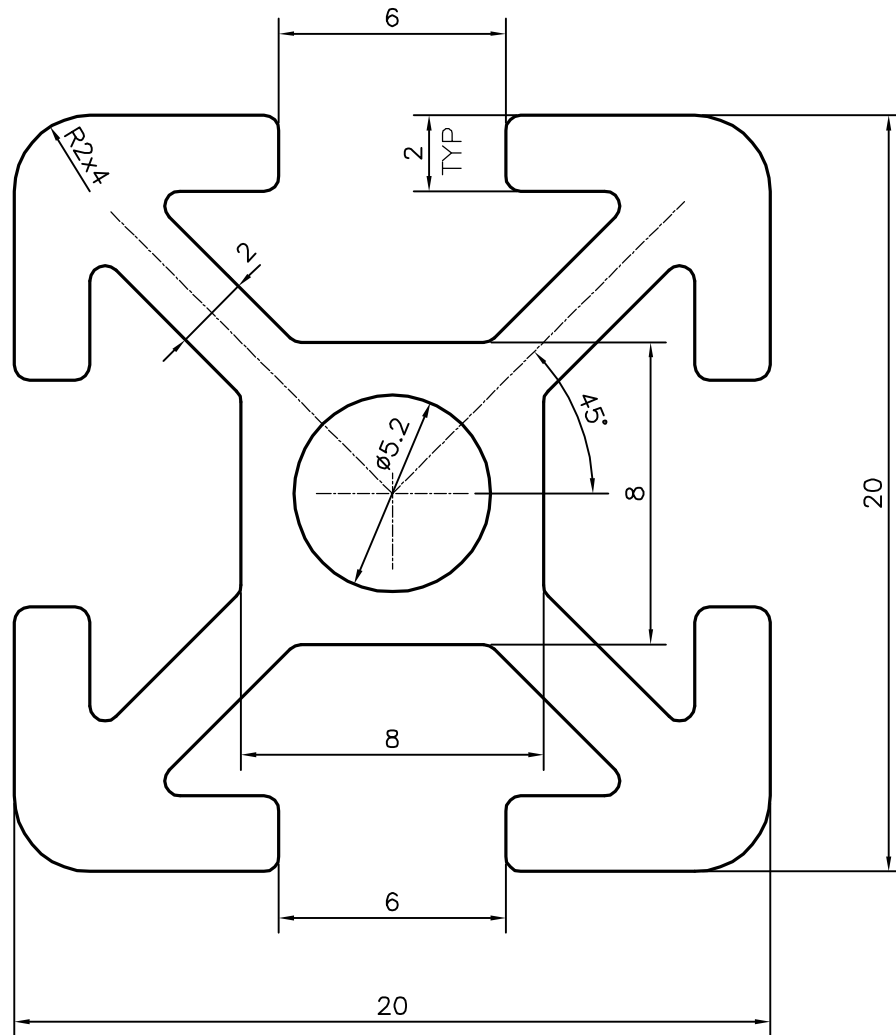
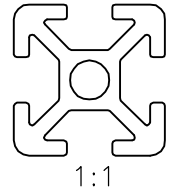

TOLERANCES ON OVERALL DIMENSIONS OF HOLLOW SECTIONS

UPTO 20.0mm - ± 0.30	UPTO 80.0mm - ± 0.70	UPTO 180.0mm - ± 1.27	1. STRAIGHTNESS=1.7mm/M 2. TWIST=1.7mm/M 3. ANGULARITY= $\pm 2^\circ$ 4. FLATNESS =0.006xWIDTH
UPTO 30.0mm - ± 0.38	UPTO 100.0mm - ± 0.80	UPTO 200.0mm - ± 1.40	
UPTO 40.0mm - ± 0.45	UPTO 120.0mm - ± 0.90	UPTO 225.0mm - ± 1.52	
UPTO 50.0mm - ± 0.52	UPTO 140.0mm - ± 1.00		
UPTO 60.0mm - ± 0.60	UPTO 160.0mm - ± 1.14		

<p>SYMBOL OF QUALITY AN ISO 9001 COMPANY</p>	<p>JINDAL ALUMINIUM LTD. BANGALORE-560073 (INDIA)</p>	NAME	DATE
		DRAWN	J.P.KAUSHIK
		CHECKED	
		APPROVED	B.NATARAJA
		SCALE	5:1
		AREA mm ²	181.644
		PERIMETER mm.	152.398
		WEIGHT kg/m	0.490
PARTY'S NAME	GENERAL CATEGORY, BANGALORE MARKET	DRAWING No.	SECTION No.
PARTY'S DRAWING No.	AS PER SAMPLE	P-16999	-
ALLOY & TEMPER	HE9 WP	35116	35116
DESCRIPTION	DISPLAY SECTION		

1. ALL DIMENSIONS ARE IN mm.
2. ROUND OFF ALL SHARP CORNERS WITH 0.40 mm.
3. TOLERANCES WILL BE AS PER IS:6477-1983 , UNLESS OTHERWISE SPECIFIED