

(2)
ISSUE-2 DIMENSION CHANGED FROM 189.00mm TO 192.00mm & DIMENSION 32.00mm ADDED FOR CUSTOMER REFERENCE. & WEIGHT ALSO CHANGED FROM 4.098kg/M TO 4.118kg/M

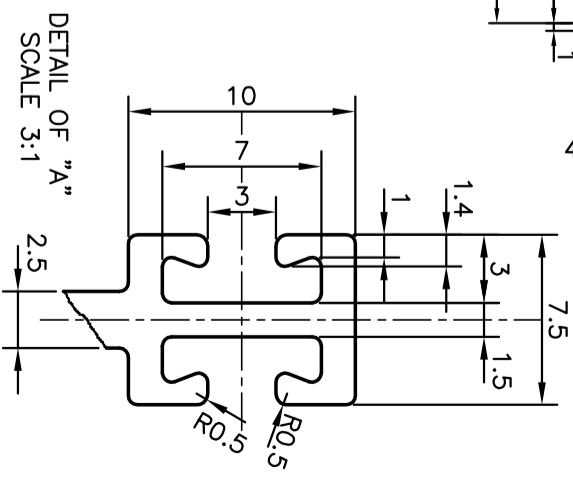

F = FULL RADIUS (16 PLACES)

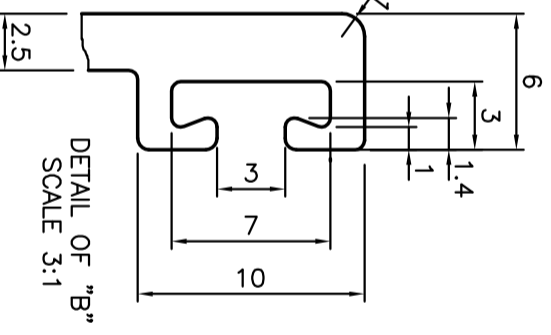
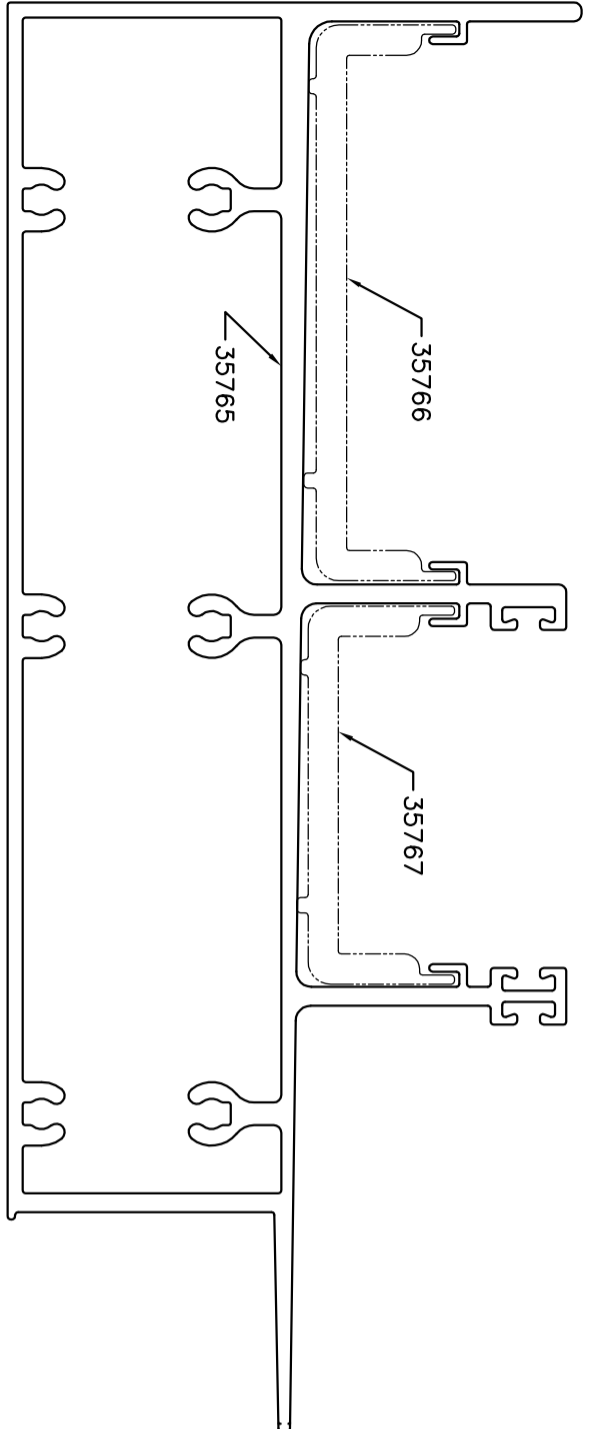

<p>SYMBOL OF QUALITY AN ISO 9001 COMPANY</p>		<p>JINDAL ALUMINIUM LTD. BANGALORE-560073 (INDIA)</p>	
<p>1. ALL DIMENSIONS ARE IN mm. 2. ROUND OFF ALL SHARP CORNERS WITH 0.40 mm. 3. TOLERANCES WILL BE AS PER BS:EN-12020-2 UNLESS OTHERWISE SPECIFIED</p>		<p>NAME DATE DRAWN J.P.KAUSHIK 22-10-2010 CHECKED APPROVED</p>	
<p>PARTY'S NAME GWS ENGINEERS & FABRICATORS PVT.LTD.,MUMBAI</p>		<p>SCALE 1:1 AREA mm² 1525.18 PERIMETER mm. 776.269 WEIGHT kg/m 4.118 DRAWING No. SECTION No.</p>	
<p>PARTY'S DRAWING No. GWS-CAPT-A3-03</p>		<p>P-10196-2</p>	
<p>ALLOY & TEMPER HE9 WP</p>		<p>S2620 S2620-ISSUE-2 35765 35765</p>	
<p>DESCRIPTION CURTAIN WALL (GUTTER SECTION)</p>			