

P-13651-1  
S4169  
35934

100% MANUAL CORRECTION REQUIRED.

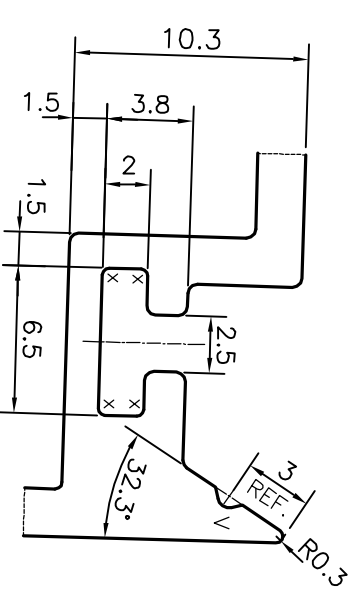

DETAIL OF "A"  
SCALE 3:1

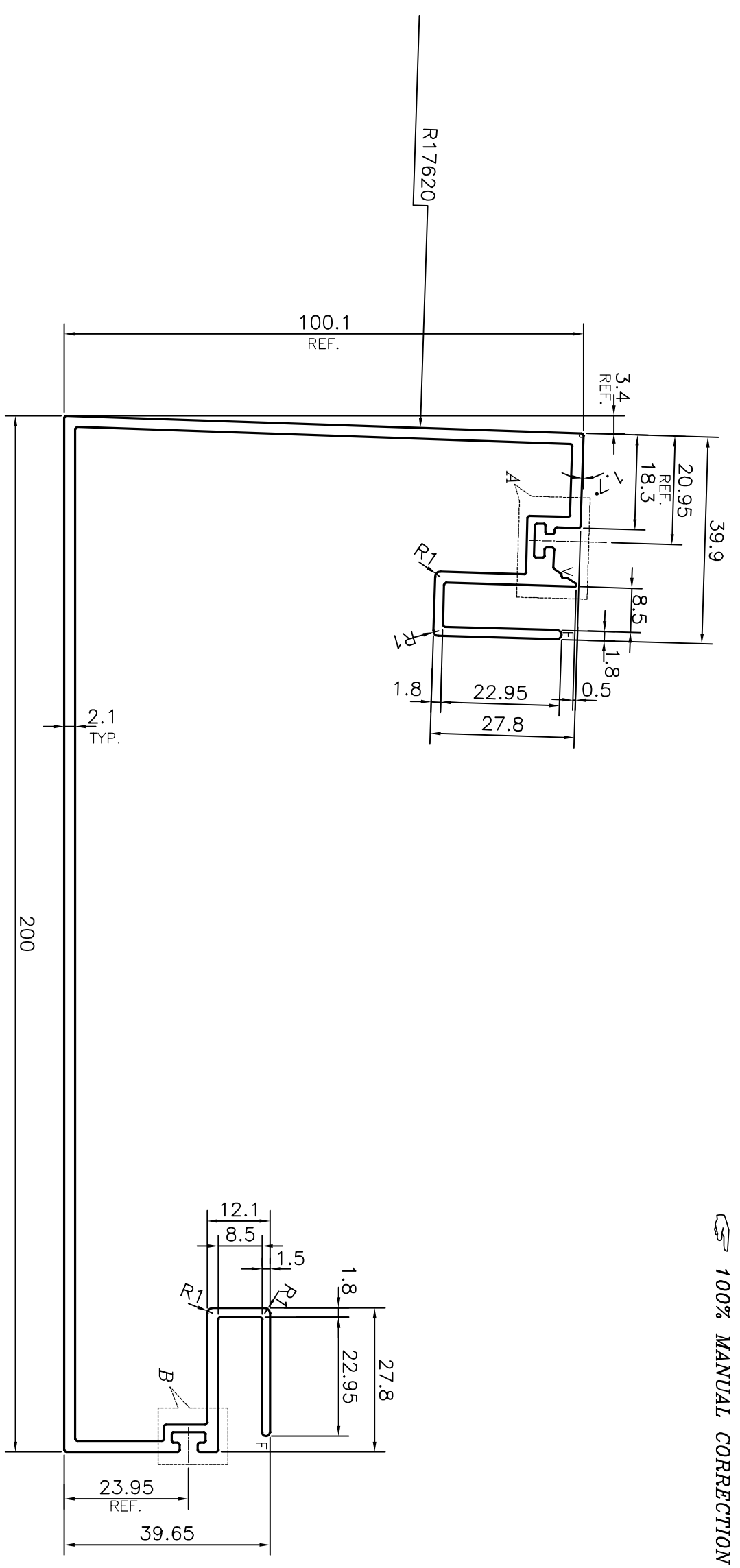
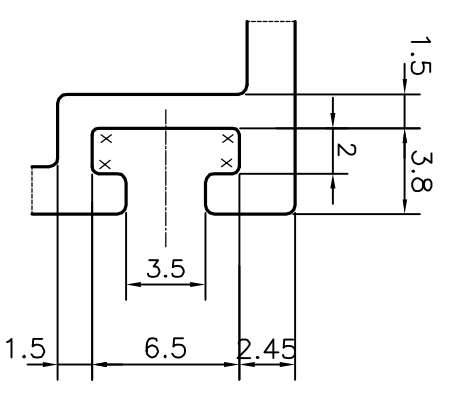

DETAIL OF "B"  
SCALE 3:1

X = RADIUS 0.3 mm (8 PLACES)  
F = FULL RADIUS (2 PLACES)  
V = VEE GROOVE 0.5x90° (1 PLACE)

TOLERANCES ON OVERALL WIDTHS & WIDTHS ACROSS FLATS OF BARS, & REGULAR SECTIONS

UPTO 6.40mm	- ±0.20	UPTO 32.0mm	- ±0.38	UPTO 120.0mm	- ±0.85
UPTO 10.0mm	- ±0.23	UPTO 50.0mm	- ±0.46	UPTO 160.0mm	- ±1.02
UPTO 12.0mm	- ±0.25	UPTO 60.0mm	- ±0.53	UPTO 200.0mm	- ±1.14
UPTO 16.0mm	- ±0.28	UPTO 80.0mm	- ±0.69	UPTO 250.0mm	- ±1.40
UPTO 25.0mm	- ±0.30	UPTO 100.0mm	- ±0.75	UPTO 300.0mm	- ±1.65

**JINDAL**  
SYMBOL OF QUALITY  
AN ISO 9001 COMPANY  
**JINDAL ALUMINIUM LTD.**  
BANGALORE-560073 (INDIA)

1. ALL DIMENSIONS ARE IN mm.
2. ROUND OFF ALL SHARP CORNERS WITH 0.40 mm.
3. TOLERANCES WILL BE AS PER IS:3965-1981, UNLESS OTHERWISE SPECIFIED

PARTY'S NAME	ALUMAYER INDIA PVT. LTD., MUMBAI	SCALE	1:1
PARTY'S DRAWING No.	AS PER AUTOCAD DRAWING-CR-42 R1	AREA mm <sup>2</sup>	994.353
ALLOY & TEMPER	6063 T6	PERIMETER mm.	973.101
DESCRIPTION	CURTAIN WALL SECTION	WEIGHT kg/m	2.685
		DRAWING No.	SECTION No.
		P-13651-1	-
		S4169	S4169
		35934	35934

DRAWN NAME: PAREESH DATE: 24-06-2014  
CHECKED: S.S.GARG  
APPROVED: S.S.GARG

1. STRAIGHTNESS=1.7mm/M  
2. TWIST=1.7mm/M  
3. ANGULARITY= ±2°  
4. FLATNESS =0.007xWIDTH