

P-17292

X2227

36152

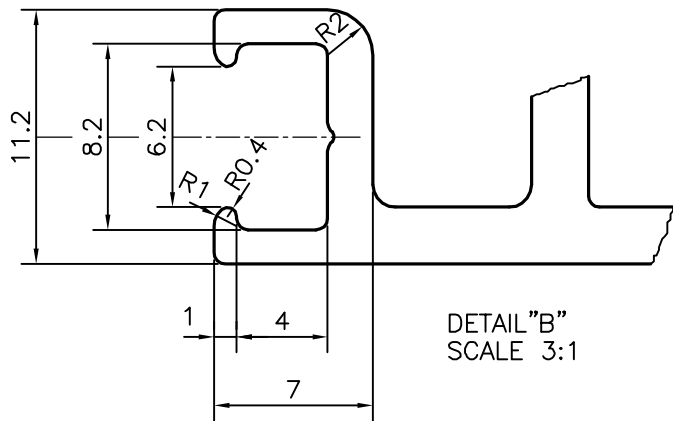
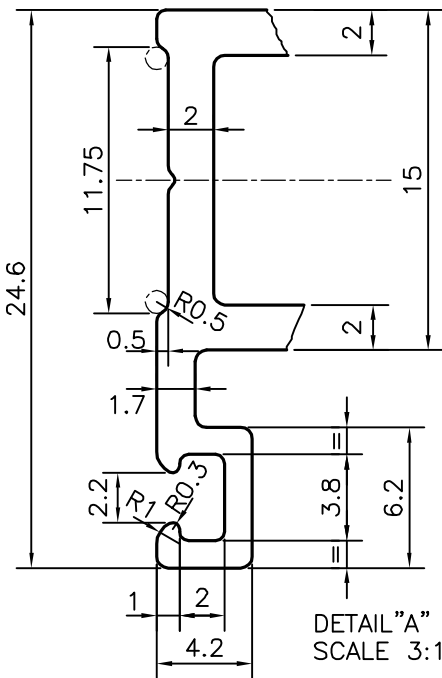
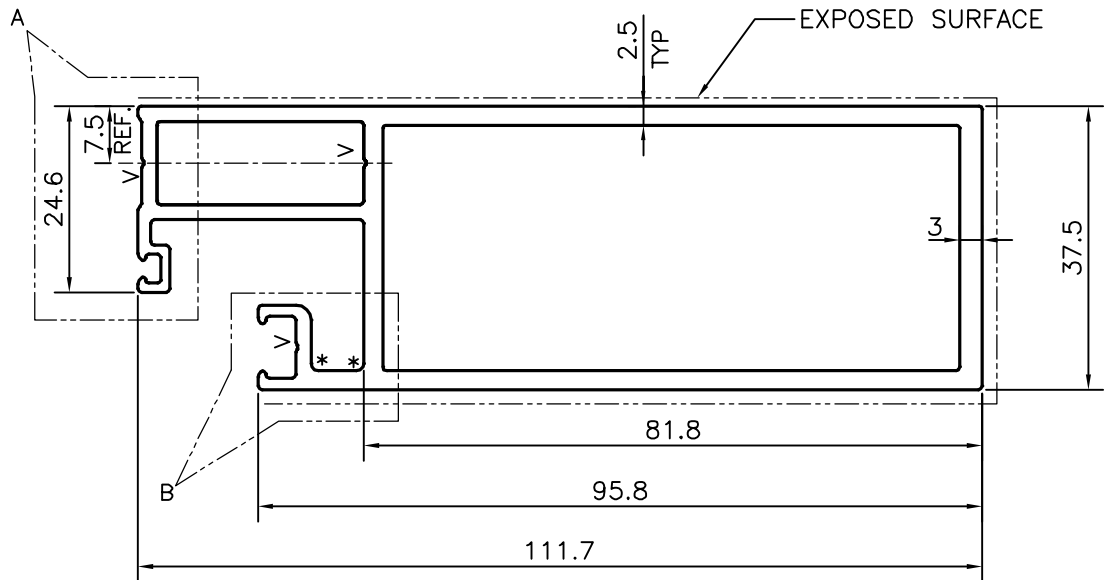

\* = 1.0 RADIUS (2 PLACES)  
 V = V GROOVE 0.3x90° (3 PLACES)

TOLERANCES ON OVERALL DIMENSIONS OF HOLLOW SECTIONS

UPTO 20.0mm - ±0.30	UPTO 80.0mm - ±0.70	UPTO 180.0mm - ±1.27	1. STRAIGHTNESS=1.7mm/M 2. TWIST=1.7mm/M 3. ANGULARITY= ±2° 4. FLATNESS =0.006xWIDTH
UPTO 30.0mm - ±0.38	UPTO 100.0mm - ±0.80	UPTO 200.0mm - ±1.40	
UPTO 40.0mm - ±0.45	UPTO 120.0mm - ±0.90	UPTO 225.0mm - ±1.52	
UPTO 50.0mm - ±0.52	UPTO 140.0mm - ±1.00		
UPTO 60.0mm - ±0.60	UPTO 160.0mm - ±1.14		



SYMBOL OF QUALITY  
 AN ISO 9001 COMPANY

**JINDAL ALUMINIUM LTD.**  
 BANGALORE-560073 (INDIA)

	NAME	DATE
DRAWN	J.P.KAUSHIK	22-06-2017
CHECKED		
APPROVED	B.NATARAJA	31-07-2017
SCALE		1:1
AREA mm <sup>2</sup>		806.863
PERIMETER mm.		384.412
WEIGHT kg/m		2.179
DRAWING No.	SECTION No.	
P-17292	-	
X2227	X2227	
36152	36152	

1. ALL DIMENSIONS ARE IN mm. 2. ROUND OFF ALL SHARP CORNERS WITH 0.40 mm. 3. TOLERANCES WILL BE AS PER IS:6477-1983 , UNLESS OTHERWISE SPECIFIED	
PARTY'S NAME	TEAM WORK GLASS SOLUTION PVT. LTD., BANGALORE
PARTY'S DRAWING No.	AS PER DRAWING-TWS 2017 012
ALLOY & TEMPER	6063 T6
DESCRIPTION	MULLION SECTION