

IAL-D-3524

PRODUCED BY AN AUTODESK EDUCATIONAL PRODUCT

36412

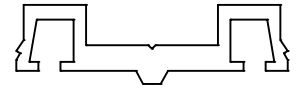

SCALE:- 1:1

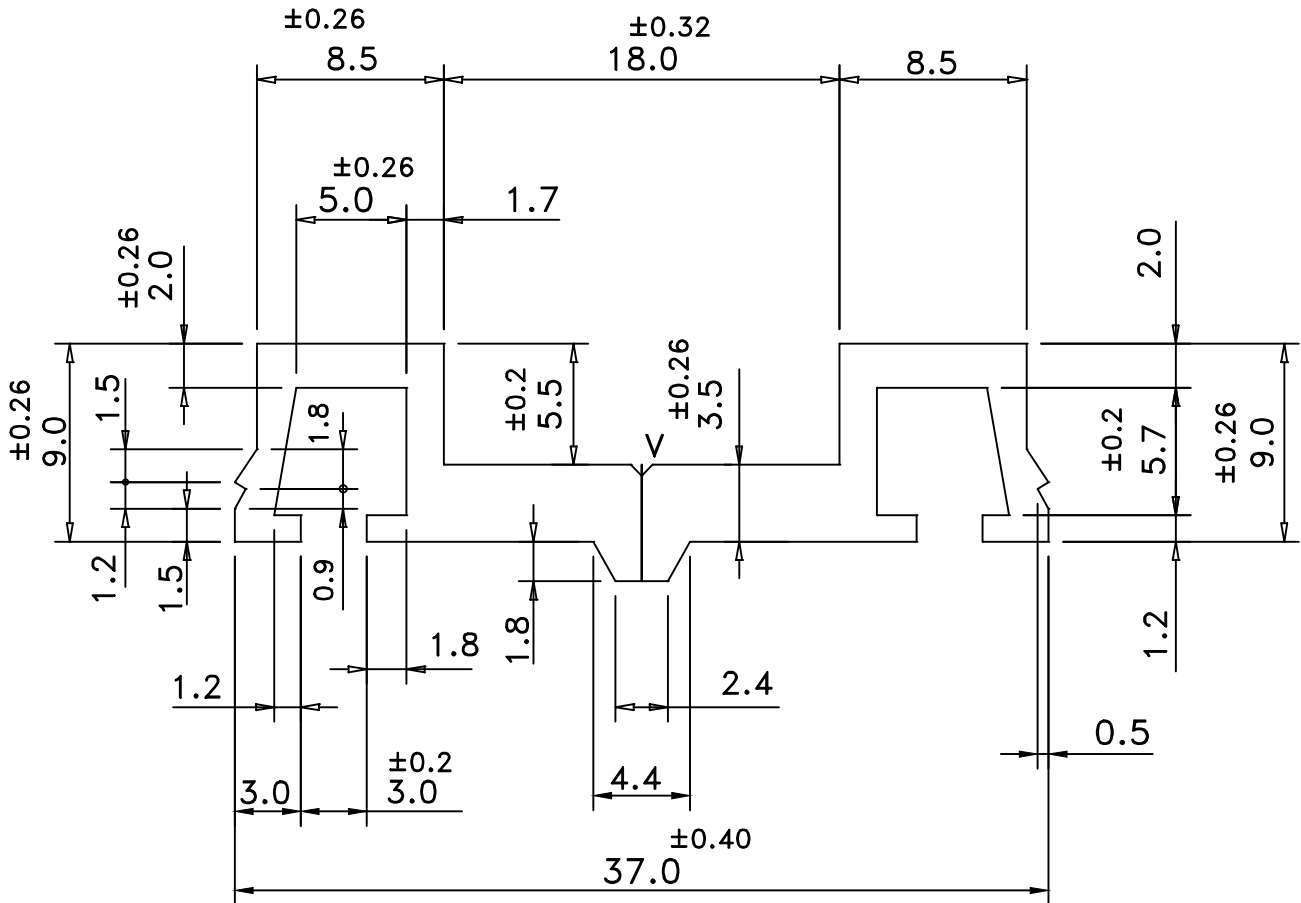

TWIST = $1/4^\circ/300$ M.M.
 STRAIGHTNESS = 1.5 M.M./MTR.
 ANGULARITY = 2°

Note:-

V = $0.5 \times 1.0 \times 90^\circ$ 

SYMBOL OF QUALITY
AN ISO 9001 COMPANY

JINDAL ALUMINIUM LTD.
BANGALORE-560073 (INDIA)

1. ALL DIMENSIONS ARE IN mm.
2. ROUND OFF ALL SHARP CORNERS WITH 0.40 mm.
3. TOLERANCES WILL BE AS PER IS:3965-1981, UNLESS OTHERWISE SPECIFIED

	NAME	DATE
DRAWN	PARVESH	10-12-2021
CHECKED		
APPROVED		
SCALE		1:1
AREA mm ²		157.5
PERIMETER mm.		153.5
WEIGHT kg/m		0.425
DRAWING No.	SECTION No.	
IAL-D-3524	-	
36412	36412	

PARTY'S NAME STAR ALUBUILD

PARTY'S DRAWING No. -

ALLOY & TEMPER 6063 T6

DESCRIPTION CURTAIN WALL SECTION

PRODUCED BY AN AUTODESK EDUCATIONAL PRODUCT

PRODUCED BY AN AUTODESK EDUCATIONAL PRODUCT

PRODUCED BY AN AUTODESK EDUCATIONAL PRODUCT