

P-16439

S5164

38011

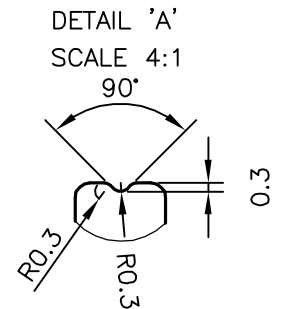
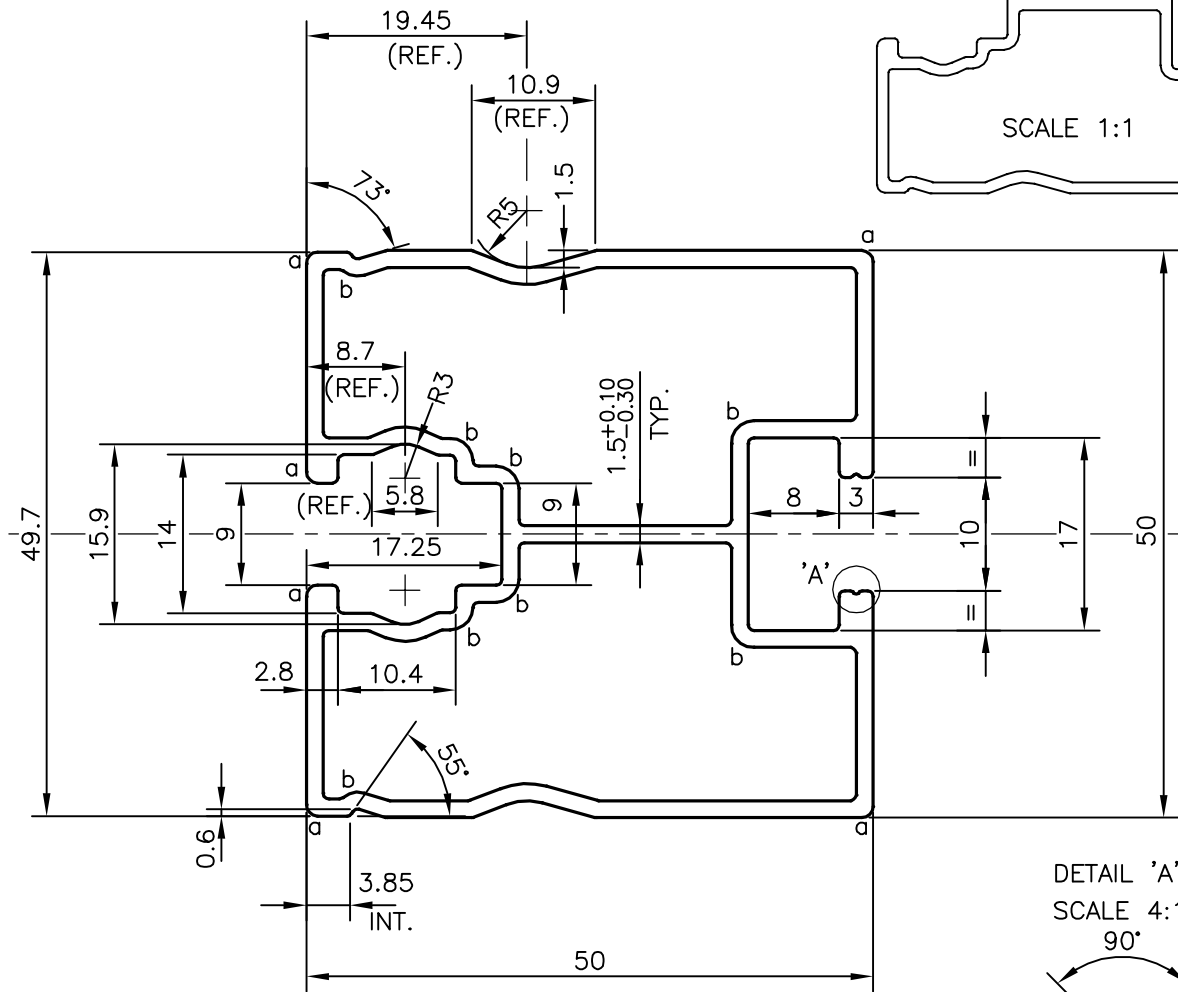
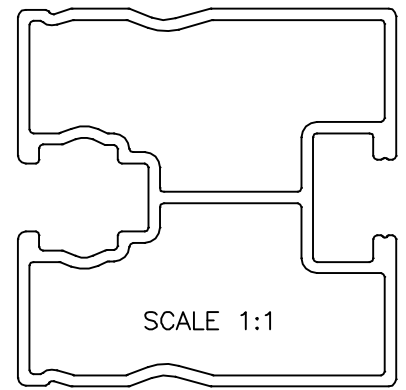

a : RADIUS 1.00 mm (6 PLACES)  
b : RADIUS 2.00 mm (8 PLACES)

TOLERANCES ON OVERALL WIDTHS & WIDTHS ACROSS FLATS OF BARS, & REGULAR SECTIONS

UPTO 6.40mm - ±0.20	UPTO 32.0mm - ±0.38	UPTO 120.0mm - ±0.85	1. STRAIGHTNESS=1.7mm/M 2. TWIST=1.7mm/M 3. ANGULARITY= ±2° 4. FLATNESS =0.007xWIDTH
UPTO 10.0mm - ±0.23	UPTO 50.0mm - ±0.46	UPTO 160.0mm - ±1.02	
UPTO 12.0mm - ±0.25	UPTO 60.0mm - ±0.53	UPTO 200.0mm - ±1.14	
UPTO 16.0mm - ±0.28	UPTO 80.0mm - ±0.69	UPTO 250.0mm - ±1.40	
UPTO 25.0mm - ±0.30	UPTO 100.0mm - ±0.75	UPTO 300.0mm - ±1.65	



SYMBOL OF QUALITY  
AN ISO 9001 COMPANY

**JINDAL ALUMINIUM LTD.**  
BANGALORE-560073 (INDIA)

	NAME	DATE
DRAWN	KIRAN	27-10-2016
CHECKED		
APPROVED	B.NATARAJ	04-11-2016

1. ALL DIMENSIONS ARE IN mm.
2. ROUND OFF ALL SHARP CORNERS WITH 0.50 mm.
3. TOLERANCES WILL BE AS PER IS:6477-1983, UNLESS OTHERWISE SPECIFIED

SCALE	1.5:1
AREA mm <sup>2</sup>	435.74
PERIMETER mm.	276.359
WEIGHT kg/m	1.176

PARTY'S NAME	INSOLARE ENERGY PVT. LTD., BANGALORE
PARTY'S DRAWING No.	INF-BLR-CIV-DWG-002 (AutoCAD DRAWING)
ALLOY & TEMPER	6063 T6
DESCRIPTION	SOLAR SECTION

DRAWING No.	SECTION No.
P-16439	
S5164	S5164
38011	38011