

P-21783-1

38762

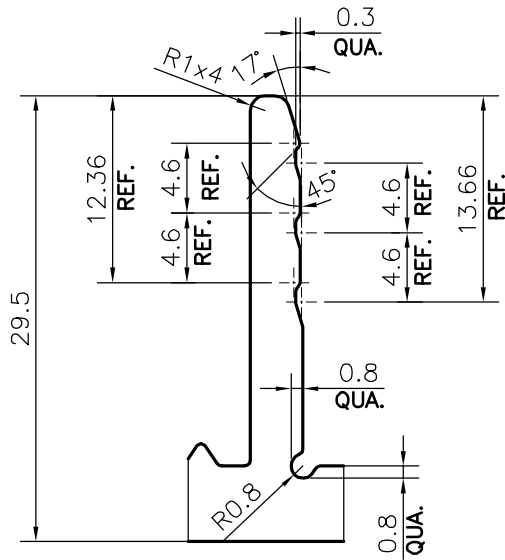

SCALE:- 2:1
DETAIL OF "A"

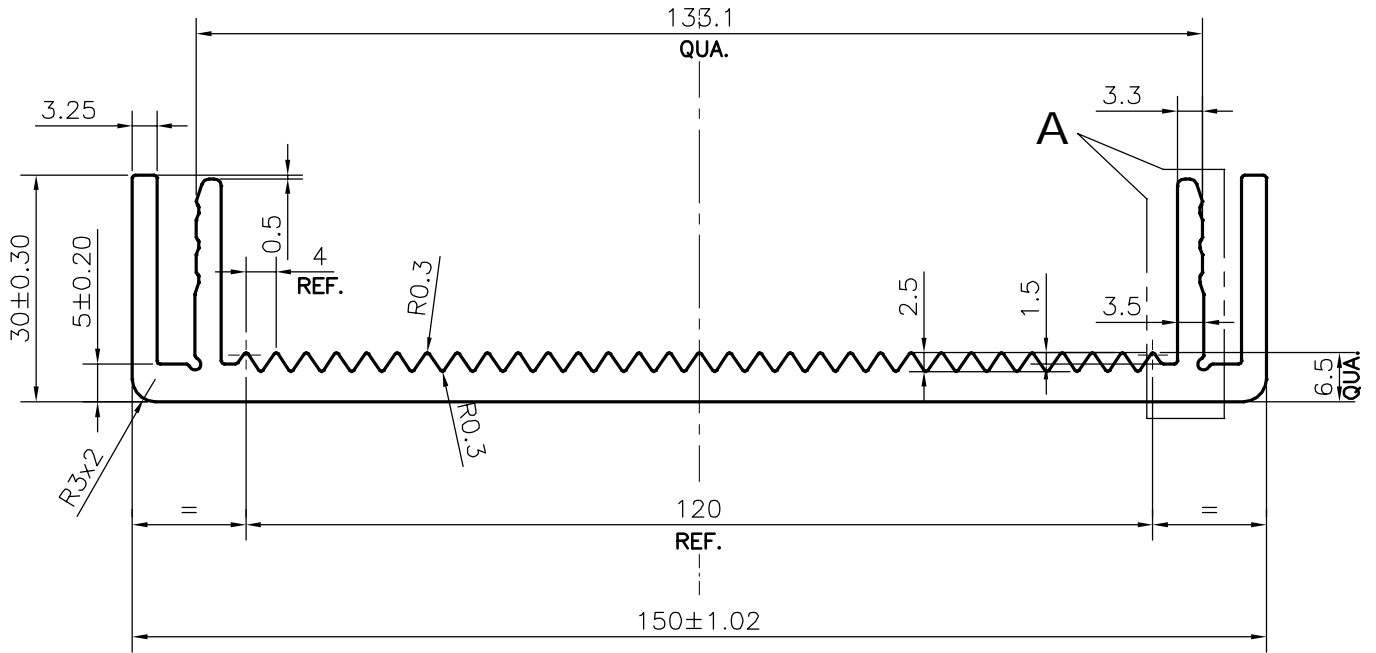
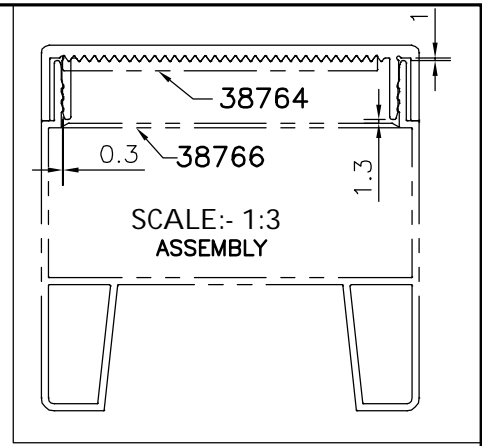

SCALE:- 1:1

APPROXIMATE WEIGHT RANGE - 2.665 - 3.257 kg/m

1) THE WELDING LINE IN THE EXPOSED SURFACE OF PROFILE IS UNAVOIDABLE. 2) PLEASE SPECIFY IMPORTANT SIZES. 3) PLEASE SPECIFY IF THIS PROFILE MATCHES WITH OTHER PROFILES. 4) PLEASE SPECIFY EXPOSED SURFACE. OTHER WISE CONSIDERED AS NO EXPOSED SURFACE. 5) FINISH :- MILL FINISH / ANODIZING / POWDER COATING



SYMBOL OF QUALITY
AN ISO 9001 COMPANY

JINDAL ALUMINIUM LTD.
BANGALORE-560073 (INDIA)

	NAME	DATE
DRAWN	DARPAN	05-12-2020
CHECKED		
APPROVED	B.NATARAJA	10-12-2020
SCALE		1:1
AREA mm ²		1096.713
PERIMETER mm.		583.816
WEIGHT kg/m		2.961
DRAWING No.	SECTION No.	
P-21783-1	-	
38762	38762	

1. ALL DIMENSIONS ARE IN mm.
2. ROUND OFF ALL SHARP CORNERS WITH 0.40 mm.
3. TOLERANCES WILL BE AS PER IS:3965-1981 UNLESS OTHERWISE SPECIFIED

PARTY'S NAME	DURALL SYSTEMS INDIA PVT. LTD., MUMBAI
PARTY'S DRAWING No.	NIB 04 REV. R1
ALLOY & TEMPER	6063 T6
DESCRIPTION	NIB PROFILE ADAPTOR (LEFT LOBBY)