

P-21902

38777

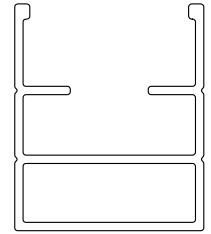

SCALE:- 1:1

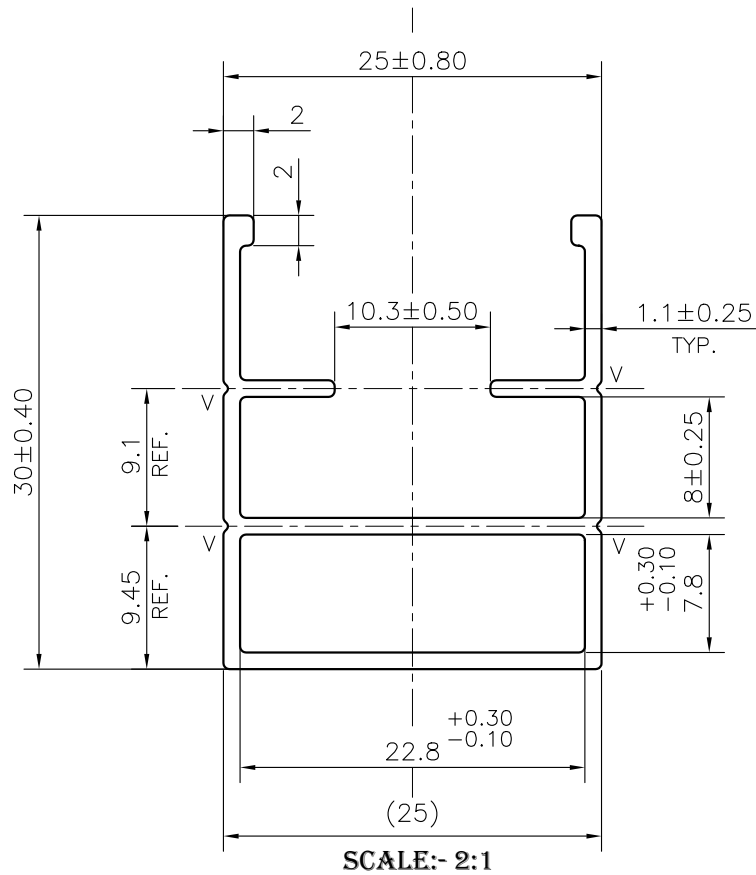

APPROXIMATE WEIGHT RANGE - 0.277 - 0.441 kg/m

V="V" GROOVE 0.3x90° (4 PLACES)

TOLERANCE CHART CD = CIRCUMSCRIBING CIRCLE			
CD ≤ 100	100 < CD ≤ 200	200 < CD < 300	300 < CD < 500
UPTO 10mm - ±0.25	±0.30	±0.35	±0.40
10.0 - 25 - ±0.30	±0.40	±0.50	±0.60
25.0 - 50 - ±0.50	±0.60	±0.80	±0.90
50.0 - 100 - ±0.70	±0.90	±1.10	±1.30
100 - 150 - -	±1.10	±1.30	±1.50
150 - 200 - -	±1.3	±1.50	±1.80
200 - 300 - -	-	±1.70	±2.10
300 - 450 - -	-	-	±2.80

1. STRAIGHTNESS=1.7mm/M  
 2. TWIST=1.7mm/M  
 3. ANGULARITY= ±2°  
 4. FLATNESS =0.007xWIDTH



SYMBOL OF QUALITY  
AN ISO 9001 COMPANY

**JINDAL ALUMINIUM LTD.**  
BANGALORE-560073 (INDIA)

	NAME	DATE
DRAWN	DARPAN	24-12-2020
CHECKED		
APPROVED	B.NATARAJA	31-12-2020
SCALE		2:1
AREA mm <sup>2</sup>		132.84
PERIMETER mm.		175.92
WEIGHT kg/m		0.359
DRAWING No.		SECTION No.
P-21902		-
38777		38777

- ALL DIMENSIONS ARE IN mm.
- ROUND OFF ALL SHARP CORNERS WITH 0.40 mm.
- TOLERANCES WILL BE AS PER BS:EN-755-9 , UNLESS OTHERWISE SPECIFIED

PARTY'S NAME: SUNRISE BUILDING SYSTEMS, NEW DELHI

PARTY'S DRAWING No.: AS PER DRAWING

ALLOY & TEMPER: 6063 T6

DESCRIPTION: ARCHITECTURAL SECTION