

IAL-D-3252

42517

WT. RANGE:- 0.380 - 0.503 KG./M.

	(B)	$\begin{matrix} +0.20 \\ -0.10 \\ 0.20 \end{matrix}$ DIM.-1.25 WAS 1.2 mm.
004	(Ref.)	MKT-22/R-10/2005/860 Dt.-22.7.05
REVISION		

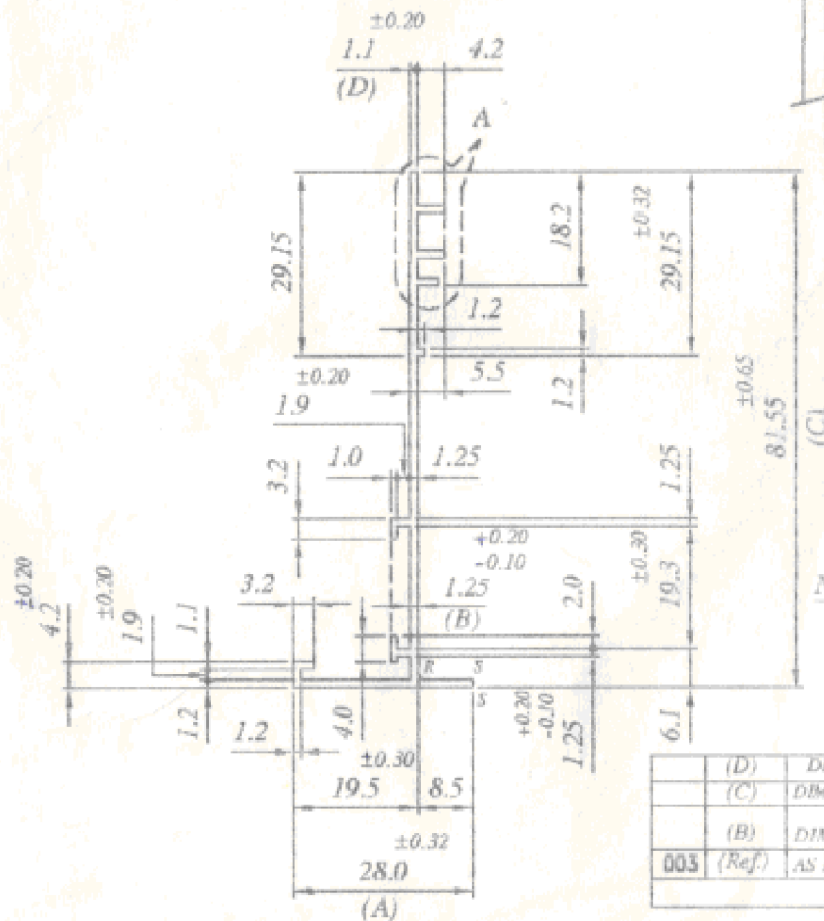

Note:-

S - SHARP CORNERS

R = 1.0R

	(D)	DIM.-1.1 WAS 1.2 mm.
	(C)	DIM.-81.55 WAS 71.0 mm.
	(B)	$\begin{matrix} +0.20 \\ -0.10 \\ 0.20 \end{matrix}$ DIM.-1.2 WAS 1.5 mm.
003	(Ref.)	AS PER DISC. WITH U.D. Dt.-3.10.05
REVISION		

LOCATION:- P1-1HOLE  
ALL DIMENSION ARE IN M.M.  
UNSPECIFIED CORNER RADIUS:0.40

TOL. AS PER B.S.1474:1987  
UNLESS SPECIFIED

TWIST =  $1/4^{\circ}/300$  M.M./M.  
STRAIGHTNESS= 2.5 M.M./MTR.  
ANGULARITY =  $2^{\circ}$



SYMBOL OF QUALITY  
AN ISO 9001 COMPANY

**JINDAL ALUMINIUM LTD.**  
BANGALORE-560073 (INDIA)

	NAME	DATE
DRAWN	PARVESH	23-12-2021
CHECKED		
APPROVED		

1. ALL DIMENSIONS ARE IN mm.
2. ROUND OFF ALL SHARP CORNERS WITH 0.40 mm.
3. TOLERANCES WILL BE AS PER IS:3965-1981 , UNLESS OTHERWISE SPECIFIED

SCALE	1:1
AREA mm <sup>2</sup>	165.0
PERIMETER mm.	275.4
WEIGHT kg/m	0.445

DRAWING No.	SECTION No.
IAL-D-3252	-
42517	42517

ALLOY & TEMPER	6063 T6
DESCRIPTION	AIR GRILL SECTION