

P-22632-1

43545

ISSUE-2:- 1.RADIUS CHANGED FROM 11.5 MM TO 12 MM  
 2.ANGLE CHANGED FROM 34° TO 19°  
 3.WEIGHT CHANGED FROM 2.202 Kg/m TO 2.249 Kg/m

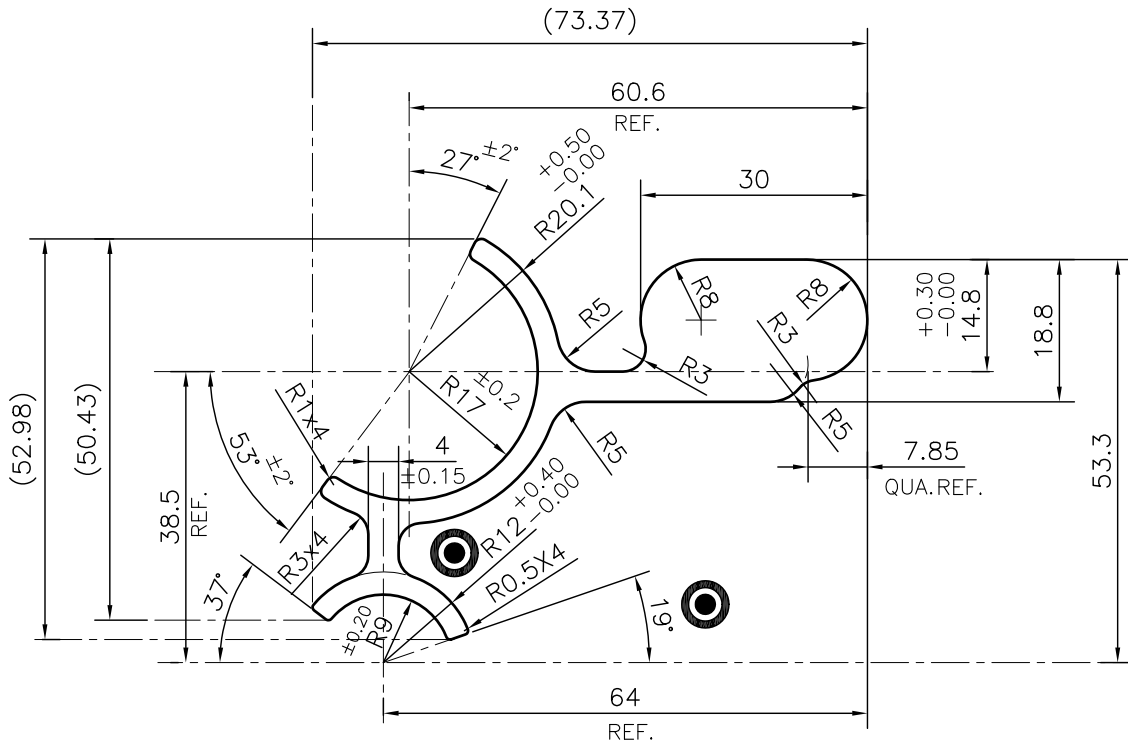

SCALE:- 1:1

TOLERANCES ON OVERALL WIDTHS & WIDTHS ACROSS FLATS OF BARS, & REGULAR SECTIONS

UPTO 6.40mm - ±0.20	UPTO 32.0mm - ±0.38	UPTO 120.0mm - ±0.85	1. STRAIGHTNESS=1.7mm/M 2. TWIST=1.7mm/M 3. ANGULARITY= ±2° 4. FLATNESS =0.007xWIDTH
UPTO 10.0mm - ±0.23	UPTO 50.0mm - ±0.46	UPTO 160.0mm - ±1.02	
UPTO 12.0mm - ±0.25	UPTO 60.0mm - ±0.53	UPTO 200.0mm - ±1.14	
UPTO 16.0mm - ±0.28	UPTO 80.0mm - ±0.69	UPTO 250.0mm - ±1.40	
UPTO 25.0mm - ±0.30	UPTO 100.0mm - ±0.75	UPTO 300.0mm - ±1.65	



SYMBOL OF QUALITY  
AN ISO 9001 COMPANY

**JINDAL ALUMINIUM LTD.**  
BANGALORE-560073 (INDIA)

	NAME	DATE
DRAWN	PUNITH	07/08/2021
CHECKED		
APPROVED	B.NATARAJA	14/08/2021
SCALE		1:1
AREA mm <sup>2</sup>		833.093
PERIMETER mm.		276.115
WEIGHT kg/m		2.249
DRAWING No.		SECTION No.
P-22632-1		-
43545		43545(ISSUE-2)

1. ALL DIMENSIONS ARE IN mm.
2. ROUND OFF ALL SHARP CORNERS WITH 0.40 mm.
3. TOLERANCES WILL BE AS PER IS:3965-1981, UNLESS OTHERWISE SPECIFIED

PARTY'S NAME	PYN PRECISION COMPONENTS, FARIDABAD
PARTY'S DRAWING No.	MODIFIED SECTION OF 28586
ALLOY & TEMPER	6005 T5
DESCRIPTION	INLET FLANGE SECTION