

IAL-A-1051

43634

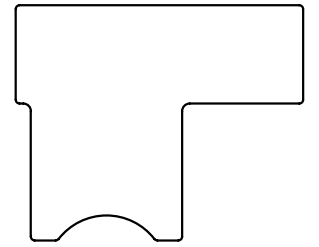
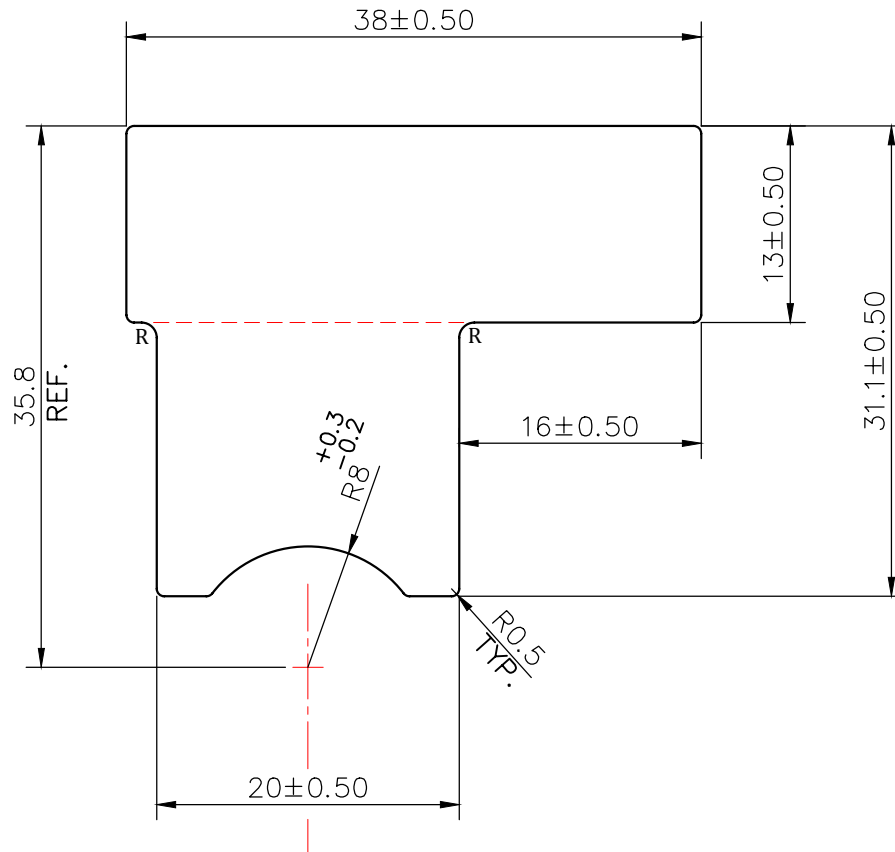

SCALE 1:1

**NOTE:-****R= 1.0 RADIUS (2 PLACES)**

1. STRAIGHTNESS= 1.7mm/M
2. TWIST= 1.7mm/M
3. ANGULARITY=  $\pm 2^\circ$
4. FLATNESS= 0.007xWIDTH



SYMBOL OF QUALITY  
AN ISO 9001 COMPANY

**JINDAL ALUMINIUM LTD.**  
BHIWADI-301019 (INDIA)

	NAME	DATE
DRAWN	ASHUTOSH	27-07-2023
CHECKED		
APPROVED		
SCALE	2:1	
AREA mm <sup>2</sup>	826.17	
PERIMETER mm.	138.12	
WEIGHT kg/m	2.231	
DRAWING No.	SECTION No.	
IAL-A-1051		
43634	43634	

1. ALL DIMENSIONS ARE IN mm.
2. ROUND OFF ALL SHARP CORNERS WITH 0.40 mm.
3. TOLERANCES WILL BE AS PER BS:EN-755-9 , UNLESS OTHERWISE SPECIFIED

PARTY'S NAME	PARNAV VIKASH	
PARTY'S DRAWING No.	AS PER DRAWING	
ALLOY & TEMPER	6063 T6	PRODUCT CODE:-085 HSN CODE:-76042990
DESCRIPTION	AUTOMOBILE SECTION	