

IAL-A-1033

A1033

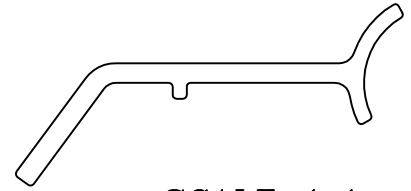

SCALE 1:1

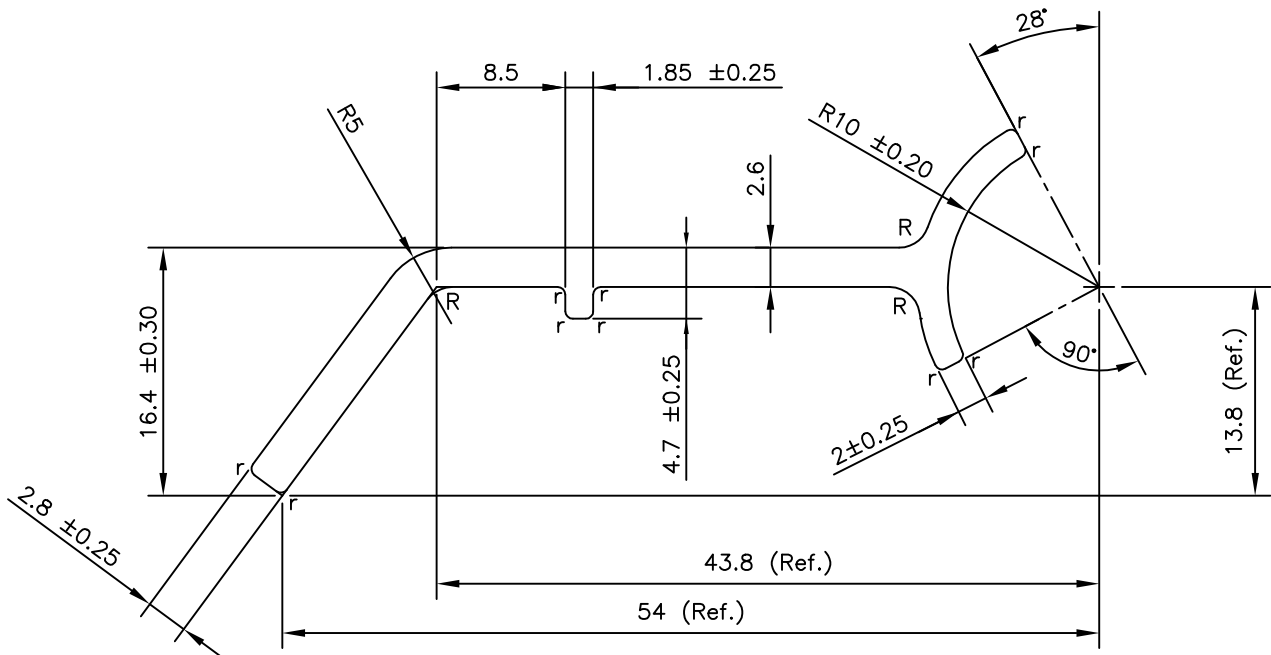

NOTE: -

$r=0.50R$   
 $R=2.00R$

TWIST=  $\pm 1/4^\circ/300\text{M.M./M.}$   
 FLATNESS=  $\text{WIDTH} \times 0.005\text{mm.}$   
 STRAIGHTNESS= 1.5 M.M./MTR.  
 ANGULARITY=  $\pm 1.5^\circ$



SYMBOL OF QUALITY  
 AN ISO 9001 COMPANY

**JINDAL ALUMINIUM LTD.**  
 BANGALORE-560073 (INDIA)

	NAME	DATE
DRAWN	ASHUTOSH	10-05-2022
CHECKED		
APPROVED		

- ALL DIMENSIONS ARE IN mm.
- ROUND OFF ALL SHARP CORNERS WITH 0.40 mm.
- TOLERANCES WILL BE AS PER BS:EN-755-9, UNLESS OTHERWISE SPECIFIED

SCALE	1:1 2:1
AREA mm <sup>2</sup>	173.06
PERIMETER mm.	140.04
WEIGHT kg/m	0.467

PARTY'S NAME M/S. PRANAV VIKAS

DRAWING No. SECTION No.

PARTY'S DRAWING No. AS PER DRAWING

IAL-A-1033

ALLOY & TEMPER 6063-T6

A1033

A1033

DESCRIPTION AUTOMOBILE SECTION