

IAL-A-377

A377

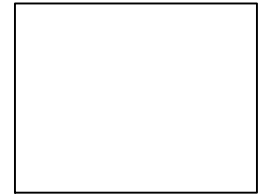
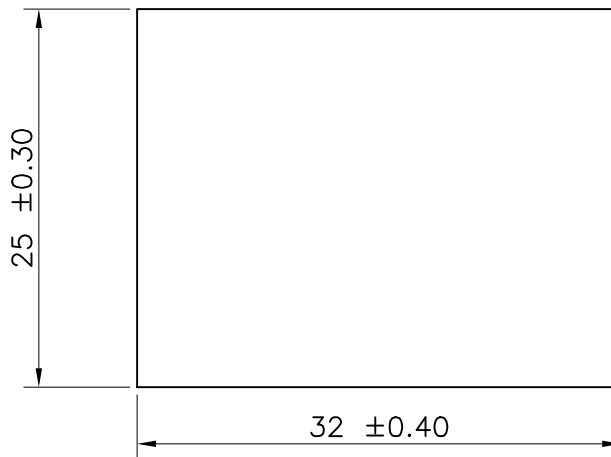

SCALE 1:1

TWIST= $\pm 1/4^\circ/300\text{M.M./M.}$ FLATNESS= $\text{WIDTH} \times 0.005\text{mm.}$ STRAIGHTNESS= 1.5 M.M./MTR. ANGULARITY= $\pm 1.5^\circ$ 

SYMBOL OF QUALITY
AN ISO 9001 COMPANY

JINDAL ALUMINIUM LTD.
BANGALORE-560073 (INDIA)

	NAME	DATE
DRAWN	ASHUTOSH	21-06-2022
CHECKED		
APPROVED		

1. ALL DIMENSIONS ARE IN mm.
2. ROUND OFF ALL SHARP CORNERS WITH 0.40 mm.
3. TOLERANCES WILL BE AS PER IS:3965-1981 , UNLESS OTHERWISE SPECIFIED

SCALE	1:1&2:1
AREA mm ²	800.00
PERIMETER mm.	114.00
WEIGHT kg/m	2.160
DRAWING No.	SECTION No.
IAL-A-377	
A377	A377

PARTY'S NAME	M/S. KOHLI ALUMINIUM
PARTY'S DRAWING No.	AS PER DRAWING
ALLOY & TEMPER	HE9 WP
DESCRIPTION	FLAT BAR