

MAL NO. 6042

-

B-220

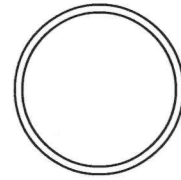

SCALE 1:1

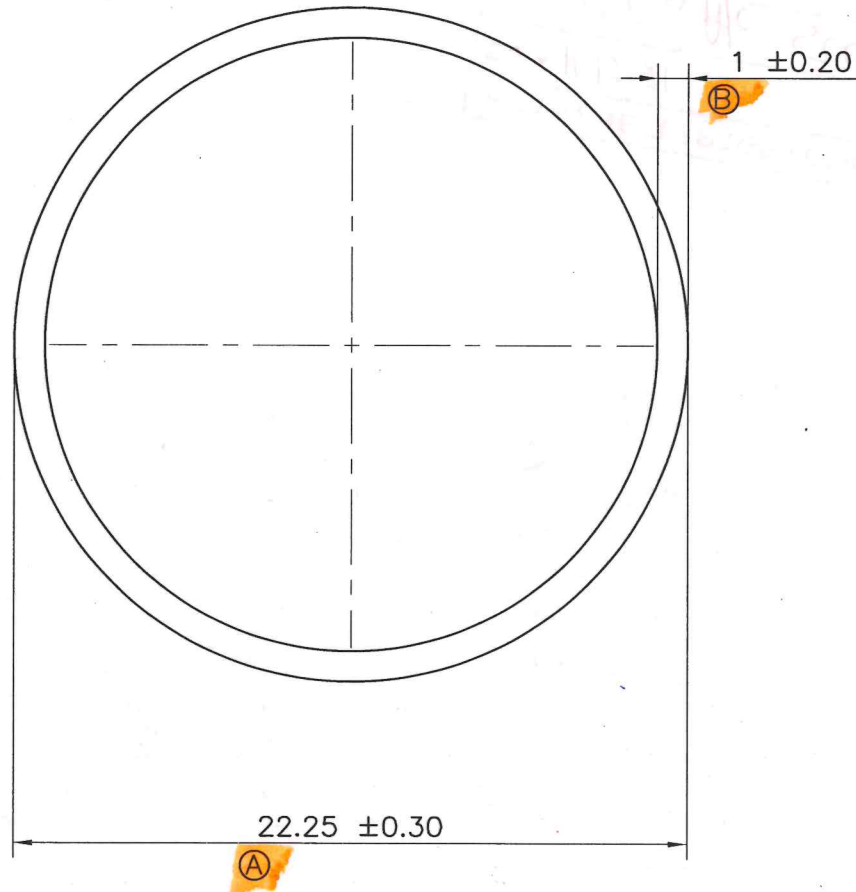

NOTE:-

ISSUE-2

(A) DIM. 22.25 ± 0.30 WAS $22 - 0.10$ ± 0.40

(B) DIM. 1 ± 0.20 WAS $1 - 0.10$ ± 0.30

TWIST = $\pm 1/4^\circ / 300 \text{ M.M. / M.}$ FLATNESS = $\text{WIDTH} \times 0.005 \text{ mm.}$ STRAIGHTNESS = 1.5 M.M. / MTR. ANGULARITY = $\pm 1.5^\circ$ 

SYMBOL OF QUALITY
AN ISO 9001 COMPANY

JINDAL ALUMINIUM LTD.
BANGALORE-560073 (INDIA)

1. ALL DIMENSIONS ARE IN mm.
2. ROUND OFF ALL SHARP CORNERS WITH 0.40 mm.
3. TOLERANCES WILL BE AS PER BS:EN-755-9 , UNLESS OTHERWISE SPECIFIED

		NAME	DATE
PARTY'S NAME		M/S. C.S.T.- INDIA	
PARTY'S DRAWING No.		AS PER DRAWING (Z60-29601)	
ALLOY & TEMPER		6063	
DESCRIPTION		--	
		DRAWN	ASHUTOSH
		CHECKED	Pratik
		APPROVED	Pratik
		SCALE	1:1&4:1
		AREA mm ²	66.76
		PERIMETER mm.	69.90
		WEIGHT kg/m	0.180
		DRAWING No.	SECTION No.
		MAL NO. 6042	B-220
		-	ISSUE-2