

MAL NO-0251

C697

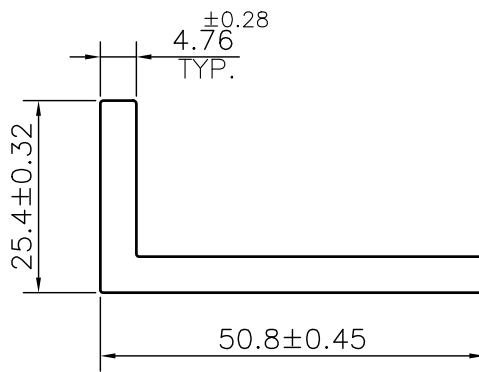

- 1. STRAIGHTNESS= 1.7mm/M
- 2. TWIST= 1.7mm/M
- 3. ANGULARITY= $\pm 2^\circ$
- 4. FLATNESS= 0.007xWIDTH



SYMBOL OF QUALITY
AN ISO 9001 COMPANY

JINDAL ALUMINIUM LTD.
BHIWADI-301019 (INDIA)

	NAME	DATE
DRAWN	ASHUTOSH	12-09-2023
CHECKED		
APPROVED		
SCALE		1:1
AREA mm ²		339.917
PERIMETER mm.		151.37
WEIGHT kg/m		0.918
DRAWING No.		SECTION No.
MAL NO-0251		-
C697		C697

- 1. ALL DIMENSIONS ARE IN mm.
- 2. ROUND OFF ALL SHARP CORNERS WITH 0.40 mm.
- 3. TOLERANCES WILL BE AS PER BS:EN-755-9 , UNLESS OTHERWISE SPECIFIED

PARTY'S NAME	RIGHTON	
PARTY'S DRAWING No.	AS PER DRAWING	
ALLOY & TEMPER	6063	PRODUCT CODE:-019
		HSN CODE:- 76042990
DESCRIPTION	UNEQUAL ANGLE SECTION	