

Detail At:-B

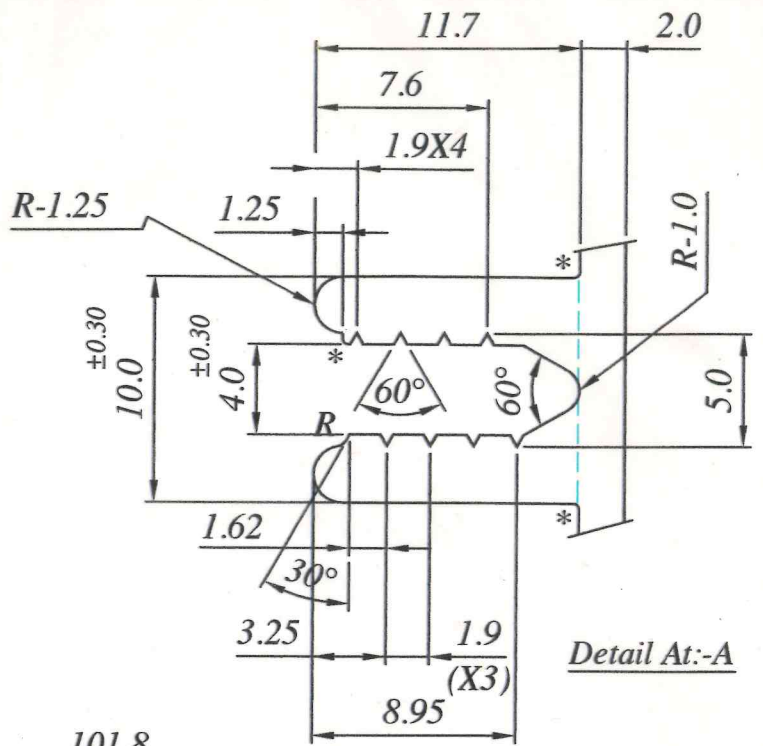

Detail At:-A

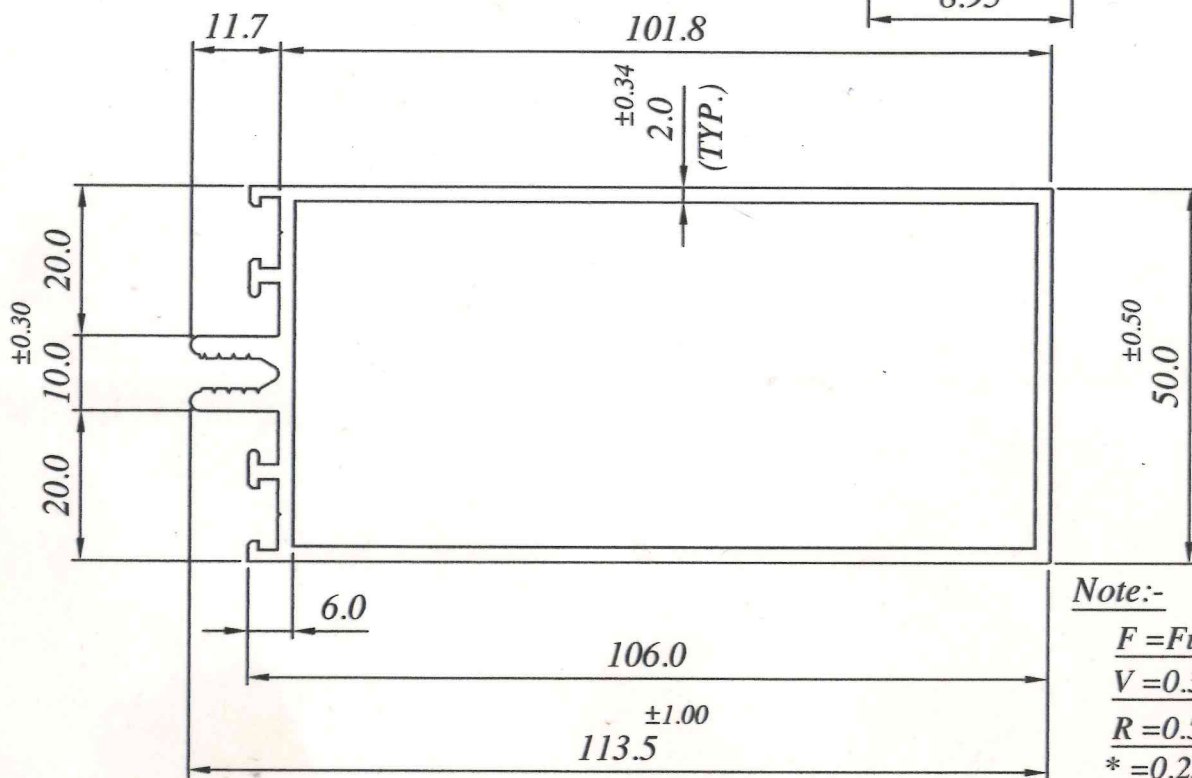

Note:-

- $F = \text{Full Radius}$
- $V = 0.3 \times 0.6 \times 90^\circ$
- $R = 0.5R$
- $* = 0.25R$

SECTION NO : AHL-2005/002

LOCATION:- P₁ = 2Hole

TWIST = 1/4°/300 M.M./M.

ALL DIMENSION ARE IN M.M.
UNSPECIFIED CORNER RADIUS:0.40

TOL. AS PER B.S.1474:1987
UNLESS SPECIFIED

STRAIGHTNESS= 1.5 M.M./MTR.
ANGULARITY = 2°



MAHAVIR ALUMINIUM LIMITED BHIWADI-301019

PARTY SAMPLE & DRG. AHL-2005/002		PARTY NAME M/S. AHLCON INDIA PVT. LTD.		REF.No. AS PER PARTY DRG. Dt.-10.01.2005	
			DRAWNANAND SHARMA	13.01.05	AREA: 704.0 MM ²
			CHECKED <i>SSB</i>	14.1.05	WEIGHT: 1.900 KG/M.
			APPROVED <i>SSB</i>	14.1.05	WT. RANGE: ----- Kg/12'
			SCALE 1:1&3:1	DATE	ALLOY: 6063
OO			CRITICAL DIM. *		MAL.No. 8909
REV. STATUS	REV. NO.	DESCRIPTION	SIGN DATE	PERIMETER	INT. 288.0 EXT. 397.5
		REVISION			SEC.NO. D 3689