

MAL NO.-10124

D4275

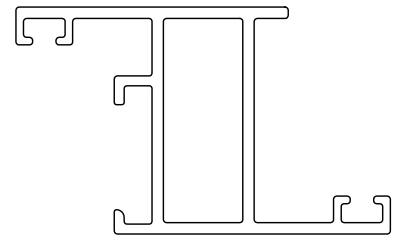

SCALE 1:1

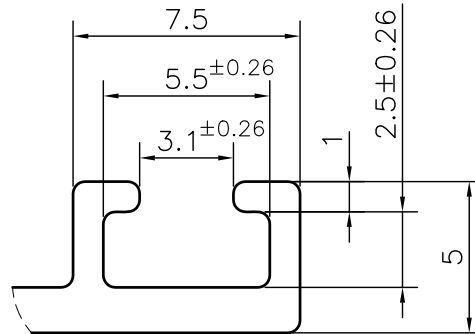
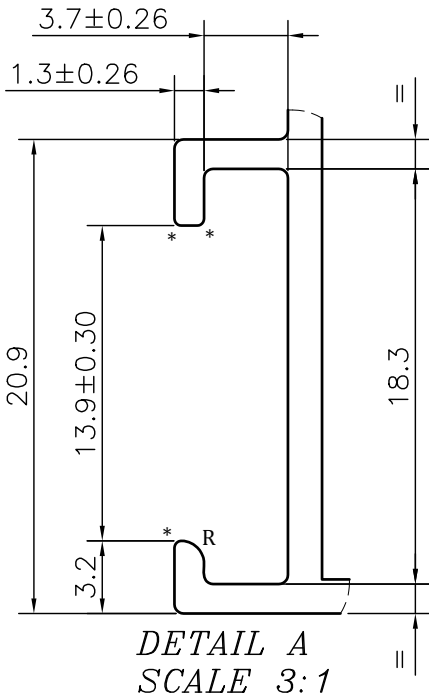
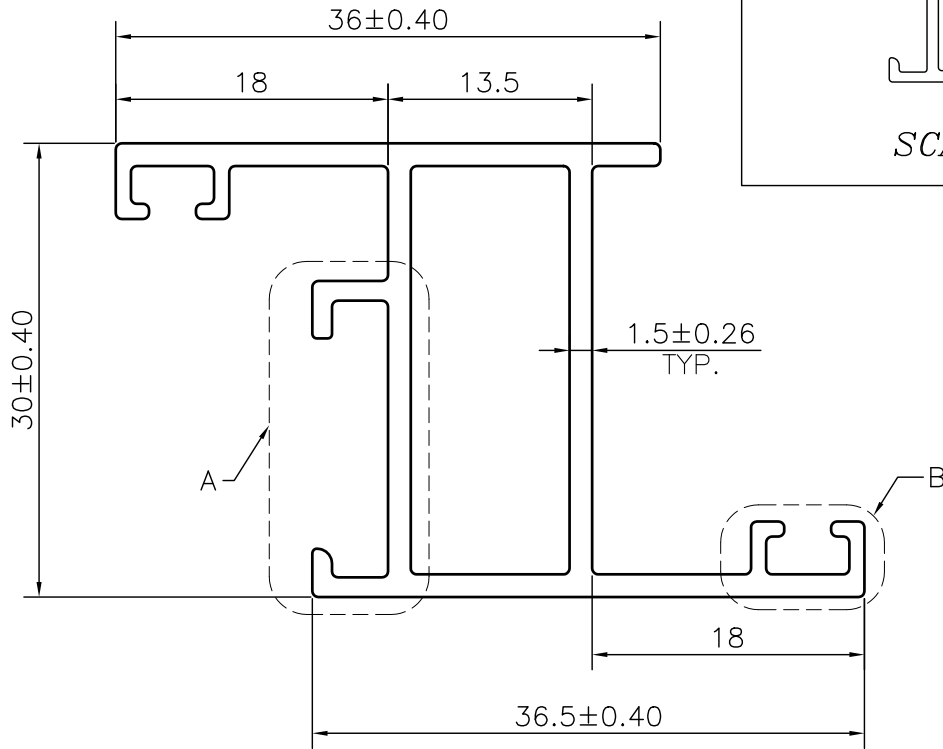

NOTE:-

***= 0.30 RADIUS (3 PLACES)**
R= 1.0 RADIUS (1 PLACE)

1. STRAIGHTNESS= 1.7mm/M
2. TWIST= 1.7mm/M
3. ANGULARITY= ±2°
4. FLATNESS= 0.007xWIDTH



SYMBOL OF QUALITY
AN ISO 9001 COMPANY

JINDAL ALUMINIUM LTD.
BHIWADI-301019 (INDIA)

	NAME	DATE
DRAWN	ASHUTOSH	26-12-2023
CHECKED		
APPROVED		
SCALE		2:1
AREA mm ²		219.635
PERIMETER mm.		227.404
WEIGHT kg/m		0.593
DRAWING No.	SECTION No.	
MAL NO.-10124	-	
D4275	D4275	

1. ALL DIMENSIONS ARE IN mm.
2. ROUND OFF ALL SHARP CORNERS WITH 0.40 mm.
3. TOLERANCES WILL BE AS PER BS:EN-755-9 , UNLESS OTHERWISE SPECIFIED

PARTY'S NAME	AAP DIVISION	
PARTY'S DRAWING No.	AS PER DRAWING -IAIL/ER/SP-04	
ALLOY & TEMPER	6063 T6	PRODUCT CODE:-048
		HSN CODE:- 76042100
DESCRIPTION	WINDOW SECTION	