

MAL-12848

D5422

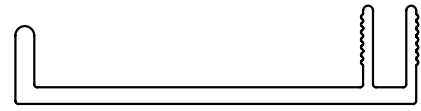

SCALE 1:1

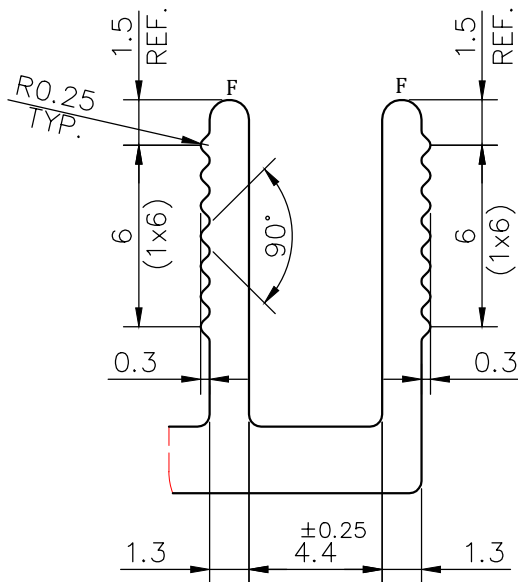
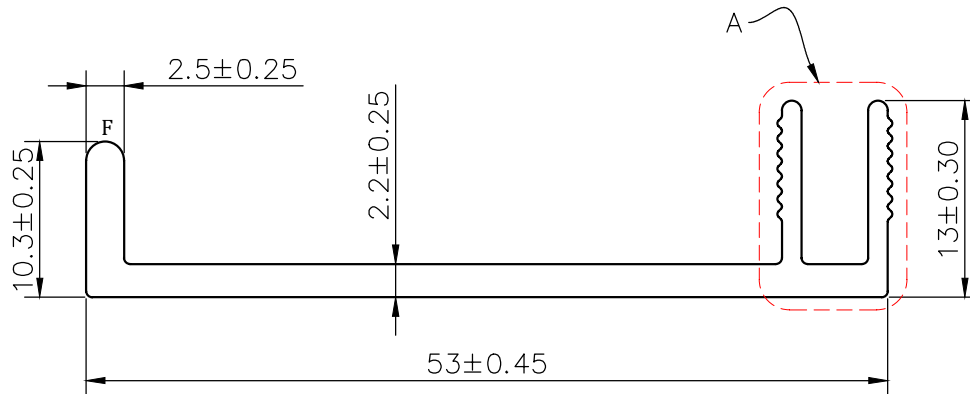

DETAIL A  
SCALE 4:1

**NOTE:-****F= FULL RADIUS (3 PLACES)**

1. STRAIGHTNESS= 1.7mm/M
2. TWIST= 1.7mm/M
3. ANGULARITY=  $\pm 2^\circ$
4. FLATNESS= 0.007xWIDTH



SYMBOL OF QUALITY  
AN ISO 9001 COMPANY

**JINDAL ALUMINIUM LTD.**  
BHIWADI-301019 (INDIA)

	NAME	DATE
DRAWN	ASHUTOSH	17-08-2023

CHECKED

APPROVED

1. ALL DIMENSIONS ARE IN mm.
2. ROUND OFF ALL SHARP CORNERS WITH 0.40 mm.
3. TOLERANCES WILL BE AS PER BS:EN-755-9, UNLESS OTHERWISE SPECIFIED

SCALE 2:1

AREA mm<sup>2</sup> 166.082

PERIMETER mm. 169.52

WEIGHT kg/m 0.448

PARTY'S NAME 3R CONSTRUCTION SOLUTION

DRAWING No.

SECTION No.

PARTY'S DRAWING No. AS PER DRAWING

MAL-12848

ALLOY &amp; TEMPER 6063 T6

PRODUCT CODE: -051

HSN CODE: -76042990

D5422

D5422

DESCRIPTION

MODULAR SECTION