

MAL NO.-14656

D6288

EXPOSED SURFACE

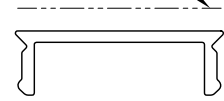

SCALE 1:1

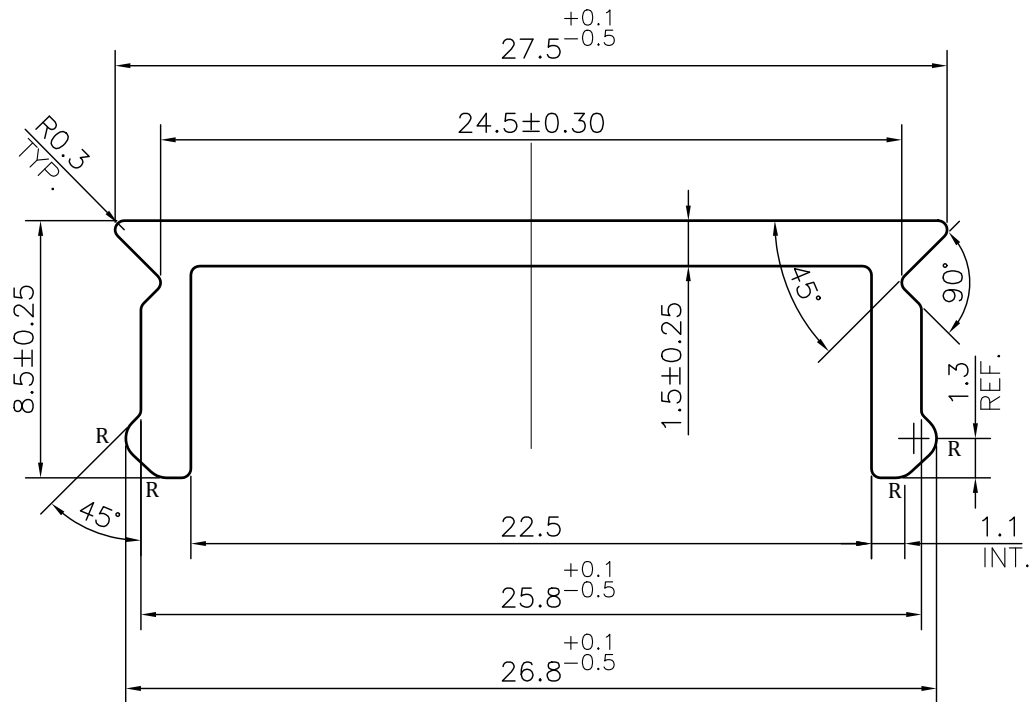

☞ ROUND OFF ALL SHARP CORNERS WITH 0.30 mm.

NOTE:-**R= 0.75 RADIUS (4 PLACES)**

1. STRAIGHTNESS= 1.7mm/M
2. TWIST= 1.7mm/M
3. ANGULARITY= ±2°
4. FLATNESS= 0.007xWIDTH



SYMBOL OF QUALITY
AN ISO 9001 COMPANY

JINDAL ALUMINIUM LTD.
BHIWADI-301019 (INDIA)

	NAME	DATE
DRAWN	ASHUTOSH	08-09-2023
CHECKED		
APPROVED		
SCALE		4:1
AREA mm ²		62.808
PERIMETER mm.		85.22
WEIGHT kg/m		0.170
DRAWING No.		SECTION No.
MAL NO.-14656		-
D6288		D6288

1. ALL DIMENSIONS ARE IN mm.
2. ROUND OFF ALL SHARP CORNERS WITH 0.40 mm.
3. TOLERANCES WILL BE AS PER BS:EN-755-9 , UNLESS OTHERWISE SPECIFIED

PARTY'S NAME	METAFLEX	
PARTY'S DRAWING No.	AS PER DRAWING	
ALLOY & TEMPER	6063 T6	PRODUCT CODE:-044 HSN CODE:- 76042990
DESCRIPTION	GLAZING CLIP SECTION	