

MAL-15049

D6595

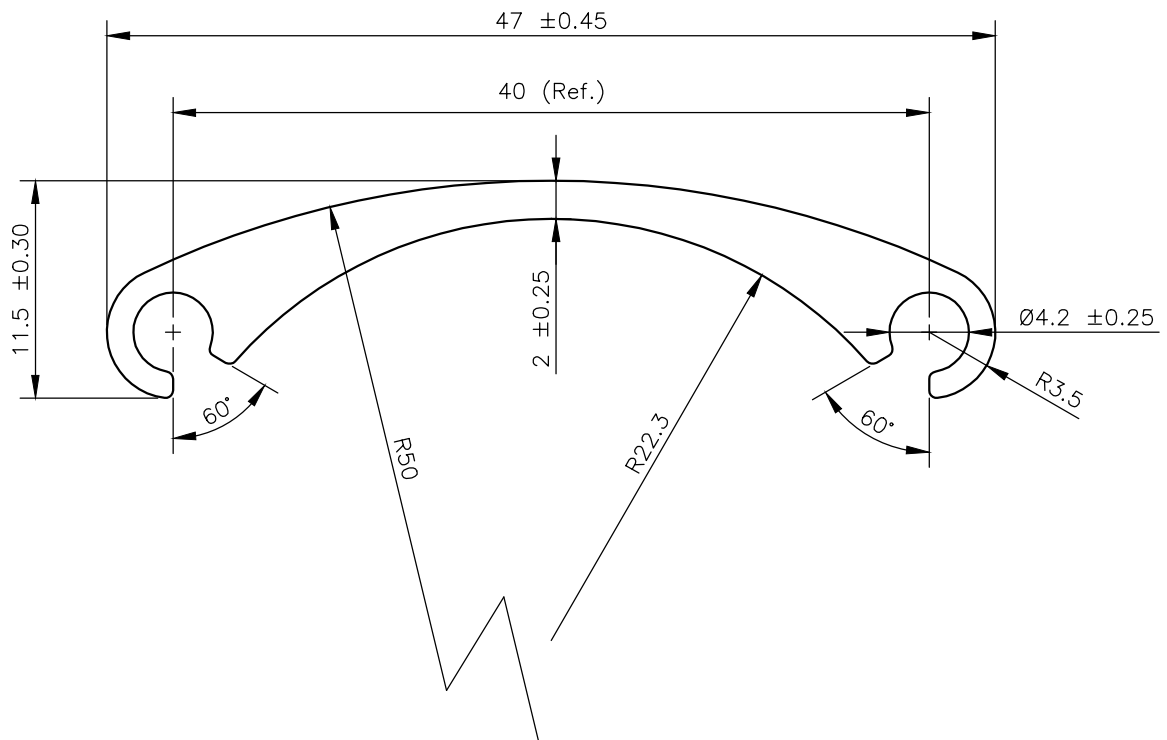

SCALE 1:1

TWIST= $\pm 1/4^\circ/300\text{M.M./M.}$ FLATNESS= $\text{WIDTH} \times 0.005\text{mm.}$

STRAIGHTNESS= 1.5 M.M./MTR.

ANGULARITY= $\pm 1.5^\circ$ 

SYMBOL OF QUALITY
AN ISO 9001 COMPANY

JINDAL ALUMINIUM LTD.
BANGALORE-560073 (INDIA)

	NAME	DATE
DRAWN	ASHUTOSH	10-05-2022
CHECKED		
APPROVED		

1. ALL DIMENSIONS ARE IN mm.
2. ROUND OFF ALL SHARP CORNERS WITH 0.40 mm.
3. TOLERANCES WILL BE AS PER BS:EN-755-9 , UNLESS OTHERWISE SPECIFIED

SCALE	1:1 2.5:1
AREA mm ²	164.54
PERIMETER mm.	128.28
WEIGHT kg/m	0.444

PARTY'S NAME	M/S. ANTARCTICA EQUIPMENT	DRAWING No.	SECTION No.
PARTY'S DRAWING No.	AS PER DRAWING	MAL-15049	
ALLOY & TEMPER	6063 T6	D6595	D6595
DESCRIPTION	REFRIGERATOR SECTION		