

MAL-15656

D6747

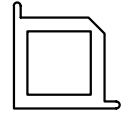
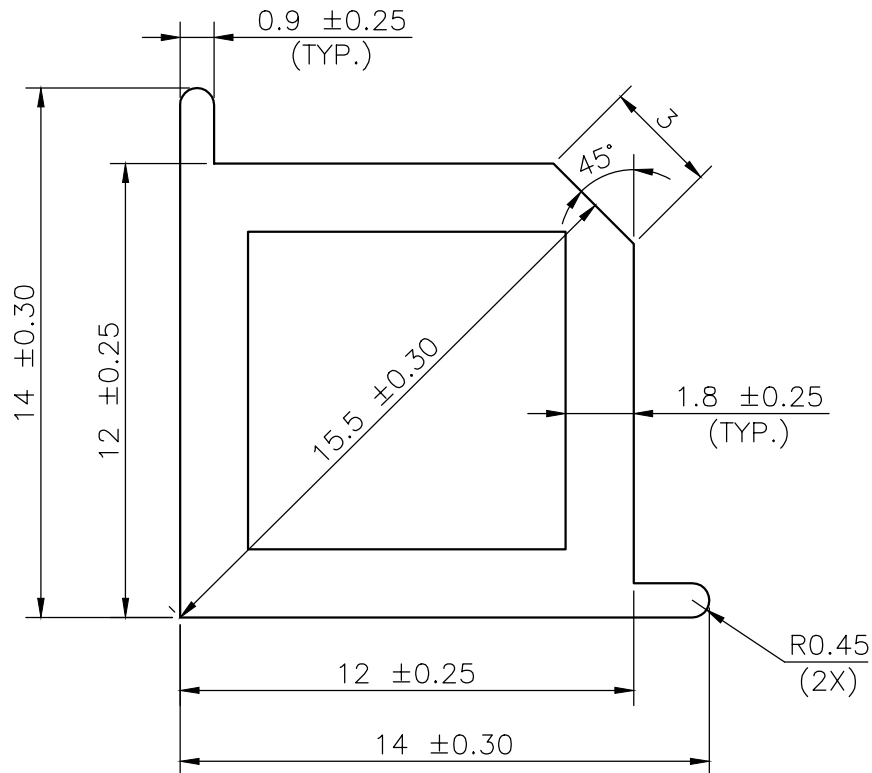

SCALE 1:1

TWIST= $\pm 1/4^\circ/300\text{M.M./M.}$ FLATNESS= $\text{WIDTH} \times 0.005\text{mm.}$ STRAIGHTNESS= 1.5 M.M./MTR. ANGULARITY= $\pm 1.5^\circ$ 

SYMBOL OF QUALITY
AN ISO 9001 COMPANY

JINDAL ALUMINIUM LTD.
BANGALORE-560073 (INDIA)

	NAME	DATE
DRAWN	ASHUTOSH	24-06-2022
CHECKED		
APPROVED		

1. ALL DIMENSIONS ARE IN mm.
2. ROUND OFF ALL SHARP CORNERS WITH 0.40 mm.
3. TOLERANCES WILL BE AS PER BS:EN-755-9, UNLESS OTHERWISE SPECIFIED

SCALE	5:1
AREA mm^2	74.62
PERIMETER mm.	53.98
WEIGHT kg/m	0.201

PARTY'S NAME	M/S. PERFECT SOLUTIONS	DRAWING No.	SECTION No.
PARTY'S DRAWING No.	AS PER DRAWING	MAL-15656	
ALLOY & TEMPER	6063 T6	D6747	D6747
DESCRIPTION	FURNITURE SECTION		