

MAL-15737

D6800

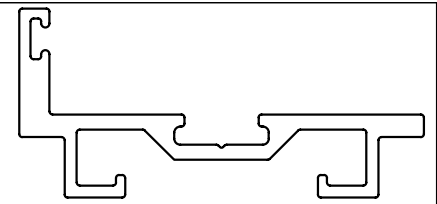

SCALE 1:1

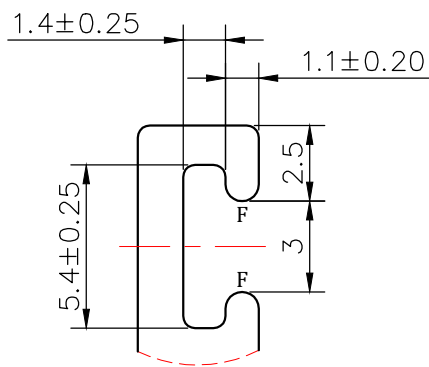
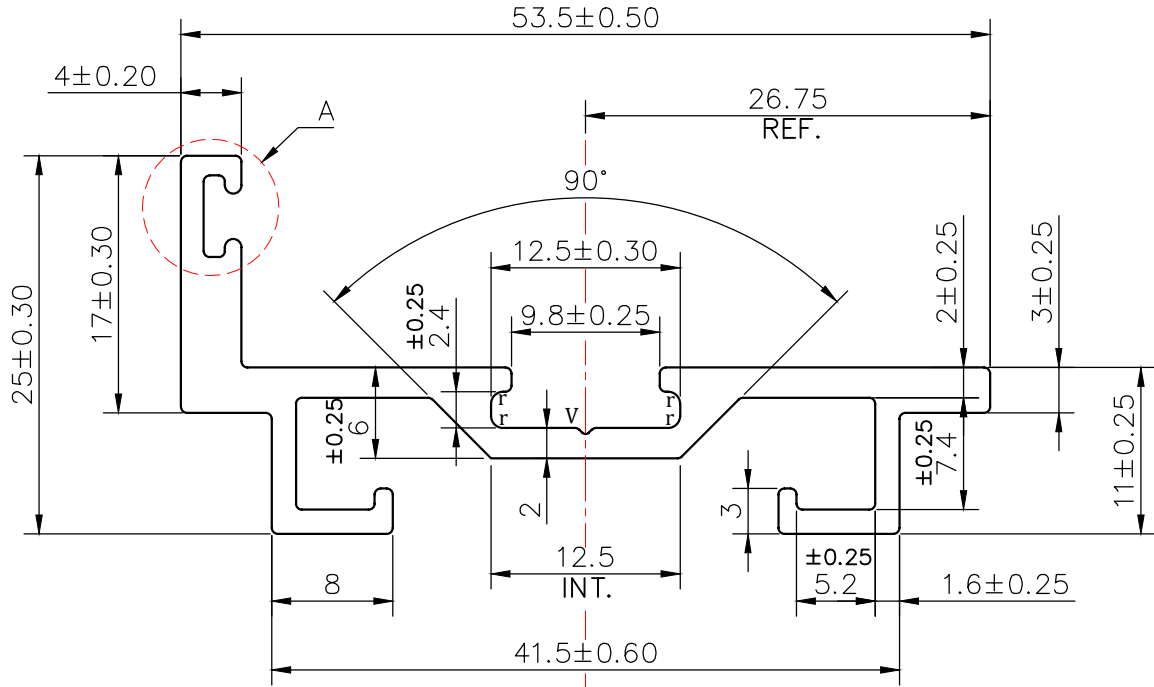

DETAIL-A  
SCALE 4:1

**NOTE:-****r= 0.80 RADIUS (4 PLACES)****F= FULL RADIUS (2 PLACES)****V= 0.4x90° V-GROOVE (1 PLACE)**

1. STRAIGHTNESS= 1.7mm/M
2. TWIST= 1.7mm/M
3. ANGULARITY=  $\pm 2^\circ$
4. FLATNESS= 0.007xWIDTH



SYMBOL OF QUALITY  
AN ISO 9001 COMPANY

**JINDAL ALUMINIUM LTD.**  
BHIWADI-301019 (INDIA)

	NAME	DATE
DRAWN	ASHUTOSH	14-07-2023
CHECKED		
APPROVED		

1. ALL DIMENSIONS ARE IN mm.
2. ROUND OFF ALL SHARP CORNERS WITH 0.40 mm.
3. TOLERANCES WILL BE AS PER BS:EN-755-9 , UNLESS OTHERWISE SPECIFIED

SCALE	2:1
AREA mm <sup>2</sup>	237.0
PERIMETER mm.	228.51
WEIGHT kg/m	0.640
DRAWING No.	SECTION No.
MAL-15737	
D6800	D6800

PARTY'S NAME	PERFECT SOLUTION
PARTY'S DRAWING No.	AS PER DRAWING
ALLOY & TEMPER	6063 T6
DESCRIPTION	MODULAR SECTION