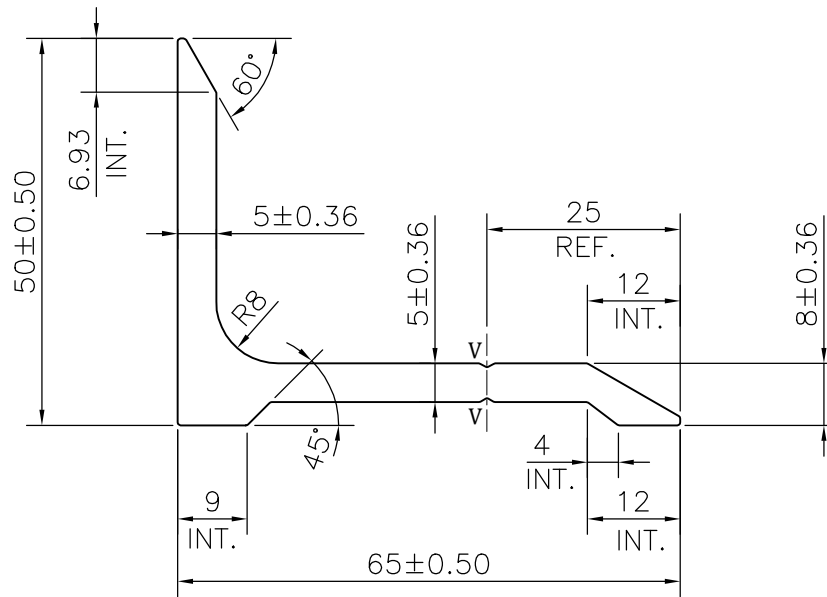

MAL NO. 15908

D6908

**NOTE:-****V= 0.50x120° V-GROOVE (2 PLACE)**

SYMBOL OF QUALITY
AN ISO 9001 COMPANY

JINDAL ALUMINIUM LTD.
BHIWADI-301019 (INDIA)

	NAME	DATE
DRAWN	AMIT	18-09-2023
CHECKED		
APPROVED		
SCALE		1:1
AREA mm ²		553.651
PERIMETER mm.		220.646
WEIGHT kg/m		1.495
DRAWING No.	SECTION No.	
MAL NO. 15908	-	
D6908	D6908	

1. ALL DIMENSIONS ARE IN mm.
2. ROUND OFF ALL SHARP CORNERS WITH 0.40 mm.
3. TOLERANCES WILL BE AS PER IS:3965-1981 , UNLESS OTHERWISE SPECIFIED

PARTY'S NAME	MAINI SCAFFOLDING	
PARTY'S DRAWING No.	AS PER DRAWING	
ALLOY & TEMPER	6061 T6	PRODUCT CODE:-029 HSN CODE:- 76042990
DESCRIPTION	STRUCTURAL MISC. SECTION	