

MAL NO.-16836

D7099

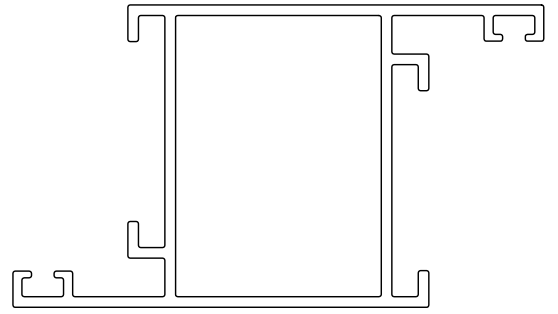

SCALE 1:1

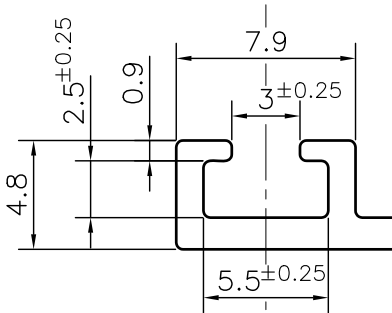
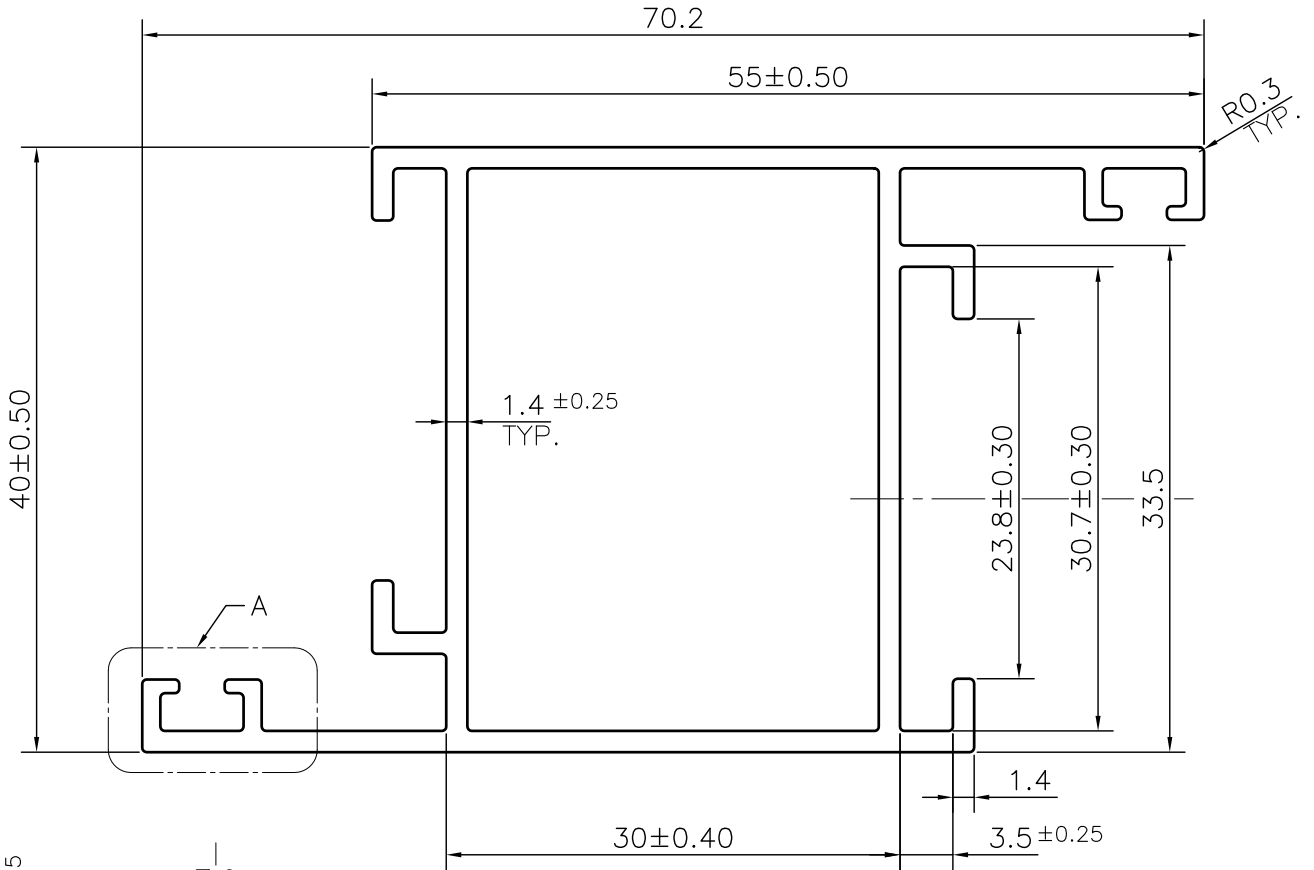

DETAIL A
SCALE 3:1

☞ ROUND OFF ALL SHARP CORNERS WITH 0.30 mm.

- 1. STRAIGHTNESS= 1.7mm/M
- 2. TWIST= 2.1mm/M
- 3. ANGULARITY= ±2°
- 4. FLATNESS= 0.008xWIDTH



SYMBOL OF QUALITY
AN ISO 9001 COMPANY

JINDAL ALUMINIUM LTD.
BHIWADI-301019 (INDIA)

	NAME	DATE
DRAWN	ASHUTOSH	20-04-2024
CHECKED		
APPROVED		
SCALE		2:1
AREA mm ²		312.02
PERIMETER mm.		318.219
WEIGHT kg/m		0.842
DRAWING No.	SECTION No.	
MAL NO.-16836	-	
D7099	D7099	

- 1. ALL DIMENSIONS ARE IN mm.
- 2. ROUND OFF ALL SHARP CORNERS WITH 0.30 mm.
- 3. TOLERANCES WILL BE AS PER IS: 6477-1983 , UNLESS OTHERWISE SPECIFIED

PARTY'S NAME	KOHLI ALUMINIUM	
PARTY'S DRAWING No.	AS PER DRAWING	
ALLOY & TEMPER	63400 WP	PRODUCT CODE:-048
		HSN CODE:- 76042100
DESCRIPTION	WINDOW SECTION	