

MAL NO-16480

D7202

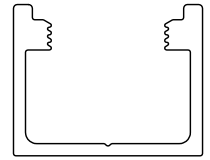
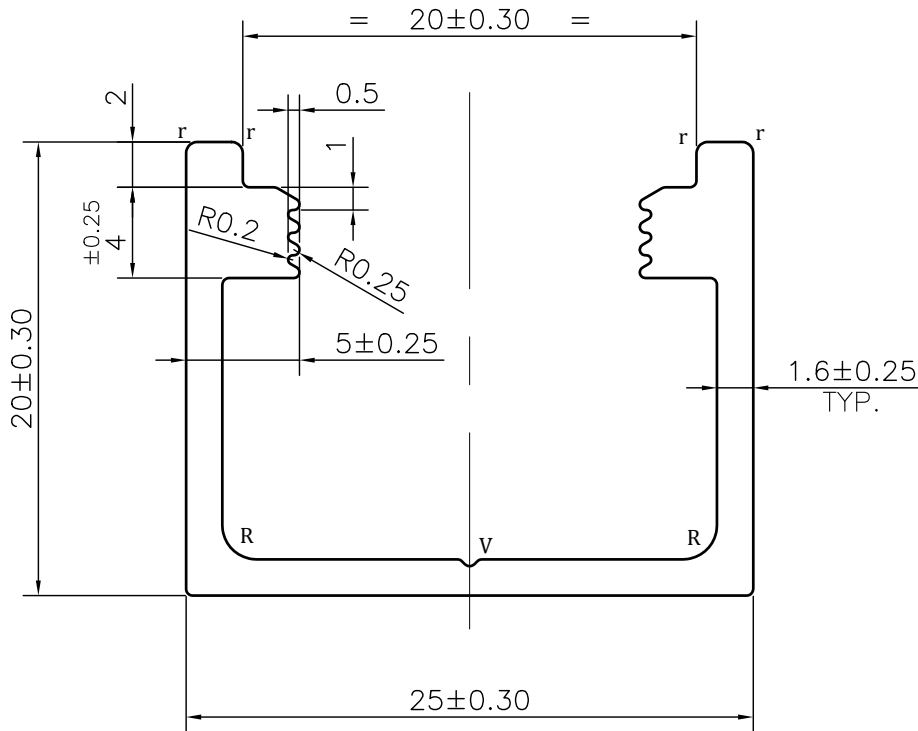

SCALE 1:1

**NOTE:-****r= 0.50 RADIUS (4 PLACES)****R= 1.50 RADIUS (2 PLACES)****V= 0.30x90° V-GROOVE (1 PLACE)**

1. STRAIGHTNESS= 1.7mm/M
2. TWIST= 1.7mm/M
3. ANGULARITY= $\pm 2^\circ$
4. FLATNESS= 0.007xWIDTH

 ROUND OFF ALL SHARP CORNERS WITH 0.30 mm.



SYMBOL OF QUALITY
AN ISO 9001 COMPANY

JINDAL ALUMINIUM LTD.
BHIWADI-301019 (INDIA)

	NAME	DATE
DRAWN	ASHUTOSH	19-10-2023
CHECKED		
APPROVED		
SCALE		3:1
AREA mm ²		128.222
PERIMETER mm.		139.8
WEIGHT kg/m		0.346
DRAWING No.	SECTION No.	
MAL NO-16480	-	
D7202	D7202	

1. ALL DIMENSIONS ARE IN mm.
2. ROUND OFF ALL SHARP CORNERS WITH 0.40 mm.
3. TOLERANCES WILL BE AS PER BS:EN-755-9 , UNLESS OTHERWISE SPECIFIED

PARTY'S NAME	PERFECT SOLUTIONS	
PARTY'S DRAWING No.	AS PER DRAWING	
ALLOY & TEMPER	6063 T6	PRODUCT CODE:-051
		HSN CODE:- 76042990
DESCRIPTION	MODULAR SECTION	