

MAL NO.-17183

D7227

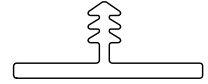
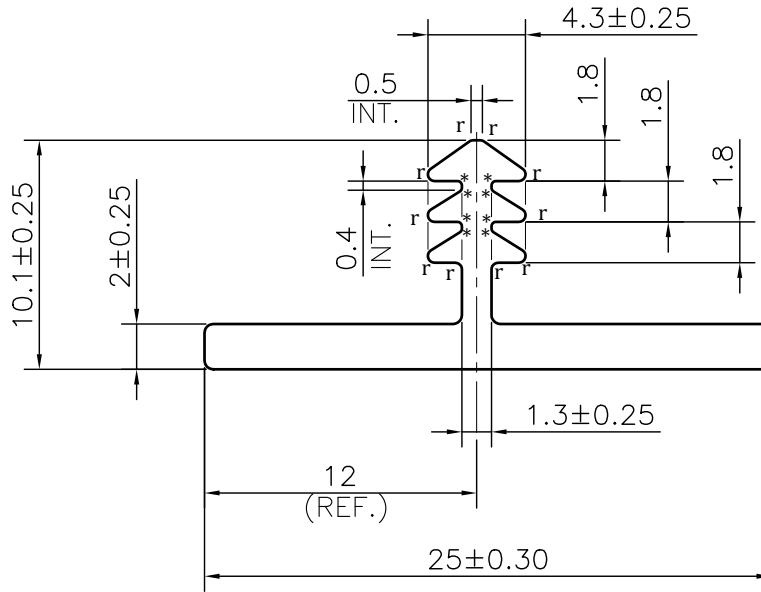

SCALE 1:1

**NOTE:-**

**\* = 0.20 RADIUS (8 PLACES)**  
**r = 0.30 RADIUS (10 PLACES)**

1. STRAIGHTNESS= 1.7mm/M
2. TWIST= 1.7mm/M
3. ANGULARITY=  $\pm 2^\circ$
4. FLATNESS= 0.007xWIDTH



SYMBOL OF QUALITY  
AN ISO 9001 COMPANY

**JINDAL ALUMINIUM LTD.**  
 BHIWADI-301019 (INDIA)

	NAME	DATE
DRAWN	ASHUTOSH	18-04-2024
CHECKED		
APPROVED		
SCALE		3:1
AREA mm <sup>2</sup>		68.843
PERIMETER mm.		81.04
WEIGHT kg/m		0.186
DRAWING No.		SECTION No.
MAL NO.-17183		-
D7227		D7227

1. ALL DIMENSIONS ARE IN mm.
2. ROUND OFF ALL SHARP CORNERS WITH 0.40 mm.
3. TOLERANCES WILL BE AS PER BS:EN-755-9 , UNLESS OTHERWISE SPECIFIED

PARTY'S NAME	SAPNA KITCHEN	
PARTY'S DRAWING No.	AS PER DRAWING	
ALLOY & TEMPER	6063 T6	PRODUCT CODE:-050 HSN CODE:- 76042990
DESCRIPTION	KITCHEN CABINET SECTION	