

MAL NO.-17654

D7378

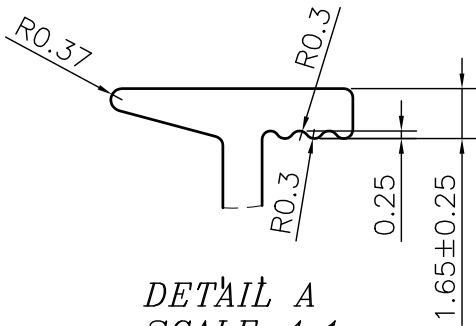

DETAIL A  
SCALE 4:1

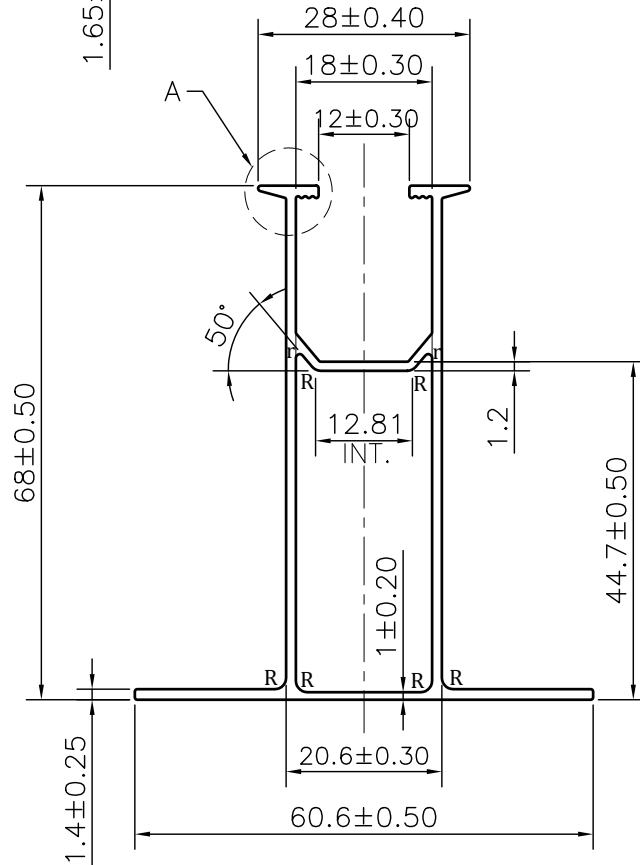

**NOTE:-**

**r= 0.50 RADIUS (2 PLACES)**

**R= 1.50 RADIUS (6 PLACES)**

☞ ROUND OFF ALL SHARP CORNERS WITH 0.30 mm.

1. STRAIGHTNESS= 1.7mm/M
2. TWIST= 1.7mm/M
3. ANGULARITY= ±2°
4. FLATNESS= 0.007xWIDTH



SYMBOL OF QUALITY  
AN ISO 9001 COMPANY

**JINDAL ALUMINIUM LTD.**  
BHIWADI-301019 (INDIA)

	NAME	DATE
DRAWN	ASHUTOSH	21-11-2023
CHECKED		
APPROVED		
SCALE		1:1
AREA mm <sup>2</sup>		296.276
PERIMETER mm.		322.955
WEIGHT kg/m		0.800
DRAWING No.	SECTION No.	
MAL NO.-17654	-	
D7378	D7378	

1. ALL DIMENSIONS ARE IN mm.
2. ROUND OFF ALL SHARP CORNERS WITH 0.40 mm.
3. TOLERANCES WILL BE AS PER BS:EN-755-9 , UNLESS OTHERWISE SPECIFIED

PARTY'S NAME	STROLAR MOUNTING	
PARTY'S DRAWING No.	AS PER DRAWING	
ALLOY & TEMPER	6063 T6	PRODUCT CODE:-080
		HSN CODE:- 76042100
DESCRIPTION	SOLAR SECTION	