

JAL-B-016

D-7516

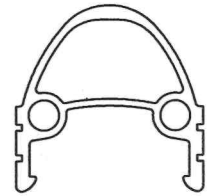

SCALE 1:1

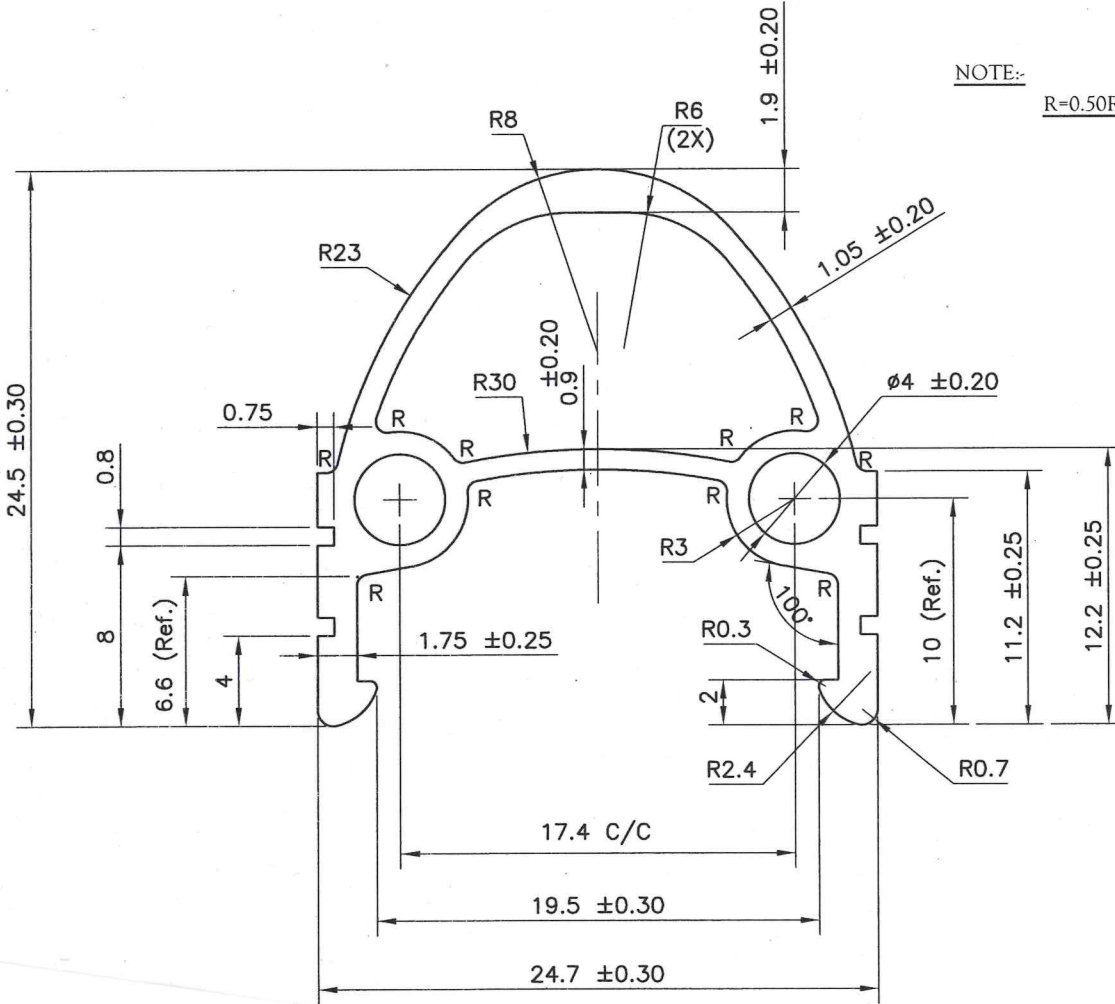

NOTE:-

R=0.50R

TWIST = $\pm 1/4^\circ / 300 \text{ M.M. / M.}$

FLATNESS = $\text{WIDTH} \times 0.005 \text{ mm.}$

STRAIGHTNESS = 1.5 M.M. / MTR.

ANGULARITY = $\pm 1.5^\circ$



SYMBOL OF QUALITY
AN ISO 9001 COMPANY

JINDAL ALUMINIUM LTD.
BANGALORE-560073 (INDIA)

1. ALL DIMENSIONS ARE IN mm.
2. ROUND OFF ALL SHARP CORNERS WITH 0.40 mm.
3. TOLERANCES WILL BE AS PER BS:EN-755-9 , UNLESS OTHERWISE SPECIFIED

	NAME	DATE
DRAWN	ASHUTOSH	10-06-2022
CHECKED	<i>Junal</i>	11.7.2022
APPROVED	<i>TRK</i>	11.07.22
SCALE		1:1&3:1
AREA mm ²		117.7
PERIMETER mm.		110.76
WEIGHT kg/m		0.318
DRAWING No.	SECTION No.	
JAL-B-016	D-7516	
-	-	

PARTY'S NAME	M/S. UNITED MARATHON
PARTY'S DRAWING No.	AS PER DRAWING-LDH-15/A
ALLOY & TEMPER	6063-T6
DESCRIPTION	--