

P-JAL-B-047-1

D-7531

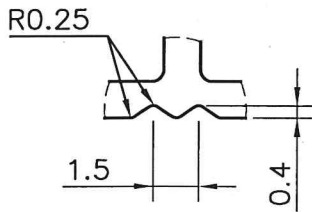

DETAIL A  
SCALE 4:1

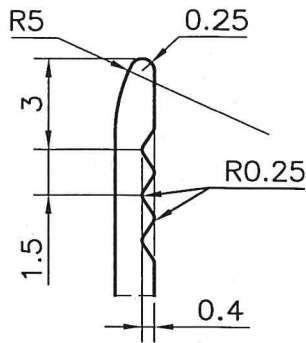

DETAIL B  
SCALE 4:1

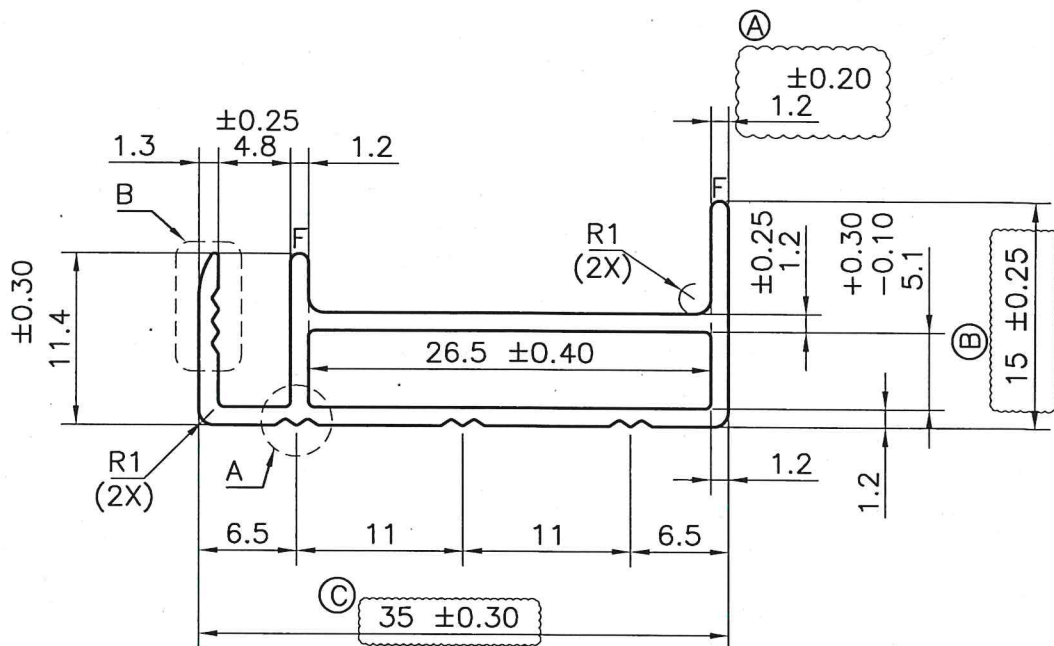
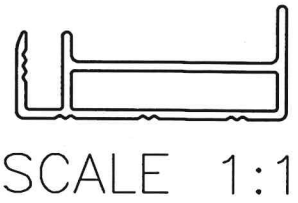

NOTE:-  
F= FULL RADIUS

NOTE:-

- (A) Dim.  $1.2 \pm 0.20$  was  $1.3 \pm 0.25$
- (B) Dim.  $15 \pm 0.25$  was  $15 \pm 0.30$
- (C) Dim.  $35 \pm 0.30$  was  $35 \pm 0.40$



SYMBOL OF QUALITY  
AN ISO 9001 COMPANY

**JINDAL ALUMINIUM LTD.**  
BHIWADI-301019 (INDIA)

	NAME	DATE
DRAWN	ASHUTOSH	08-11-2022
CHECKED	<i>Junal</i>	10-11-22
APPROVED	<i>Flow</i>	10-11-22
SCALE	1:1&2:1	
AREA mm <sup>2</sup>	112.19	
PERIMETER mm.	126.28	
WEIGHT kg/m	0.303	
DRAWING No.	SECTION No.	
P-JAL-B-047-1	D-7531	

1. ALL DIMENSIONS ARE IN mm.
2. ROUND OFF ALL SHARP CORNERS WITH 0.40 mm.
3. TOLERANCES WILL BE AS PER BS:EN-755-9 , UNLESS OTHERWISE SPECIFIED

PARTY'S NAME	M/s. GAUTAM SOLAR
PARTY'S DRAWING No.	AS PER MAIL (08.11.2022)
ALLOY & TEMPER	6063-T6
DESCRIPTION	--