

P-12300-1

E0076

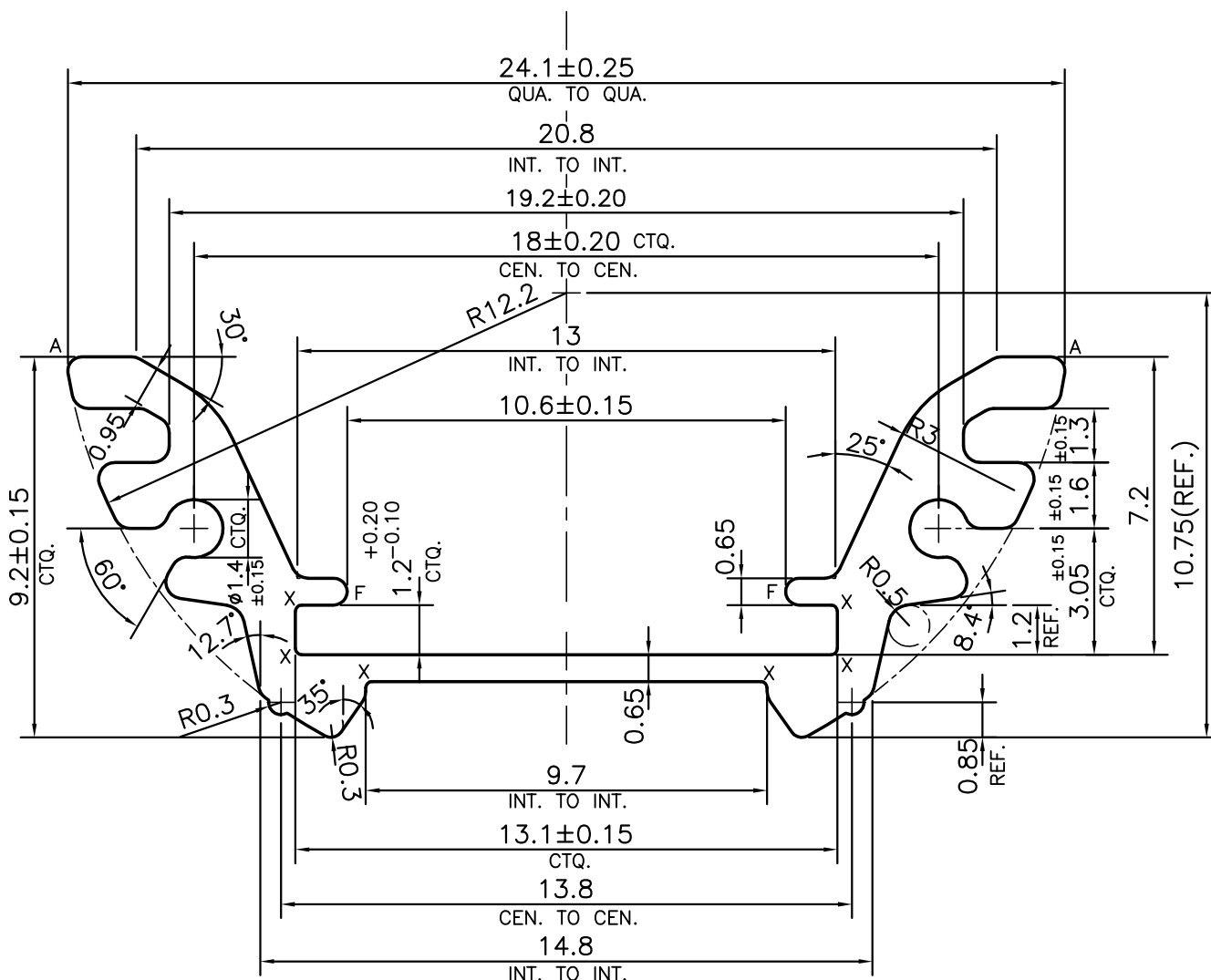

SCALE: - 1:1



- ☞ CTQ. = CRITICAL TO QUALITY AREA (6 PLACES)
- A = BLEND RADIUS (2 PLACES)
- F = FULL RADIUS (2 PLACES)
- X = RADIUS 0.15 mm. (6 PLACES)



SYMBOL OF QUALITY
AN ISO 9001 COMPANY

JINDAL ALUMINIUM LTD.
BANGALORE-560073 (INDIA)

	NAME	DATE
DRAWN	PARVESH	12-12-2012
CHECKED		
APPROVED	S.S.GARG	21-12-2012

1. ALL DIMENSIONS ARE IN mm.
2. ROUND OFF ALL SHARP CORNERS WITH 0.40 mm.
3. TOLERANCES WILL BE AS PER IS:3965-1981 , UNLESS OTHERWISE SPECIFIED

SCALE	6:1
AREA mm ²	48.637
PERIMETER mm.	88.459
WEIGHT kg/m	0.131

PARTY'S NAME	PHILIPS ELECTRONICS INDIA LTD., GURGAON
PARTY'S DRAWING No.	3241-3110-0721 & REQUIREMENT
ALLOY & TEMPER	6063
DESCRIPTION	HEAT SINK SECTION

DRAWING No.	SECTION No.
P-12300-1	-
E0076	E0076