

P-13202-1

E0125

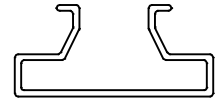

SCALE 1:1

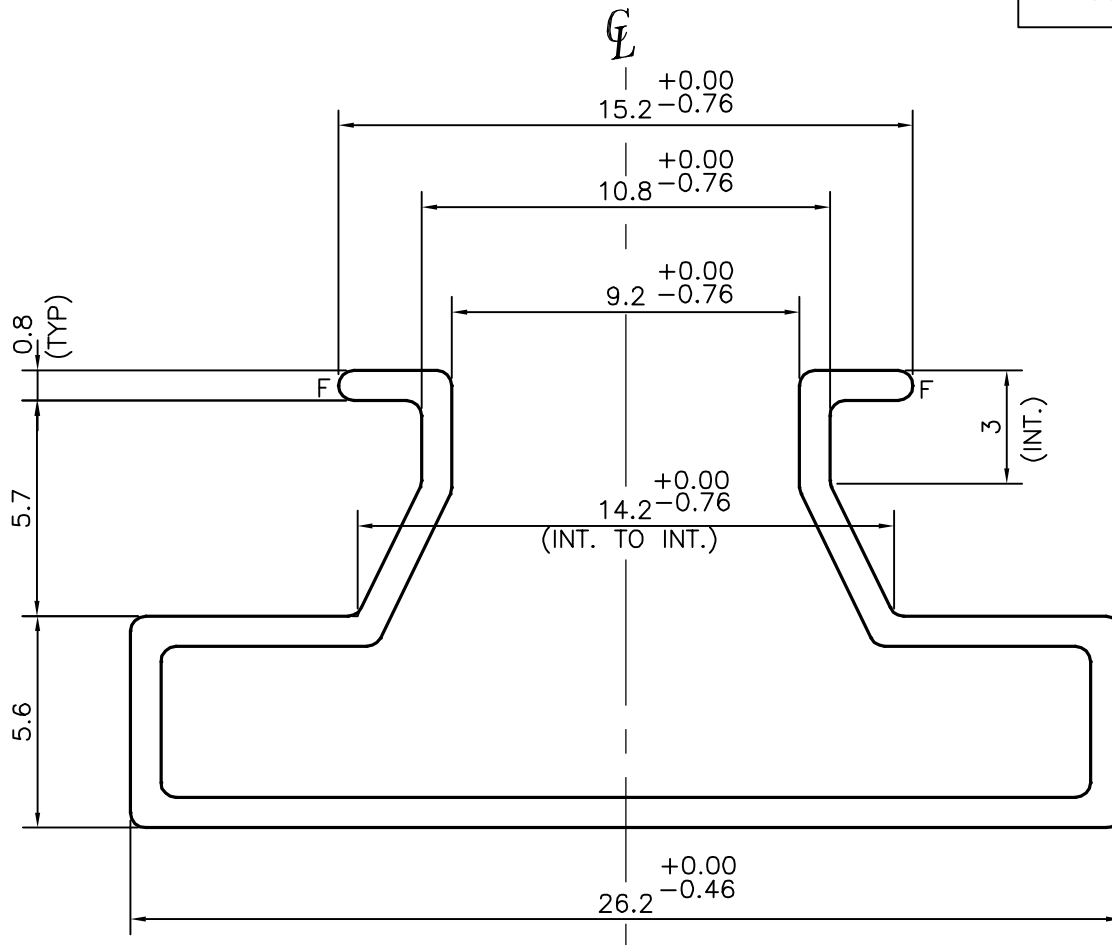

TOLERANCE ADDED ON DIMENSION 15.2 ^{+0.00}/_{-0.76}
 DIMENSION & TOLERANCE ADDED 9.2 ^{+0.00}/_{-0.76} (FOR MEASUREMENT)
 AS PER EMAIL DATED 12-02-2015

F = FULL RADIUS (2 PLACES)

TOLERANCES ON OVERALL WIDTHS & WIDTHS ACROSS FLATS OF BARS, & REGULAR SECTIONS

| | | | |
|---------------------|----------------------|----------------------|-----------------------|
| UPTO 6.40mm - ±0.20 | UPTO 32.0mm - ±0.38 | UPTO 120.0mm - ±0.85 | UPTO 320.00mm - ±1.70 |
| UPTO 10.0mm - ±0.23 | UPTO 50.0mm - ±0.46 | UPTO 160.0mm - ±1.02 | |
| UPTO 12.0mm - ±0.25 | UPTO 60.0mm - ±0.53 | UPTO 200.0mm - ±1.14 | |
| UPTO 16.0mm - ±0.28 | UPTO 80.0mm - ±0.69 | UPTO 250.0mm - ±1.40 | |
| UPTO 25.0mm - ±0.30 | UPTO 100.0mm - ±0.75 | UPTO 300.0mm - ±1.65 | |



SYMBOL OF QUALITY
AN ISO 9001 COMPANY

JINDAL ALUMINIUM LTD.
BANGALORE-560073 (INDIA)

| | | |
|----------|-----------|------------|
| | NAME | DATE |
| DRAWN | SRIVATHSA | 28-11-2013 |
| CHECKED | | |
| APPROVED | S.S.GARG | 04-12-2013 |

- ALL DIMENSIONS ARE IN mm.
- ROUND OFF ALL SHARP CORNERS WITH 0.40 mm.
- TOLERANCES WILL BE AS PER IS:3965-1981 , UNLESS OTHERWISE SPECIFIED

| | |
|----------------------|--------|
| SCALE | 5:1 |
| AREA mm ² | 52.464 |
| PERIMETER mm. | 130.13 |
| WEIGHT kg/m | 0.142 |

| | |
|---------------------|-------------------------------|
| PARTY'S NAME | SAFE ENTERPRISES, NAVI MUMBAI |
| PARTY'S DRAWING No. | AS PER SAMPLE & REQUIREMENT |
| ALLOY & TEMPER | HE9 WP |
| DESCRIPTION | FURNITURE SECTION |

| | |
|-------------|-------------|
| DRAWING No. | SECTION No. |
| P-13202-1 | - |
| E0125 | E0125 |
| | |
| | |