

206.2(QED. TO QED.)

204(QED. TO QED)

168(CEN. TO CEN.)

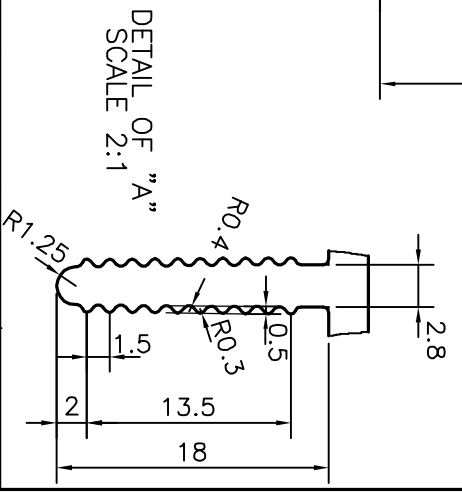
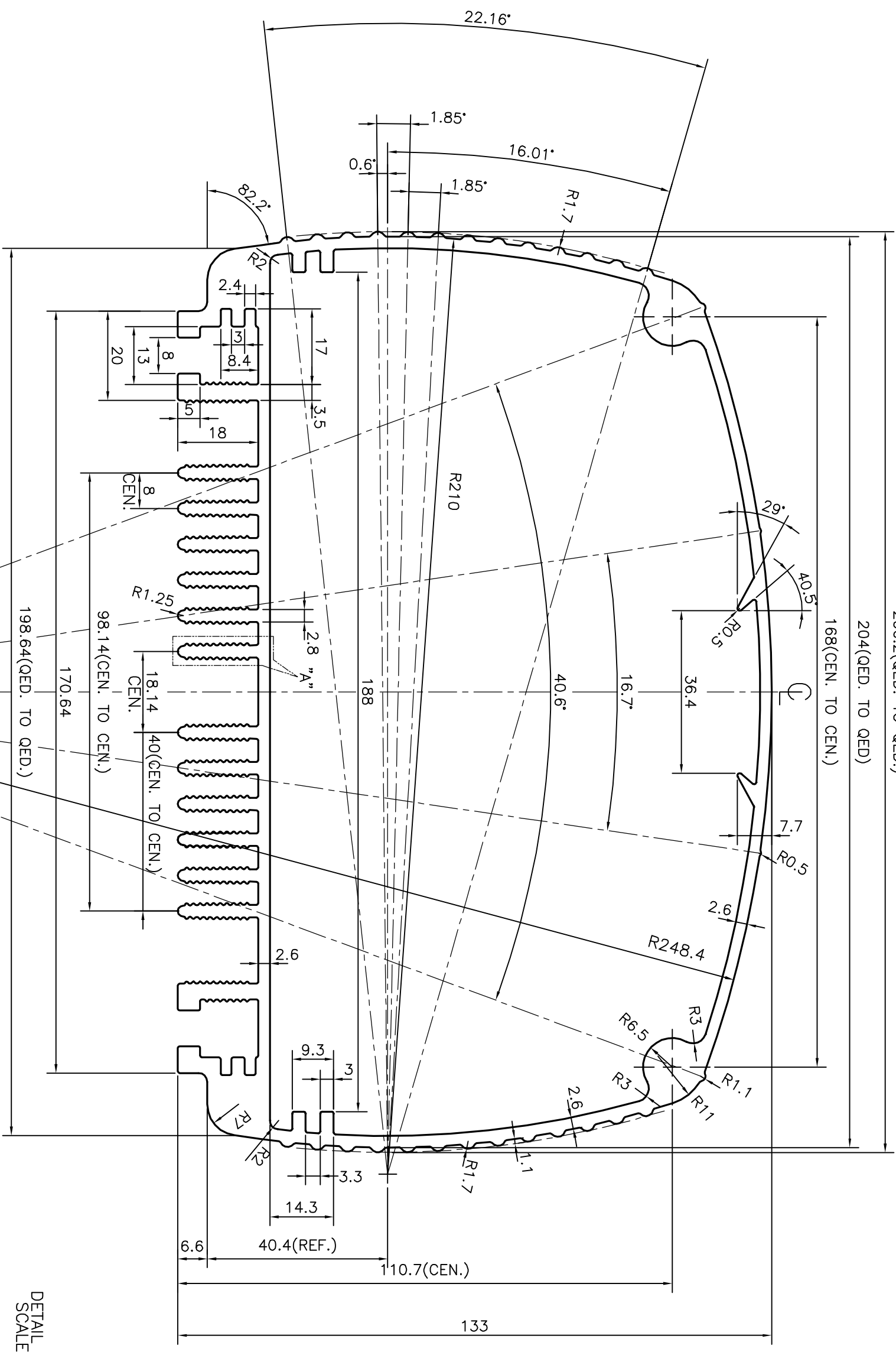

EXISTING		PROPOSED	
AREA	mm <sup>2</sup>	AREA	mm <sup>2</sup>
PERIMETER	mm.	PERIMETER	mm.
WEIGHT	kg/m	WEIGHT	kg/m
3015.758		3112.144	
1197.237		1303.184	
8.143		8.403	

<p><b>JINDAL ALUMINIUM LTD.</b> BANGALORE-560073 (INDIA)</p>		SYMBOL OF QUALITY AN ISO 9001 COMPANY
		<p>1. ALL DIMENSIONS ARE IN mm. 2. ROUND OFF ALL SHARP CORNERS WITH 0.40 mm. 3. TOLERANCES WILL BE AS PER IS:6477-1983 UNLESS OTHERWISE SPECIFIED</p>
PARTY'S NAME		ROTOMAG MOTORS & CONTROLS PVT. LTD., ANAND
PARTY'S DRAWING No.		SMP-6205.2 & AS PER AUTOCAD DRAWING
ALLOY & TEMPER		6063 T6
DESCRIPTION		MISC. SECTION
DRAWN	NAME	DATE
CHECKED	J.P. KAUSHIK	02-03-2016
APPROVED	S.S. GARG	11-03-2016
SCALE		1:1
AREA	mm <sup>2</sup>	3112.144
PERIMETER	mm.	1303.184
WEIGHT	kg/m	8.403
DRAWING No.	SECTION No.	
P-13886	-	
E0181	E0181(ISSUE-3)	