

Z = RADIUS 1 mm. (6 PLACES)
 F = FULL RADIUS (2 PLACES)
 - - - - - EXPOSED SURFACE

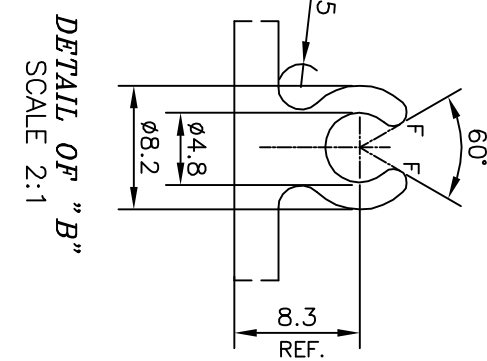
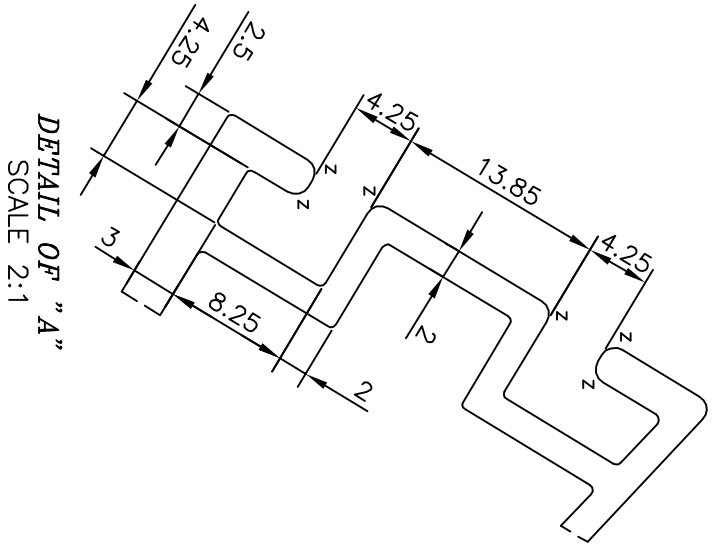

TOLERANCES ON OVERALL WIDTHS & WIDTHS ACROSS FLATS OF BARS, & REGULAR SECTIONS

UPTO 6.40mm - ±0.20	UPTO 32.0mm - ±0.38	UPTO 120.0mm - ±0.85	1. STRAIGHTNESS=1.7mm/M
UPTO 10.0mm - ±0.23	UPTO 50.0mm - ±0.46	UPTO 160.0mm - ±1.02	2. TWIST=1.7mm/M
UPTO 12.0mm - ±0.25	UPTO 60.0mm - ±0.53	UPTO 200.0mm - ±1.14	3. ANGULARITY= ±2°
UPTO 16.0mm - ±0.28	UPTO 80.0mm - ±0.69	UPTO 250.0mm - ±1.40	4. FLATNESS =0.007xWIDTH
UPTO 25.0mm - ±0.30	UPTO 100.0mm - ±0.75	UPTO 300.0mm - ±1.65	

<p>SYMBOL OF QUALITY AN ISO 9001 COMPANY</p>	<p>JINDAL ALUMINIUM LTD.</p> <p>BANGALORE-560073 (INDIA)</p>		DRAWN NAME	DATE
			PARVESH	11-12-2014
<p>1. ALL DIMENSIONS ARE IN mm. 2. ROUND OFF ALL SHARP CORNERS WITH 0.40 mm. 3. TOLERANCES WILL BE AS PER IS:6477-1983 , UNLESS OTHERWISE SPECIFIED</p>		APPROVED S.S.GARG	16-12-2014	
<p>PARTY'S NAME ALUFIT (INDIA) PRIVATE LIMITED, BANGALORE</p>		SCALE	1:1	
<p>PARTY'S DRAWING No. AS PER AUTOCAD DRAWING-GD-A1 & REQUIREMENT</p>		AREA mm ²	1629.479	
<p>ALLOY & TEMPER 6063 T6</p>		PERIMETER mm.	1074.907	
<p>DESCRIPTION CURTAIN WALL SECTION-NOSE PROFILE 90°</p>		WEIGHT kg/m	4.400	
		DRAWING No.	P-14235-1	
		SECTION No.	-	
			E0254	
			E0254	