

SCALE :- 0.5:1

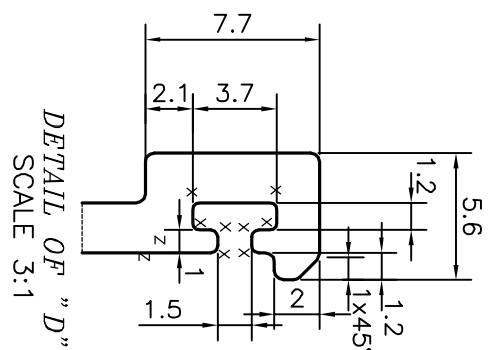

DETAIL OF "D"
SCALE 3:1

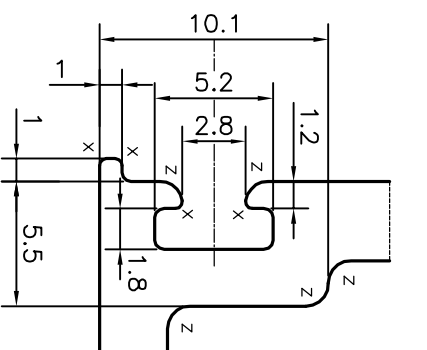

DETAIL OF "A"
SCALE 3:1

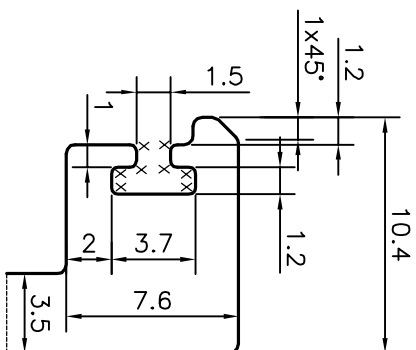

DETAIL OF "B"
SCALE 3:1

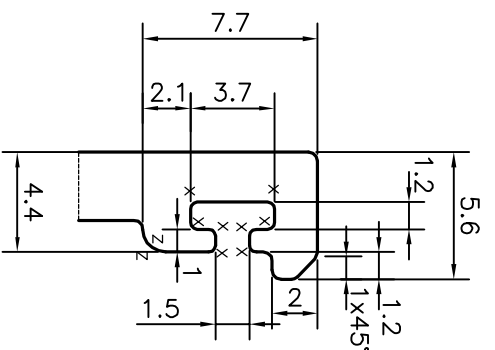

DETAIL OF "C"
SCALE 3:1

X = RADIUS 0.3 mm. (28 PLACES)
Z = RADIUS 1 mm. (7 PLACES)
V = VEE GROOVE 0.4x90° (3 PLACES)

TOLERANCES ON OVERALL WIDTHS & WIDTHS ACROSS FLATS OF BARS, & REGULAR SECTIONS

UPTO 6.40mm - ±0.20	UPTO 32.0mm - ±0.38	UPTO 120.0mm - ±0.85
UPTO 10.0mm - ±0.23	UPTO 50.0mm - ±0.46	UPTO 160.0mm - ±1.02
UPTO 12.0mm - ±0.25	UPTO 60.0mm - ±0.53	UPTO 200.0mm - ±1.14
UPTO 16.0mm - ±0.28	UPTO 80.0mm - ±0.69	UPTO 250.0mm - ±1.40
UPTO 25.0mm - ±0.30	UPTO 100.0mm - ±0.75	UPTO 300.0mm - ±1.65

<p>JINDAL ALUMINIUM LTD. BANGALORE-560073 (INDIA)</p>		<p>1. STRAIGHTNESS=1.7mm/M</p> <p>2. TWIST=1.7mm/M</p> <p>3. ANGULARITY= ±2°</p> <p>4. FLATNESS =0.007xWIDTH</p>
<p>SYMBOL OF QUALITY AN ISO 9001 COMPANY</p>		
<p>1. ALL DIMENSIONS ARE IN mm.</p> <p>2. ROUND OFF ALL SHARP CORNERS WITH 0.40 mm.</p> <p>3. TOLERANCES WILL BE AS PER IS:3965-1981 , UNLESS OTHERWISE SPECIFIED</p>		

PARTY'S NAME	ALUFIT (INDIA) PRIVATE LIMITED, BANGALORE	DRAWN	NAME	DATE
PARTY'S DRAWING No.	AS PER AUTOCAD DRAWING-AL-03	CHECKED	PARVESH	10-08-2015
ALLOY & TEMPER	6063 T6	APPROVED	S.S.GARG	12-08-2015
DESCRIPTION	CURTAIN WALL SECTION-FEMALE MULLION	SCALE		1:1
		AREA		1081.509
		PERIMETER		727.08
		WEIGHT kg/m		2.92
		DRAWING No.		SECTION No.
		P-14952-1		-
		E0357		E0357