

P-13165

X1705

E0403

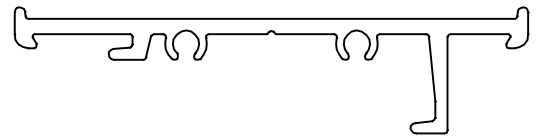
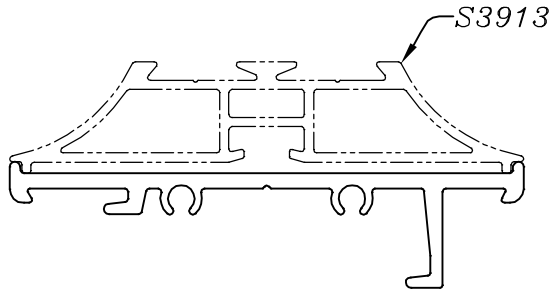

SCALE:- 1:1

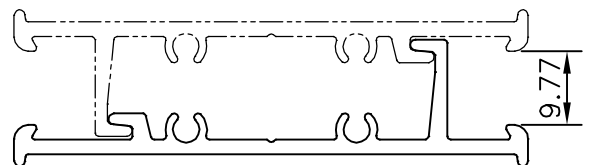
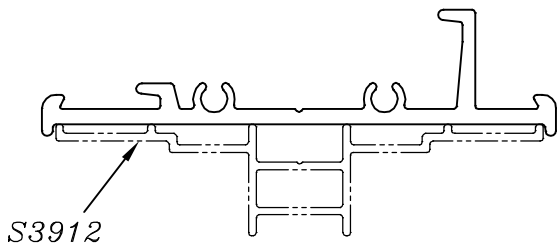
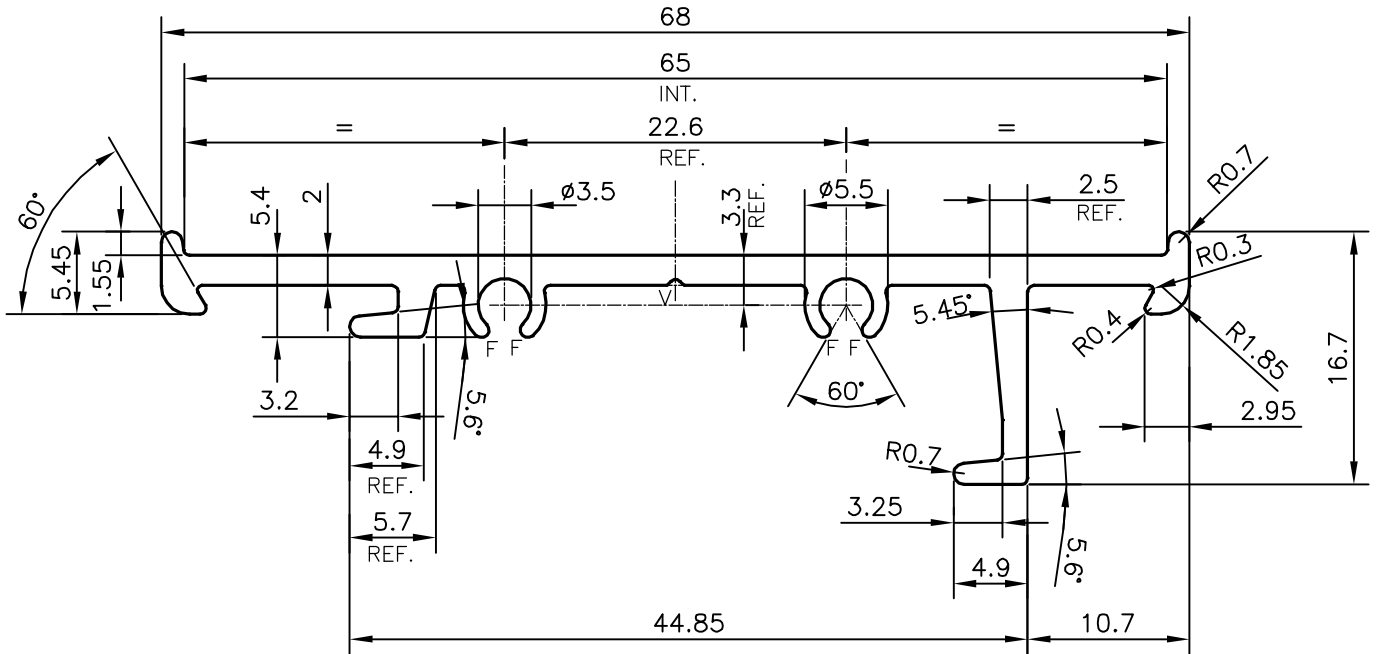

V = VEE GROOVE 0.4x90° (1 PLACE)
 F = FULL RADIUS (4 PLACE2)

TOLERANCES ON OVERALL WIDTHS & WIDTHS ACROSS FLATS OF BARS, & REGULAR SECTIONS

UPTO 6.40mm - ±0.20	UPTO 32.0mm - ±0.38	UPTO 120.0mm - ±0.85	1. STRAIGHTNESS=1.7mm/M 2. TWIST=1.7mm/M 3. ANGULARITY= ±2° 4. FLATNESS =0.007xWIDTH
UPTO 10.0mm - ±0.23	UPTO 50.0mm - ±0.46	UPTO 160.0mm - ±1.02	
UPTO 12.0mm - ±0.25	UPTO 60.0mm - ±0.53	UPTO 200.0mm - ±1.14	
UPTO 16.0mm - ±0.28	UPTO 80.0mm - ±0.69	UPTO 250.0mm - ±1.40	
UPTO 25.0mm - ±0.30	UPTO 100.0mm - ±0.75	UPTO 300.0mm - ±1.65	



SYMBOL OF QUALITY
AN ISO 9001 COMPANY

JINDAL ALUMINIUM LTD.
 BANGALORE-560073 (INDIA)

	NAME	DATE
DRAWN	PARVESH	04-11-2013
CHECKED		
APPROVED	S.S.GARG	07-11-2013
SCALE		2:1
AREA mm ²		203.849
PERIMETER mm.		219.588
WEIGHT kg/m		0.550
DRAWING No.	SECTION No.	
P-13165	-	
X1705	X1705	
E0403	E0403	

- ALL DIMENSIONS ARE IN mm.
- ROUND OFF ALL SHARP CORNERS WITH 0.40 mm.
- TOLERANCES WILL BE AS PER IS:3965-1981, UNLESS OTHERWISE SPECIFIED

PARTY'S NAME	SAIKA INTERIOR PVT. LTD., COIMBATORE
PARTY'S DRAWING No.	AS PER AUTOCAD DRAWING-SAIKA/CONNECTOR70/007
ALLOY & TEMPER	HE9 WP
DESCRIPTION	FURNITURE SECTION