

P-15389

E0419

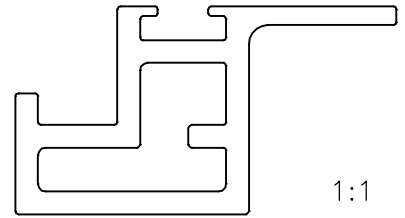

1:1

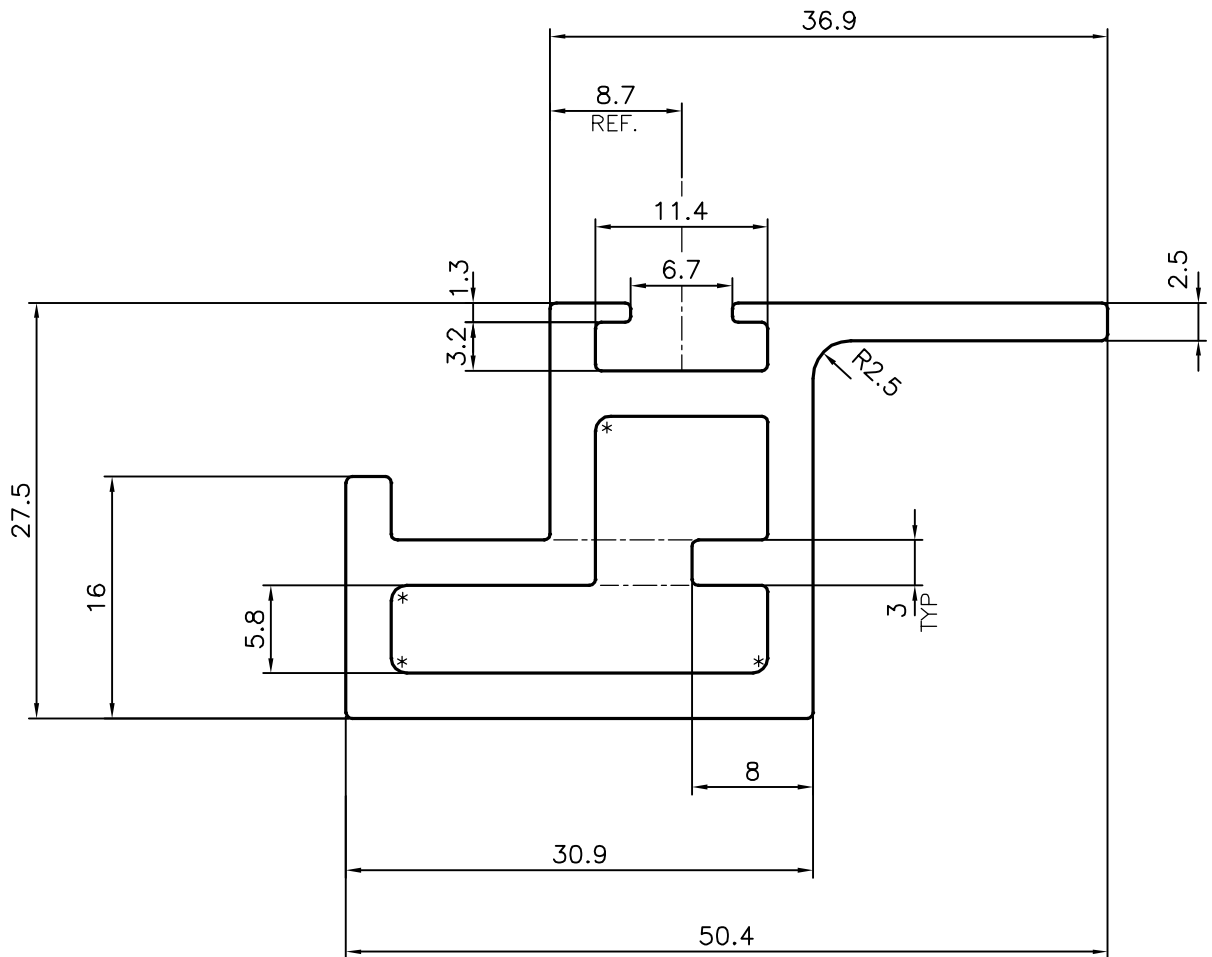

* =1.0 RADIUS (4 PLACES)



SYMBOL OF QUALITY
AN ISO 9001 COMPANY

JINDAL ALUMINIUM LTD.
BANGALORE-560073 (INDIA)

	NAME	DATE
DRAWN	J.P.KAUSHIK	03-12-2015
CHECKED		
APPROVED	S.S.GARG	25-12-2015
SCALE		2:1
AREA mm ²		398.888
PERIMETER mm.		178.608
WEIGHT kg/m		1.077
DRAWING No.	SECTION No.	
P-15389	-	
E0419	E0419	

1. ALL DIMENSIONS ARE IN mm.
2. ROUND OFF ALL SHARP CORNERS WITH 0.40 mm.
3. TOLERANCES WILL BE AS PER IS:6477-1983 , UNLESS OTHERWISE SPECIFIED

PARTY'S NAME	ALUFIT (INDIA) PRIVATE LIMITED, BANGALORE
PARTY'S DRAWING No.	SKL-1
ALLOY & TEMPER	6063 T6
DESCRIPTION	GLAZING FRAME SECTION