

P-13103

X1701

21671

E0492

EXPOSED SURFACE

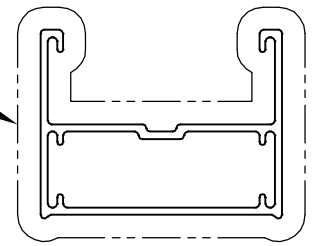

SCALE: - 1:1

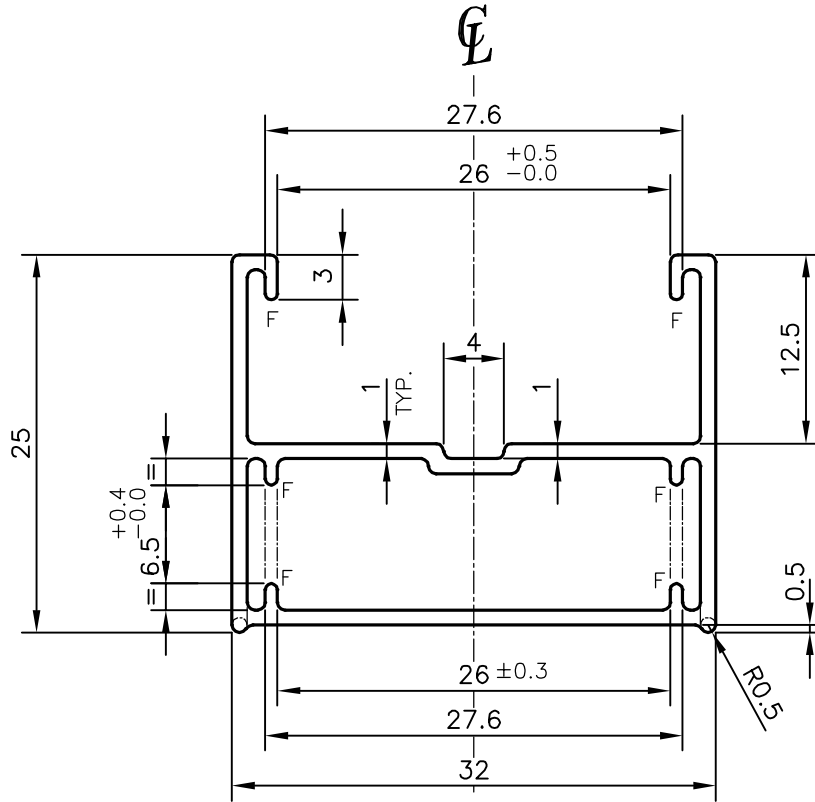

SECTION SHOULD MATCH WITH PLASTIC COMPONENT

F = FULL RADIUS (6 PLACES)

1. STRAIGHTNESS=1.7mm/M
2. TWIST=1.7mm/M
3. ANGULARITY= ±2°
4. FLATNESS =0.007xWIDTH

TOLERANCE CHART CD = CIRCUMSCRIBING CIRCLE

DIMENSION	CD≤100	100<CD≤200	200<CD≤300	300<CD≤500
UPTO 10mm	±0.25	±0.30	±0.35	±0.40
10.0 -25.0	±0.30	±0.40	±0.50	±0.60
25.0 -50.0	±0.50	±0.60	±0.80	±0.90
50.0 -100	±0.70	±0.90	±1.10	±1.30
100 - 150	-	±1.10	±1.30	±1.50
150 - 200	-	±1.3	±1.50	±1.80
200 - 300	-	-	±1.70	±2.10
300 - 450	-	-	-	±2.80



SYMBOL OF QUALITY AN ISO 9001 COMPANY

JINDAL ALUMINIUM LTD.
BANGALORE-560073 (INDIA)

	NAME	DATE
DRAWN	PARVESH	18-10-2013
CHECKED		
APPROVED	S.S.GARG	07-11-2013

1. ALL DIMENSIONS ARE IN mm.
2. ROUND OFF ALL SHARP CORNERS WITH 0.50 mm.
3. TOLERANCES WILL BE AS PER BS:EN-755-9 , UNLESS OTHERWISE SPECIFIED

SCALE	2:1
AREA mm ²	124.965
PERIMETER mm.	153.242
WEIGHT kg/m	0.337

PARTY'S NAME AWESOME DESIGNS, NEW DELHI

PARTY'S DRAWING No. 0005

ALLOY & TEMPER HE9 WP

DESCRIPTION WINDOW SECTION-B2 BOTTOM RAIL

DRAWING No.	SECTION No.
P-13103	-
X1701	X1701
21671	21671
E0492	E0492