

P-16219-1

E0533

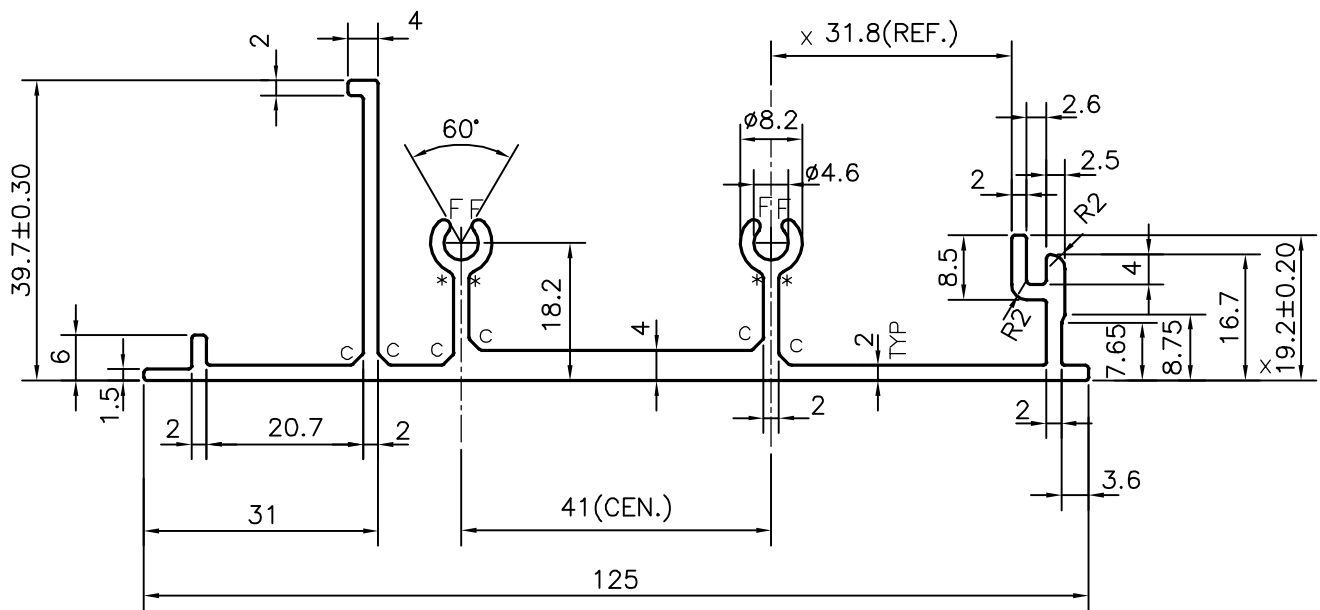
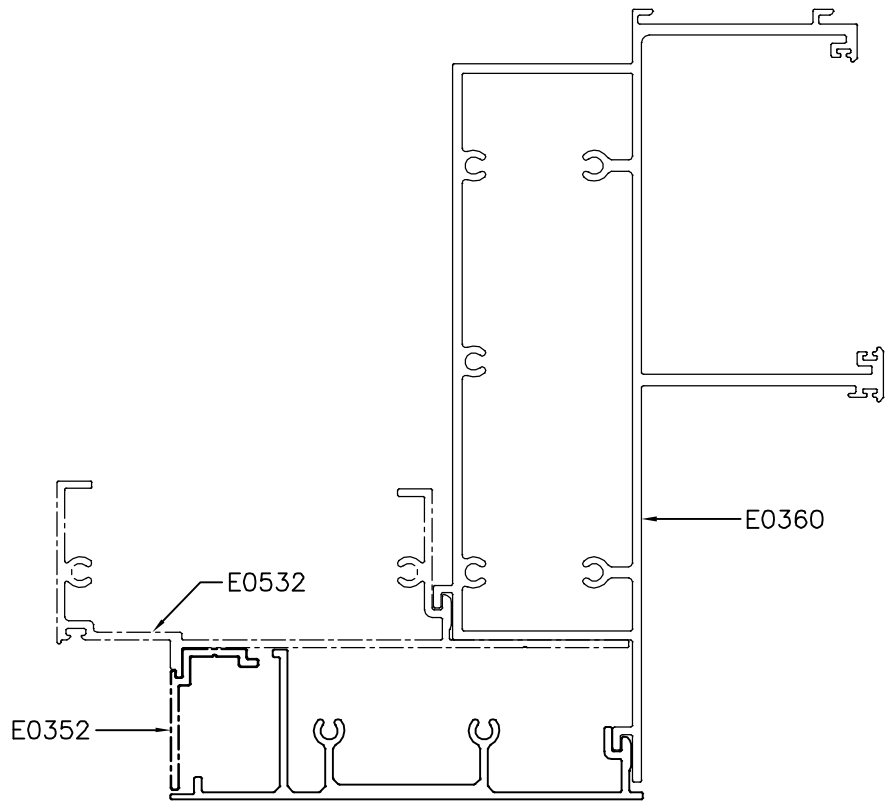

1. STRAIGHTNESS=1.0mm/M
2. TWIST=1.0mm/M
3. ANGULARITY= ±1°
4. FLATNESS =0.006xWIDTH

- c = CHAMFER 1.5x45°(6 PLACES)
 x = MARKED CRITICAL DIMENSION
 * = 1.0 RADIUS (4 PLACES)
 F = FULL RADIUS (4 PLACES)



SYMBOL OF QUALITY
AN ISO 9001 COMPANY

JINDAL ALUMINIUM LTD.
BANGALORE-560073 (INDIA)

	NAME	DATE
DRAWN	J.P.KAUSHIK	19-08-2016
CHECKED		
APPROVED	S.S. GARG	17-09-2016
SCALE		1:1
AREA mm ²		580.806
PERIMETER mm.		489.974
WEIGHT kg/m		1.568
DRAWING No.	SECTION No.	
P-16219-1	-	
E0533	E0533	

1. ALL DIMENSIONS ARE IN mm.
2. ROUND OFF ALL SHARP CORNERS WITH 0.40 mm.
3. TOLERANCES WILL BE AS PER IS:3965-1981 , UNLESS OTHERWISE SPECIFIED

PARTY'S NAME	ALUFIT (INDIA) PRIVATE LIMITED, BANGALORE
PARTY'S DRAWING No.	AL-08A
ALLOY & TEMPER	6063 T6
DESCRIPTION	CURTAIN WALL SECTION