

DETAIL OF "A"
SCALE 3:1

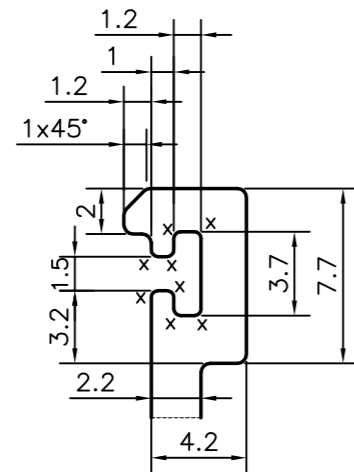

DETAIL OF "B"
SCALE 3:1

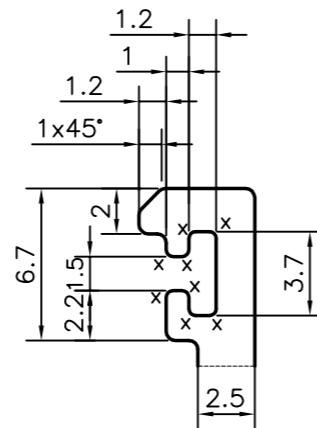

DETAIL OF "D"
SCALE 3:1

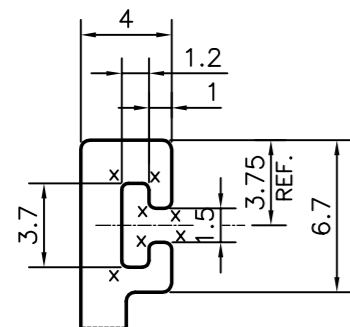

DETAIL OF "C"
SCALE 3:1

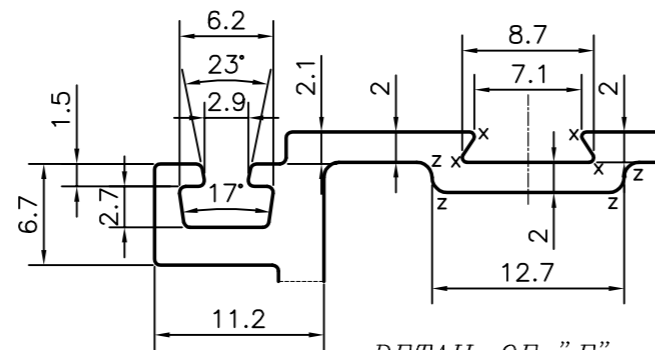

DETAIL OF "E"
SCALE 2:1

V = VEE GROOVE 0.3x90° (3 PLACES)
 X = RADIUS 0.3 mm. (36 PLACES)
 Z = RADIUS 1 mm. (8 PLACES)
 Y = RADIUS 1.5 mm. (4 PLACES)

UNSPECIFIED CORNERS RADIUS WILL BE 0.40 mm.

TOLERANCES ON OVERALL WIDTHS & WIDTHS ACROSS FLATS OF BARS, & REGULAR SECTIONS

| | | |
|---------------------|----------------------|----------------------|
| UPTO 6.40mm - ±0.20 | UPTO 32.0mm - ±0.38 | UPTO 120.0mm - ±0.85 |
| UPTO 10.0mm - ±0.23 | UPTO 50.0mm - ±0.46 | UPTO 160.0mm - ±1.02 |
| UPTO 12.0mm - ±0.25 | UPTO 60.0mm - ±0.53 | UPTO 200.0mm - ±1.14 |
| UPTO 16.0mm - ±0.28 | UPTO 80.0mm - ±0.69 | UPTO 250.0mm - ±1.40 |
| UPTO 25.0mm - ±0.30 | UPTO 100.0mm - ±0.75 | UPTO 300.0mm - ±1.65 |

1. STRAIGHTNESS=1.0mm/M
2. TWIST=1.0mm/M
3. ANGULARITY= ±1°
4. FLATNESS =0.007xWIDTH

| | | | | |
|---|--|-----------|----------------------|-------------|
| SYMBOL OF QUALITY AN ISO 9001 COMPANY | JINDAL ALUMINIUM LTD. BANGALORE-560073 (INDIA) | | NAME | DATE |
| | DRAWN | PARVESH | 07-01-2017 | |
| | CHECKED | | | |
| | APPROVED | B.NATARJA | 12-01-2017 | |
| 1. ALL DIMENSIONS ARE IN mm. 2. ROUND OFF ALL SHARP CORNERS WITH 0.50 mm. 3. TOLERANCES WILL BE AS PER IS:3965-1981, UNLESS OTHERWISE SPECIFIED | | | SCALE | 1:1 |
| | | | AREA mm ² | 863.905 |
| | | | PERIMETER mm. | 678.272 |
| | | | WEIGHT kg/m | 2.333 |
| PARTY'S NAME | ALUFIT (INDIA) PRIVATE LIMITED, BANGALORE | | DRAWING No. | SECTION No. |
| PARTY'S DRAWING No. | AS PER AUTOCAD DRAWING-AL-OR-18 | | P-16693-1 | - |
| ALLOY & TEMPER | 6063 T6 | | E0589 | E0589 |
| DESCRIPTION | CURTAIN WALL SECTION-FEMALE MULLION-2 | | | |