

P-16954

E0632

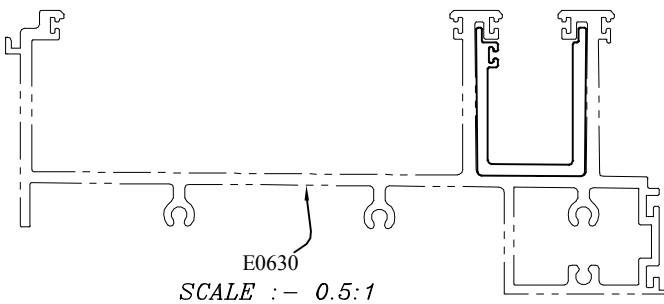

Z = RADIUS 1 mm. (4 PLACES)
 X = RADIUS 0.3 mm. (8 PLACES)

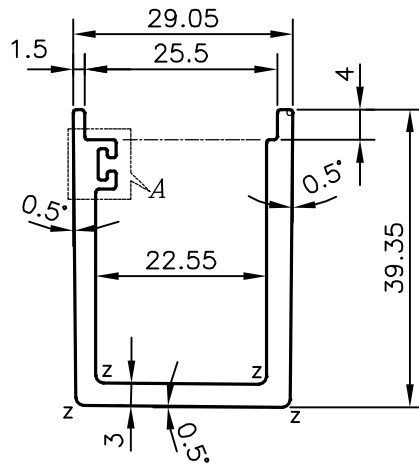
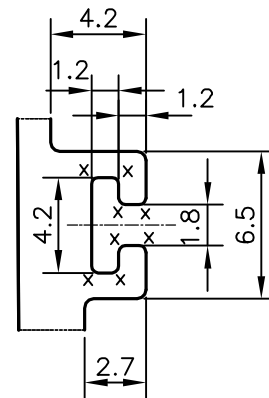

DETAIL OF "A"
 SCALE 3:1

1. STRAIGHTNESS=1.0mm/M
2. TWIST=1.0mm/M
3. ANGULARITY= ±1°
4. FLATNESS =0.007xWIDTH



SYMBOL OF QUALITY
 AN ISO 9001 COMPANY

JINDAL ALUMINIUM LTD.
 BANGALORE-560073 (INDIA)

	NAME	DATE
DRAWN	PARVESH	01-04-2017
CHECKED		
APPROVED	B.NATARAJA	08-04-2017
SCALE		1:1
AREA mm ²		307.99
PERIMETER mm.		218.915
WEIGHT kg/m		0.832
DRAWING No.	SECTION No.	
P-16954	-	
E0632	E0632	

1. ALL DIMENSIONS ARE IN mm.
2. ROUND OFF ALL SHARP CORNERS WITH 0.40 mm.
3. TOLERANCES WILL BE AS PER IS:3965-1981 , UNLESS OTHERWISE SPECIFIED

PARTY'S NAME	ALUFIT (INDIA) PRIVATE LIMITED, BANGALORE
PARTY'S DRAWING No.	AS PER AUTOCAD DRAWING-(ICC)-AL-15
ALLOY & TEMPER	6063 T6
DESCRIPTION	CURTAIN WALL SECTION-GUTTER PROFILE-02