

P-17184-1

E0702

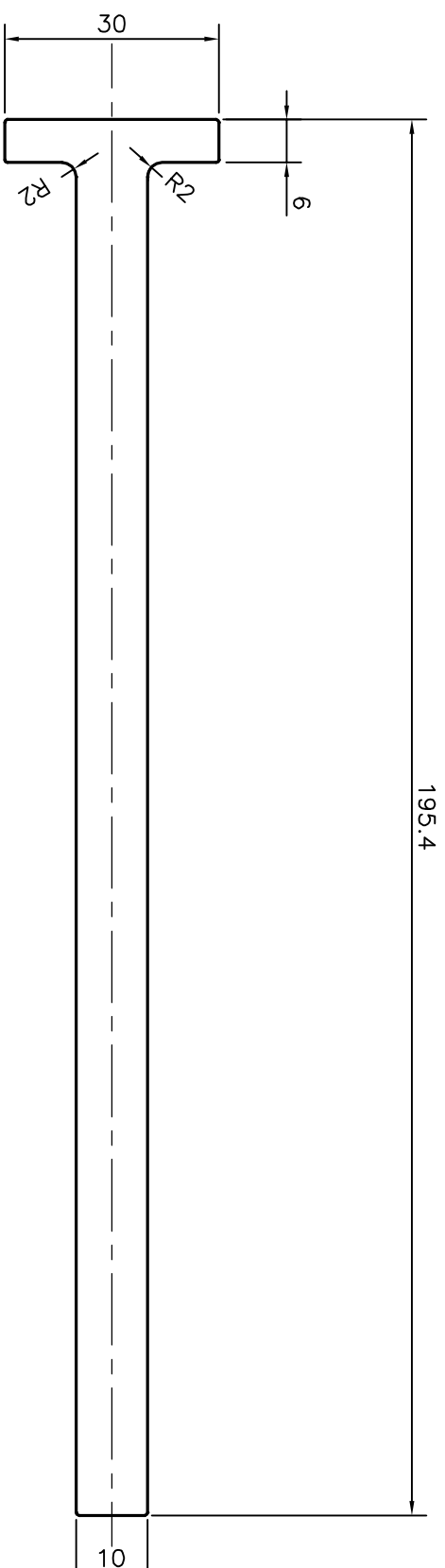

TOLERANCES ON OVERALL WIDTHS & WIDTHS ACROSS FLATS OF BARS, & REGULAR SECTIONS

UPTO 6.40mm - ±0.20	UPTO 32.0mm - ±0.38	UPTO 120.0mm - ±0.85
UPTO 10.0mm - ±0.23	UPTO 50.0mm - ±0.46	UPTO 160.0mm - ±1.02
UPTO 12.0mm - ±0.25	UPTO 60.0mm - ±0.53	UPTO 200.0mm - ±1.14
UPTO 16.0mm - ±0.28	UPTO 80.0mm - ±0.69	UPTO 250.0mm - ±1.40
UPTO 25.0mm - ±0.30	UPTO 100.0mm - ±0.75	UPTO 300.0mm - ±1.65



SYMBOL OF QUALITY
AN ISO 9001 COMPANY

JINDAL ALUMINIUM LTD.
BANGALORE-560073 (INDIA)

1. ALL DIMENSIONS ARE IN mm.
2. ROUND OFF ALL SHARP CORNERS WITH 0.40 mm.
3. TOLERANCES WILL BE AS PER IS:3965-1981 , UNLESS OTHERWISE SPECIFIED

PARTY'S NAME	ALUFIT (INDIA) PRIVATE LIMITED, BANGALORE	SCALE	1:1
PARTY'S DRAWING No.	AS PER AUTOCAD DRAWING-CR-09	AREA mm ²	2075.511
ALLOY & TEMPER	6005 T5	PERIMETER mm.	448.053
DESCRIPTION	FIN BRACKET-2	WEIGHT kg/m	5.604
		DRAWING No.	SECTION No.
		P-17184-1	-
		E0702	E0702

DRAWN NAME DATE

J.P.KAUSHIK 05-06-2017

CHECKED

APPROVED B.MATARAJA 24-06-2017

SCALE

AREA mm²

PERIMETER mm.

WEIGHT kg/m

DRAWING No.

SECTION No.

P-17184-1

E0702