

P-17230

E0735

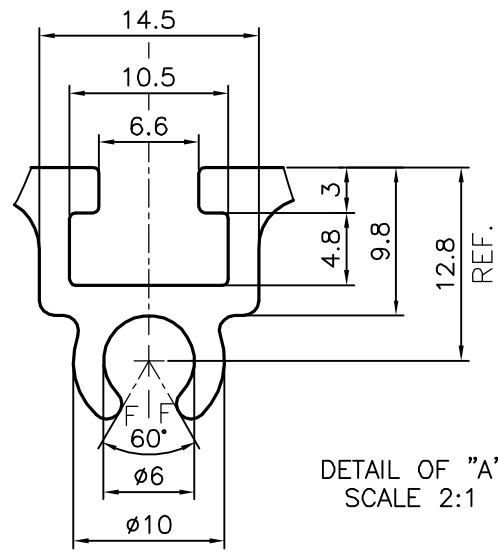

DETAIL OF "A"  
SCALE 2:1

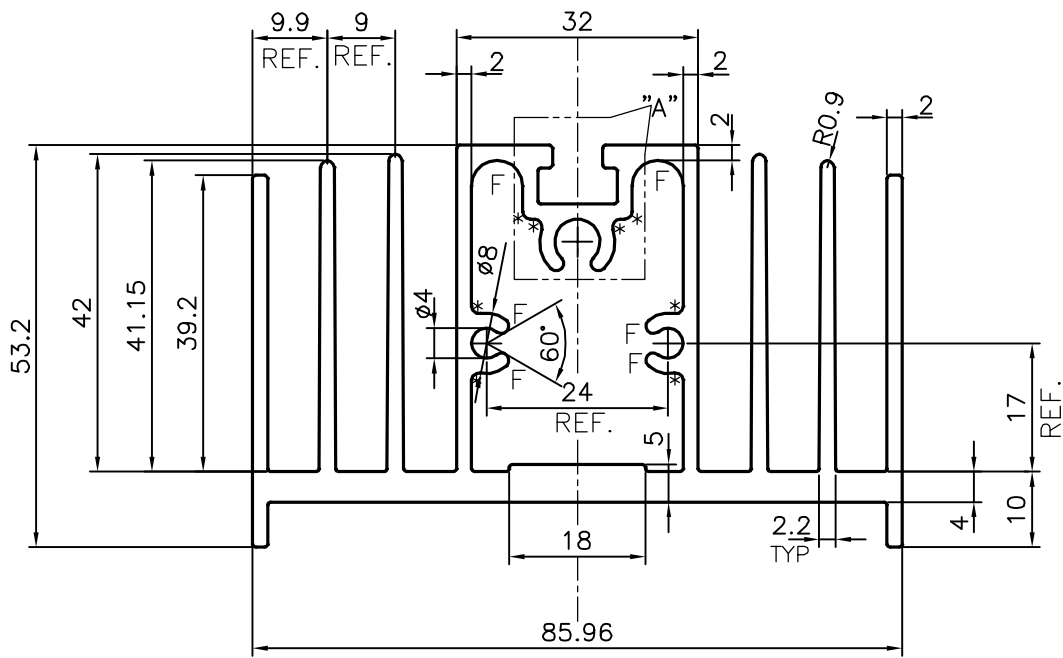

\* = 1.0 RADIUS (8 PLACES)  
F = FULL RADIUS (8 PLACES)

TOLERANCES ON OVERALL DIMENSIONS OF HOLLOW SECTIONS

UPTO 20.0mm - ±0.30	UPTO 80.0mm - ±0.70	UPTO 180.0mm - ±1.27	1. STRAIGHTNESS=1.7mm/M 2. TWIST=1.7mm/M 3. ANGULARITY= ±2° 4. FLATNESS =0.006xWIDTH
UPTO 30.0mm - ±0.38	UPTO 100.0mm - ±0.80	UPTO 200.0mm - ±1.40	
UPTO 40.0mm - ±0.45	UPTO 120.0mm - ±0.90	UPTO 225.0mm - ±1.52	
UPTO 50.0mm - ±0.52	UPTO 140.0mm - ±1.00		
UPTO 60.0mm - ±0.60	UPTO 160.0mm - ±1.14		



SYMBOL OF QUALITY  
AN ISO 9001 COMPANY

**JINDAL ALUMINIUM LTD.**  
BANGALORE-560073 (INDIA)

	NAME	DATE
DRAWN	J.P.KAUSHIK	01-07-2017
CHECKED		
APPROVED	B.NATARAJA	12-07-2017
SCALE		1:1
AREA mm <sup>2</sup>		1228.299
PERIMETER mm.		792.956
WEIGHT kg/m		3.316
DRAWING No.	SECTION No.	
P-17230	-	
E0735	E0735	

- ALL DIMENSIONS ARE IN mm.
- ROUND OFF ALL SHARP CORNERS WITH 0.40 mm.
- TOLERANCES WILL BE AS PER IS:6477-1983, UNLESS OTHERWISE SPECIFIED

PARTY'S NAME: LEO CIRCUIT BOARDS PVT. LTD., MUMBAI

PARTY'S DRAWING No.: AS PER DRAWING

ALLOY & TEMPER: HE9 WP

DESCRIPTION: HEAT SINK SECTION