

P-17631-1

E0765

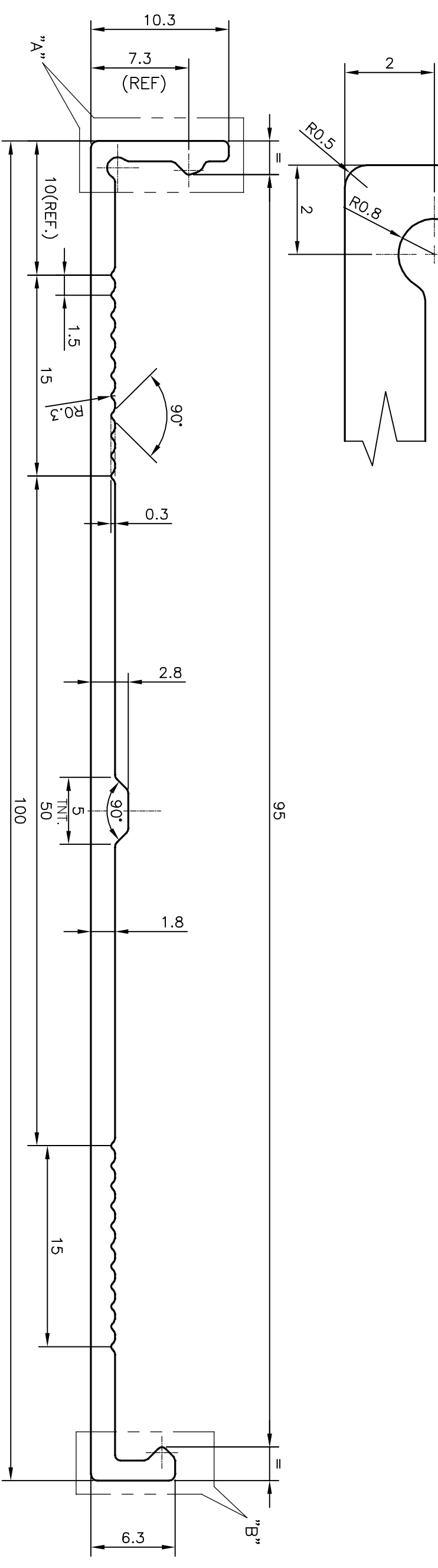
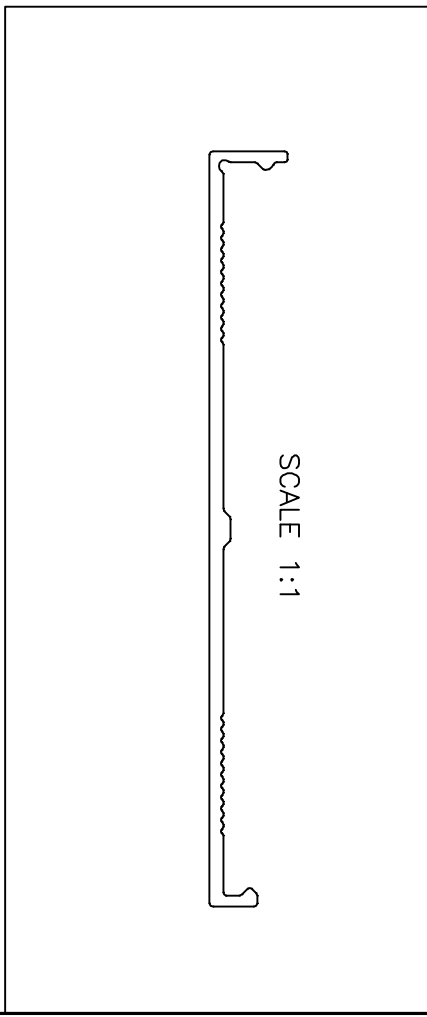
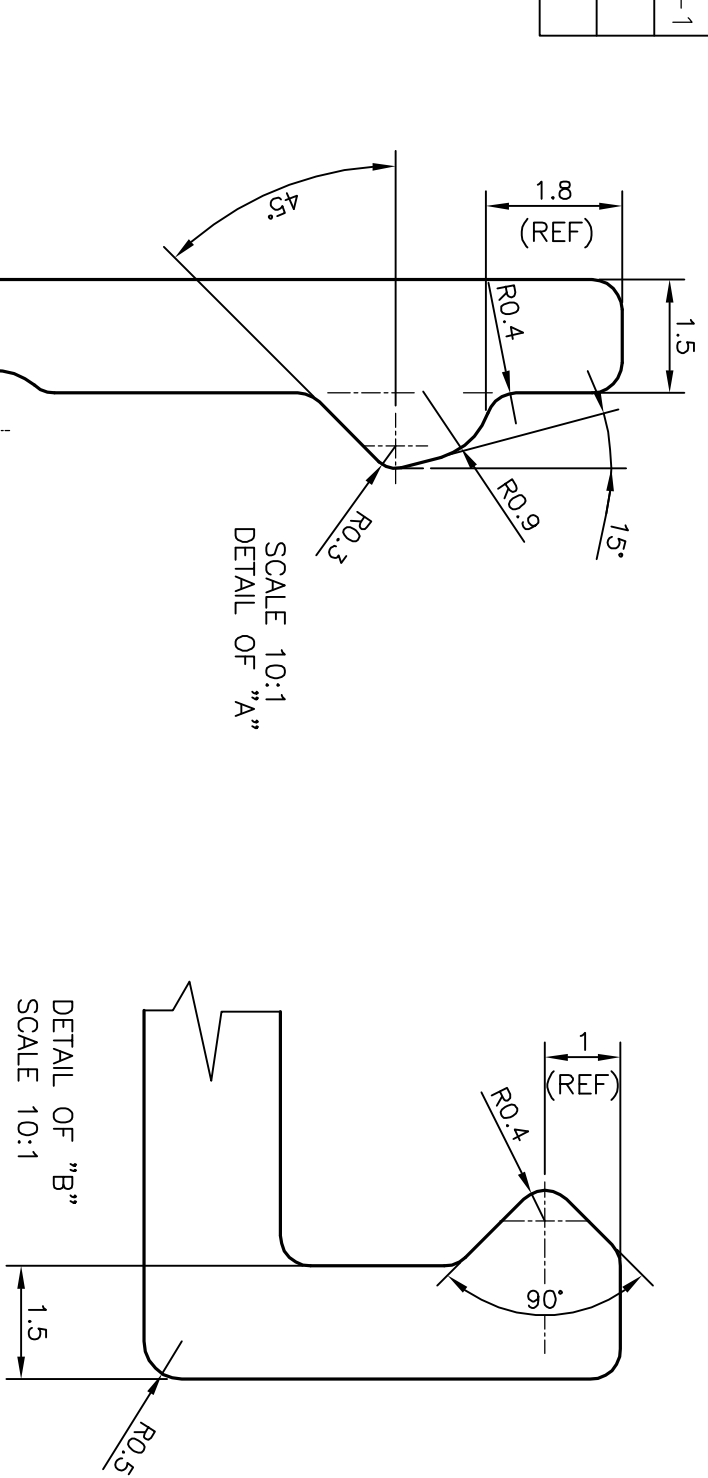

TOLERANCES ON OVERALL WIDTHS & WIDTHS ACROSS FLATS OF BARS, & REGULAR SECTIONS

UPTO 6.40mm - ±0.20	UPTO 32.0mm - ±0.38	UPTO 120.0mm - ±0.85
UPTO 10.0mm - ±0.23	UPTO 50.0mm - ±0.46	UPTO 160.0mm - ±1.02
UPTO 12.0mm - ±0.25	UPTO 60.0mm - ±0.53	UPTO 200.0mm - ±1.14
UPTO 16.0mm - ±0.28	UPTO 80.0mm - ±0.69	UPTO 250.0mm - ±1.40
UPTO 25.0mm - ±0.30	UPTO 100.0mm - ±0.75	UPTO 300.0mm - ±1.65

<p>SYMBOL OF QUALITY AN ISO 9001 COMPANY</p>	<p>JINDAL ALUMINIUM LTD. BANGALORE-560073 (INDIA)</p>	DRAWN	J.P.KAUSHIK	11-11-2017
		CHECKED		
<p>1. ALL DIMENSIONS ARE IN mm. 2. ROUND OFF ALL SHARP CORNERS WITH 0.40 mm. 3. TOLERANCES WILL BE AS PER IS:3965-1981, UNLESS OTHERWISE SPECIFIED</p>		APPROVED	B.NATARAJA	15-11-2017
PARTY'S NAME	ALUFIT (INDIA) PRIVATE LIMITED, BANGALORE	SCALE	3:1	
PARTY'S DRAWING No.	AS PER AUTOCAD DRAWING-ES-08	AREA mm ²	201.611	
ALLOY & TEMPER	6063 T6	PERIMETER mm.	235.826	
DESCRIPTION	DECORATIVE CAPPING TOP	WEIGHT kg/m	0.544	
		DRAWING No.	P-17631-1	SECTION No.
			E0765	E0765

