

DETAIL OF "B"
SCALE 2:1

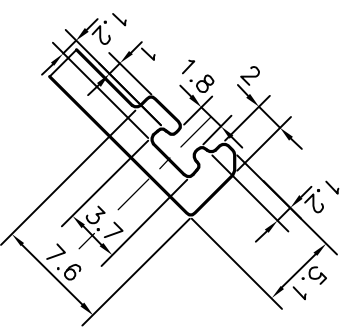

DETAIL OF "C"
SCALE 2:1

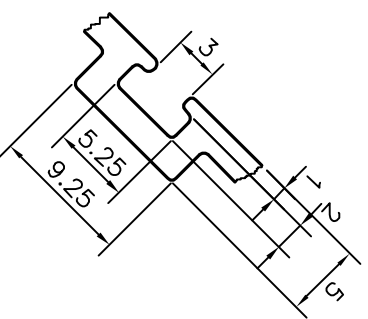

DETAIL OF "D"
SCALE 2:1

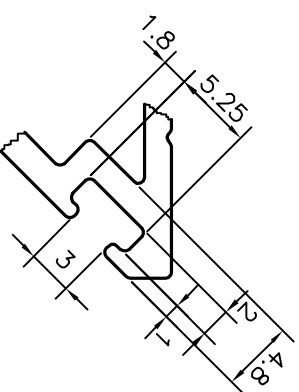

Z = RADIUS 1 mm. (5 PLACES)
V = VEE GROOVE 0.3x90° (4 PLACES)

TOLERANCES ON OVERALL WIDTHS & WIDTHS ACROSS FLATS OF BARS, & REGULAR SECTIONS			
UPTO 6.40mm - ±0.20	UPTO 32.0mm - ±0.38	UPTO 120.0mm - ±0.85	1. STRAIGHTNESS=1.7mm/M
UPTO 10.0mm - ±0.23	UPTO 50.0mm - ±0.46	UPTO 160.0mm - ±1.02	2. TWIST=1.7mm/M
UPTO 12.0mm - ±0.25	UPTO 60.0mm - ±0.53	UPTO 200.0mm - ±1.14	3. ANGULARITY= ±2°
UPTO 16.0mm - ±0.28	UPTO 80.0mm - ±0.69	UPTO 250.0mm - ±1.40	4. FLATNESS =0.007xWIDTH
UPTO 25.0mm - ±0.30	UPTO 100.0mm - ±0.75	UPTO 300.0mm - ±1.65	

<p>SYMBOL OF QUALITY AN ISO 9001 COMPANY</p>		<p>JINDAL ALUMINIUM LTD. BANGALORE-560073 (INDIA)</p>	
<p>1. ALL DIMENSIONS ARE IN mm. 2. ROUND OFF ALL SHARP CORNERS WITH 0.40 mm. 3. TOLERANCES WILL BE AS PER IS:6477-1983, UNLESS OTHERWISE SPECIFIED</p>		<p>SCALE 1:1</p>	
<p>PARTY'S NAME ALUFIT (INDIA) PRIVATE LIMITED, BANGALORE</p>		<p>AREA mm² 1770.246</p>	
<p>PARTY'S DRAWING No. PROFILE-T1/T2-23</p>		<p>PERIMETER mm. 973.125</p>	
<p>ALLOY & TEMPER 6063 T6</p>		<p>WEIGHT kg/m 4.780</p>	
<p>DESCRIPTION EX-CORNER FEMALE MULLION SECTION</p>		<p>DRAWING No. SECTION No.</p>	
		<p>DRAWN NAME J.P.KAUSHIK</p>	
		<p>CHECKED B.NATARAJA</p>	
		<p>DATE 30-08-2018</p>	
		<p>APPROVED B.NATARAJA</p>	
		<p>SCALE 1:1</p>	
		<p>AREA mm² 1770.246</p>	
		<p>PERIMETER mm. 973.125</p>	
		<p>WEIGHT kg/m 4.780</p>	
		<p>DRAWING No. SECTION No.</p>	
		<p>DRAWN NAME J.P.KAUSHIK</p>	
		<p>CHECKED B.NATARAJA</p>	
		<p>DATE 30-08-2018</p>	
		<p>APPROVED B.NATARAJA</p>	
		<p>SCALE 1:1</p>	
		<p>AREA mm² 1770.246</p>	
		<p>PERIMETER mm. 973.125</p>	
		<p>WEIGHT kg/m 4.780</p>	
		<p>DRAWING No. SECTION No.</p>	

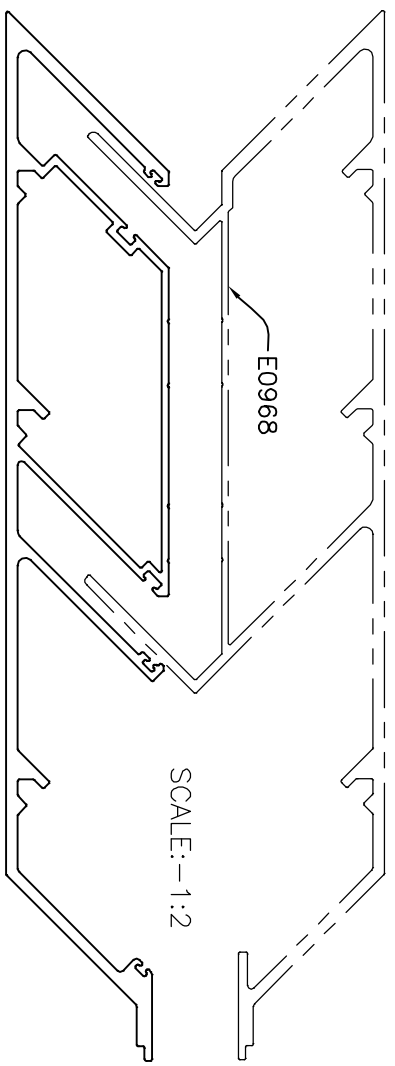

SCALE:-1:2