

P-JAL-B-908-1

E103584

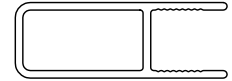

SCALE 1:1

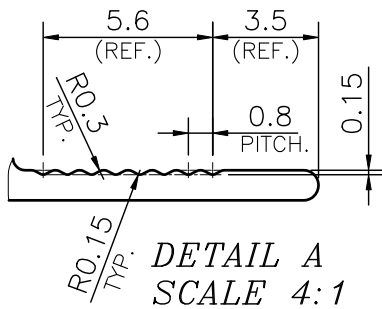
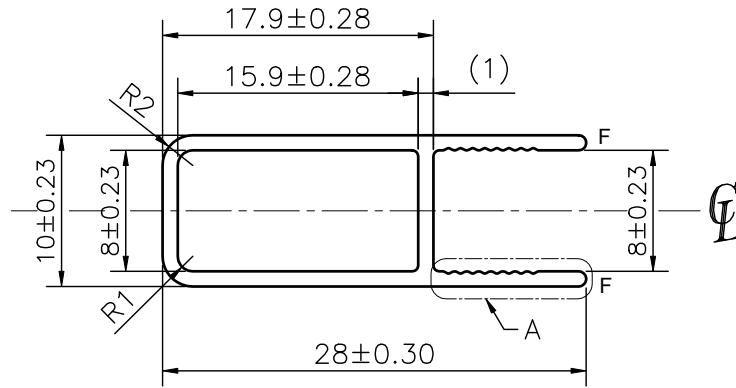

COLOR/FINISH - ANODIZING

NOTE:-

F= FULL RADIUS (2 PLACES)

1. STRAIGHTNESS= 1.7mm/M
2. TWIST= 1.7mm/M
3. ANGULARITY= ±2°
4. FLATNESS= 0.007xWIDTH

Q02864

CONTROLLED COPY



SYMBOL OF QUALITY
AN ISO 9001 COMPANY

JINDAL ALUMINIUM LTD.
BHIWADI-301019 (INDIA)

	NAME	DATE
DRAWN	ASHUTOSH	03-02-2025
CHECKED	PARVESH	20-02-2025
APPROVED	J.N.RAI	20-02-2025

1. ALL DIMENSIONS ARE IN mm.
2. ROUND OFF ALL SHARP CORNERS WITH 0.40 mm.
3. TOLERANCES WILL BE AS PER BS:EN-755-9 , UNLESS OTHERWISE SPECIFIED

SCALE	2:1
AREA mm ²	69.753
PERIMETER mm.	94.314
WEIGHT kg/m	0.188
DRAWING No.	SECTION No.
P-JAL-B-908-1	7000003809
E103584	E103584

PARTY'S NAME	JAQUAR AND COMPANY PVT. LTD., BHIWADI	
PARTY'S DRAWING No.	AS PER DRAWING JQE & SAMPLE-200I	
ALLOY & TEMPER	6063 T6	PRODUCT CODE:-050
		HSN CODE:- 76042100
DESCRIPTION	KITCHEN CABINET SECTION (ENNA FIX PROFILE FREE SIDE)	