

P-20011

E1161

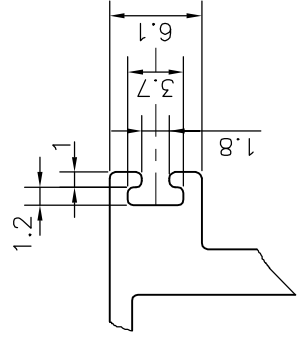

DETAIL OF "A"
SCALE 2:1

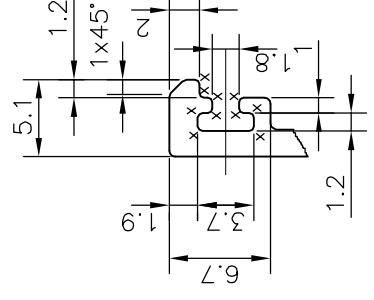

DETAIL OF "C"
SCALE 2:1

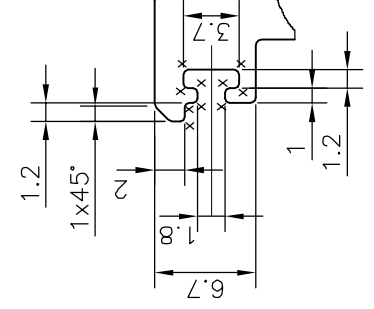

DETAIL OF "B"
SCALE 2:1

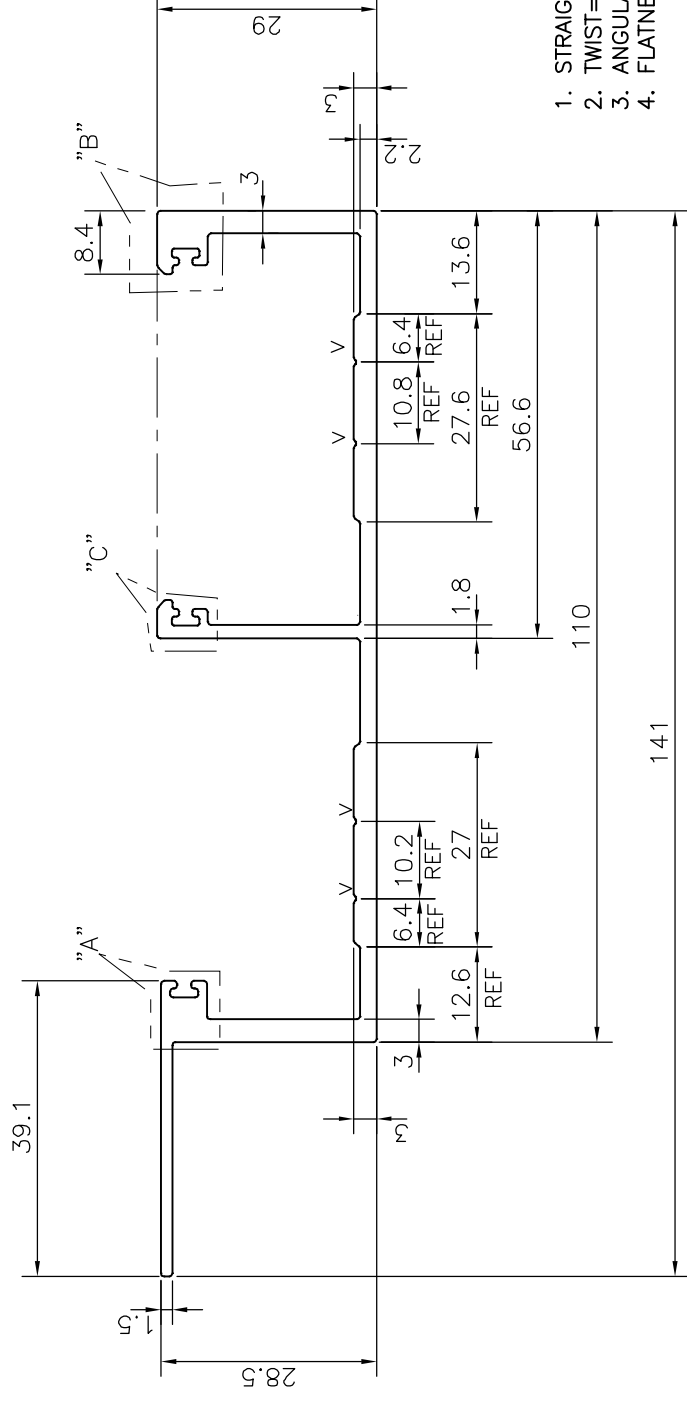

1. STRAIGHTNESS=1.0mm/M
2. TWIST=1.0mm/M
3. ANGULARITY= ±1°
4. FLATNESS =0.007xWIDTH

X = RADIUS 0.3 mm. (20 PLACES)
 V = V GROOVE 0.3x90°(4 PLACES)

EXPOSED SURFACE

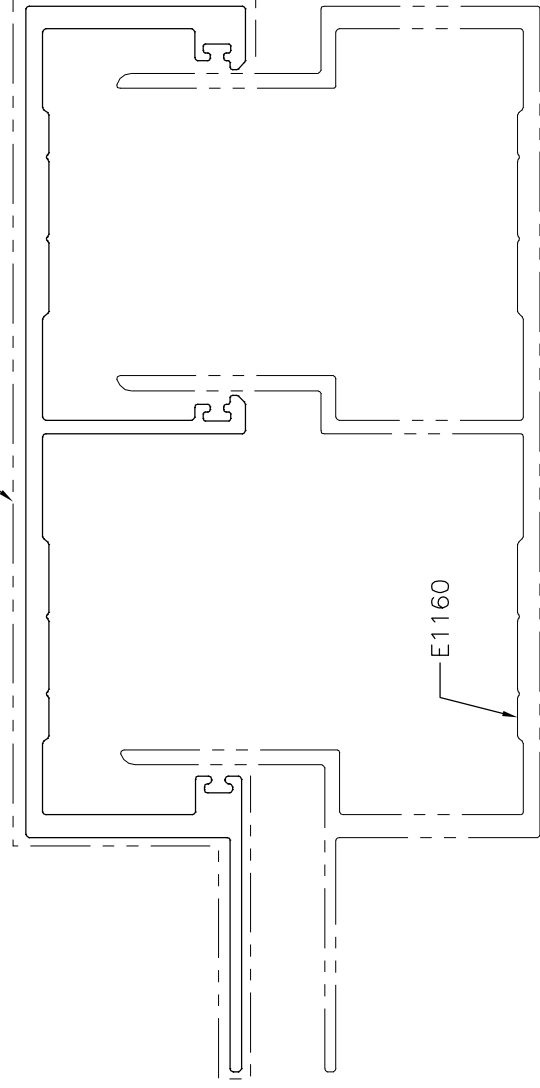

TOLERANCES ON OVERALL WIDTHS & WIDTHS ACROSS FLATS OF BARS, & REGULAR SECTIONS

UPTO 6.40mm - ±0.20	UPTO 32.0mm - ±0.38	UPTO 120.0mm - ±0.85	UPTO 320.00mm - ±1.70
UPTO 10.0mm - ±0.23	UPTO 50.0mm - ±0.46	UPTO 160.0mm - ±1.02	
UPTO 12.0mm - ±0.25	UPTO 60.0mm - ±0.53	UPTO 200.0mm - ±1.14	
UPTO 16.0mm - ±0.28	UPTO 80.0mm - ±0.69	UPTO 250.0mm - ±1.40	
UPTO 25.0mm - ±0.30	UPTO 100.0mm - ±0.75	UPTO 300.0mm - ±1.65	



SYMBOL OF QUALITY
 AN ISO 9001 COMPANY

JINDAL ALUMINIUM LTD.
 BANGALORE-560073 (INDIA)

1. ALL DIMENSIONS ARE IN mm.
 2. ROUND OFF ALL SHARP CORNERS WITH 0.40 mm.
 3. TOLERANCES WILL BE AS PER IS:3965-1981 UNLESS OTHERWISE SPECIFIED

PARTY'S NAME	ALUFIT (INDIA) PVT. LTD., BANGALORE	WEIGHT kg/m	1.610
PARTY'S DRAWING No.	OP-DIE-11	DRAWING No.	SECTION No.
ALLOY & TEMPER	6063 T6		
DESCRIPTION	CURTAIN WALL SECTION-FEMALE MULLION		

DRAWN	J.P.KAUSHIK	NAME		DATE	16-08-2019
CHECKED					
APPROVED	B.NATARAJA				06-09-2019
SCALE	1:1				
AREA	mm ²				596.385
PERIMETER	mm.				492.228