

P-19965

E1212

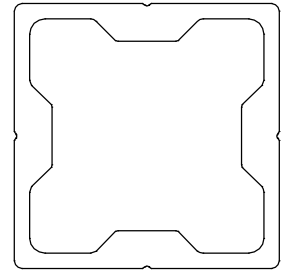

1:1

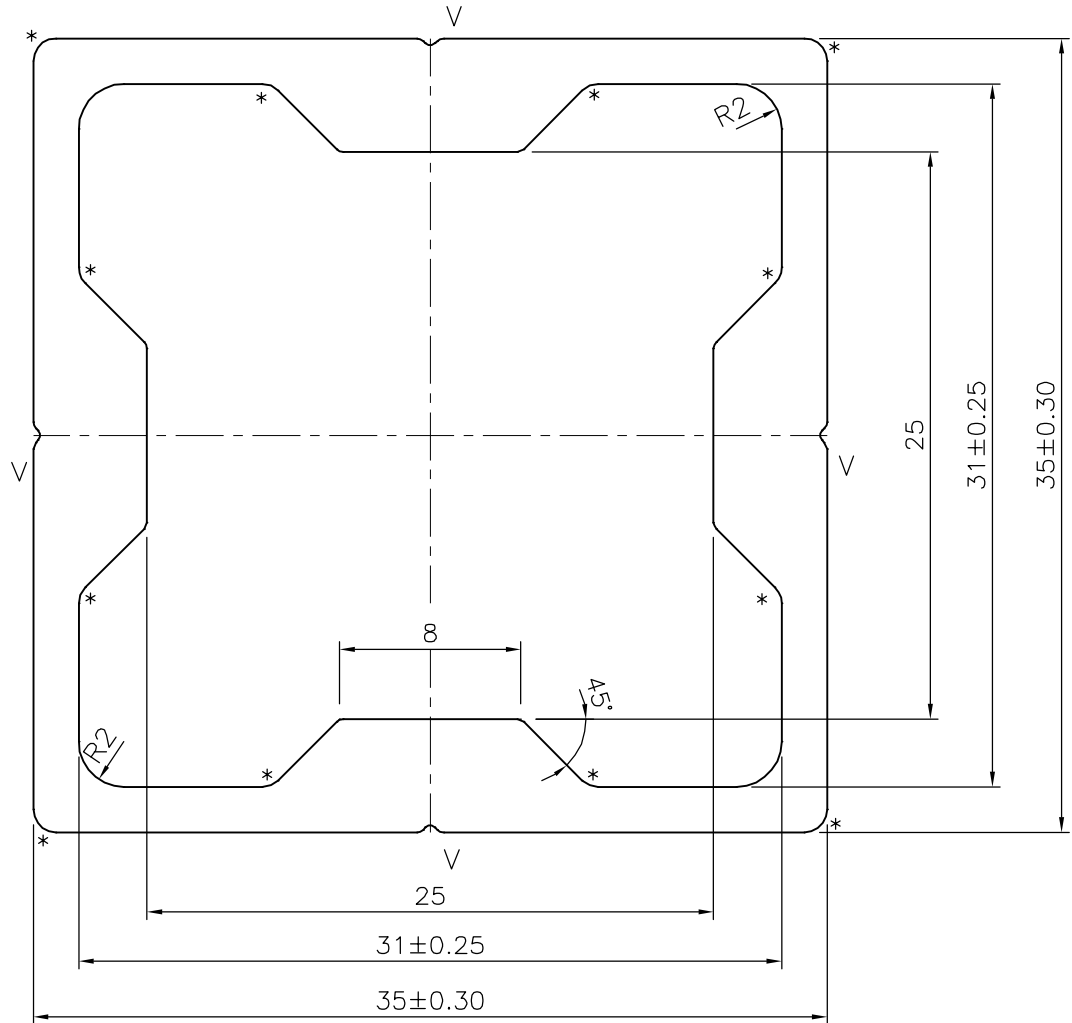

*= 1.0 RADIUS (12 PLACES)
 V= V GROOVE 0.3x90° (4 PLACES)



SYMBOL OF QUALITY
 AN ISO 9001 COMPANY

JINDAL ALUMINIUM LTD.
 BANGALORE-560073 (INDIA)

	NAME	DATE
DRAWN	J.P.KAUSHIK	08-08-2019
CHECKED		
APPROVED	B.NATARAJA	07-11-2019

1. ALL DIMENSIONS ARE IN mm.
2. ROUND OFF ALL SHARP CORNERS WITH 0.40 mm.
3. TOLERANCES WILL BE AS PER IS:6477-1983 , UNLESS OTHERWISE SPECIFIED

SCALE	3:1
AREA mm ²	398.05
PERIMETER mm.	139.036
WEIGHT kg/m	1.075

PARTY'S NAME	WIPRO ENTERPRISES PVT. LTD., BANGALORE
PARTY'S DRAWING No.	YPL D 0003
ALLOY & TEMPER	6005 T6
DESCRIPTION	STRAIGHT LEG_ LEG 35x35 SECTION

DRAWING No.	SECTION No.
P-19965	-
E1212	E1212