

P-19986

E1221

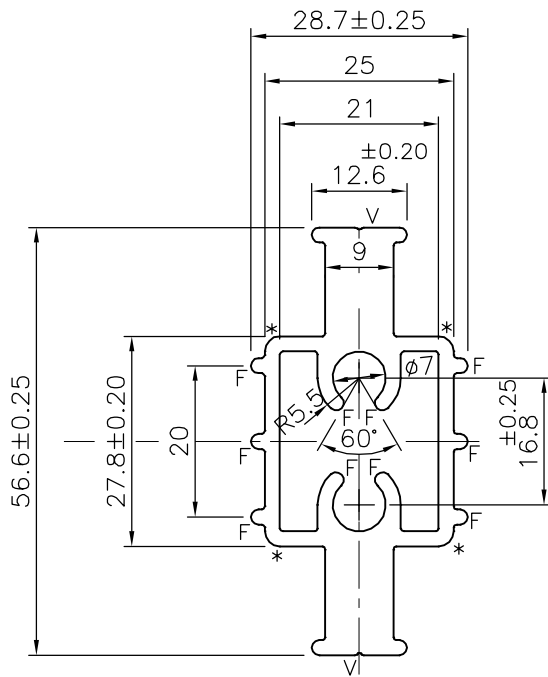

E1220

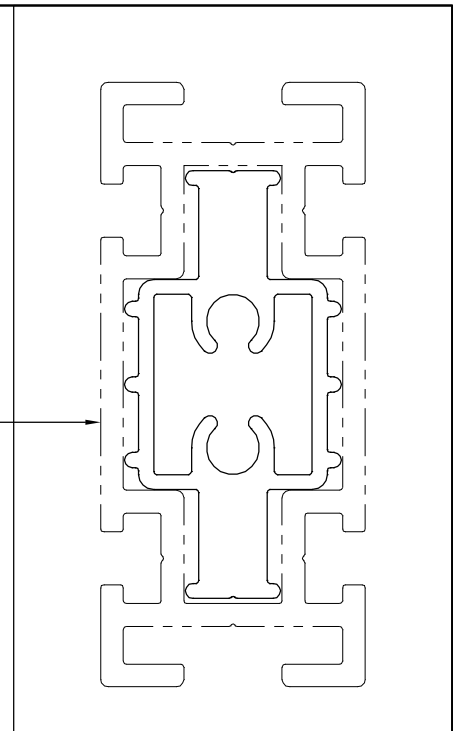

F= FULL RADIUS (10 PLACES)
 *= RADIUS 2.0 (4 PLACES)
 V= V GROOVE 0.3x90° (2 PLACES)



SYMBOL OF QUALITY
 AN ISO 9001 COMPANY

JINDAL ALUMINIUM LTD.
 BANGALORE-560073 (INDIA)

	NAME	DATE
DRAWN	J.P.KAUSHIK	11-08-2019
CHECKED		
APPROVED	B.NATARAJA	08-11-2019
SCALE		1:1
AREA	mm ²	558.331
PERIMETER	mm.	184.725
WEIGHT	kg/m	1.507
DRAWING No.	SECTION No.	
P-19986	-	
E1221	E1221	

1. ALL DIMENSIONS ARE IN mm.
2. ROUND OFF ALL SHARP CORNERS WITH 0.40 mm.
3. TOLERANCES WILL BE AS PER IS:6477-1983 , UNLESS OTHERWISE SPECIFIED

PARTY'S NAME	WIPRO ENTERPRISES PVT. LTD., BANGALORE
PARTY'S DRAWING No.	YPL D 0005
ALLOY & TEMPER	6005 T6
DESCRIPTION	INLINE CONNECTOR SECTION